

SIGNATURE

NORTH EAST

OFFICIALLY RATED THE NO.1 ESTATE AGENT IN THE NORTH EAST





📍 Hotspur North, Newcastle Upon Tyne NE27 0GN

Hotspur North, Newcastle Upon Tyne NE27 0GN

Offers Over £430,000

Signature North East welcomes you to this charming detached house located in the sought-after area of Hotspur North, Backworth, Newcastle Upon Tyne. Situated in a vibrant neighbourhood, you'll have easy access to local amenities, schools, and parks, making it an ideal location for families. The coastal town of Whitley Bay, with its sandy beaches and promenade, is just 6 miles away, while Newcastle is easily accessible via the close network of roads.

As you step into this property, the ample hallway leads you to the inviting living room where a box bay window allows natural light to flood the space. The living room connects seamlessly to the kitchen/dining room, which can also be accessed via the hallway. The kitchen offers a plethora of wall and base units for storage and meal prep and includes a dishwasher and fridge freezer. The peninsula is ideal for casual meals or quick breakfasts, while the dining room provides an ideal area for formal dining or social gatherings. From here, you can access the orangery, an additional room with bifold doors that blend the outdoors with the indoors. For extra cosy nights, the wood burner serves as a central feature.

On the first floor, you will find four well-appointed double bedrooms. The master bedroom offers a 3-piece en-suite with a walk-in shower. Bedrooms 2 and 3 share a 3-piece Jack & Jill en-suite with a walk-in shower. Bedroom 4 currently serves as an office. Completing the first floor, the family bathroom offers a relaxing bathtub. The loft has been fully boarded, and a pull-out ladder provides convenient access.

Outside, this property features an easy-maintenance back garden with two patio areas, a green area, and raised beds with flowers. The fully powered summer house adds to the charm. The property includes a single garage for additional parking or secure storage, and the double drive provides extra parking space for family and guests.

This property features solar panels on the roof, enhancing energy efficiency and reducing utility costs, making this a great property to live in and adding to the value of owning it. Don't miss the opportunity to make this house your home. Book a viewing today and explore the endless possibilities that await you in this lovely Hotspur North property.



PLEASE NOTE THAT THE VENDOR HAS CERTIFIED THE PROPERTY INFORMATION AND IMAGES.

PROPERTY FLOORPLAN

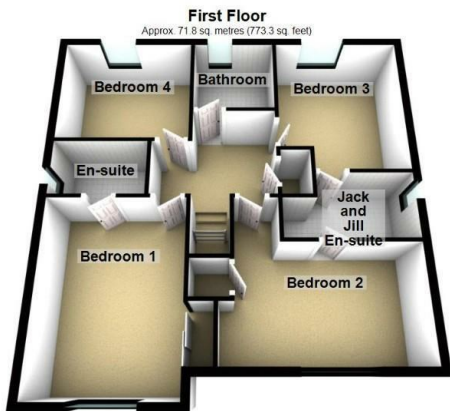
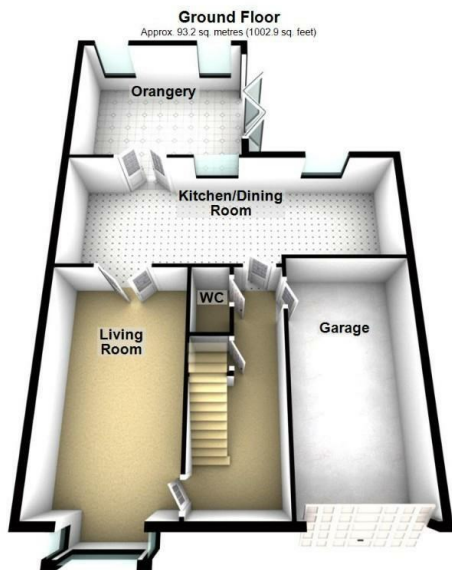

Total area: approx. 165.0 sq. metres (1776.2 sq. feet)

Please be advised the floorplans are not drawn to scale and are to be used to give an idea of the layout of the property.
Plan produced using PlanUp.

Measurements:

- Living Room
18'3" x 10'7"
- Kitchen / Dining Room
28'1" x 9'11"
- Conservatory
14'11" x 12'4"
- WC
5'3" x 3'0"
- Bedroom One
14'6" x 10'9"
- En Suite
7'5" x 4'7"
- Bedroom Two
15'0" x 12'3"
- Jack and Jill En Suite
10'2" x 5'3"
- Bedroom Three
11'9" x 10'2"
- Bedroom Four
10'6" x 9'0"
- Bathroom
6'5" x 6'3"

Energy Efficiency Rating		
	Current	Potential
Very energy efficient - lower running costs		
(92 plus) A		92
(81-91) B	83	
(69-80) C		
(55-68) D		
(39-54) E		
(21-38) F		
(1-20) G		
Not energy efficient - higher running costs		
England & Wales		EU Directive 2002/91/EC 





More 5 Star Customer Reviews than any other Agent based in the North East on allAgents.co.uk



SALES

LETTINGS

FINANCE

LAW

WE COVER THE WHOLE OF THE NORTH EAST

Whitley Bay
0191 251 3344

Cramlington
01670 897 213

Tynemouth
0191 296 6689

Morpeth
01670 513 966

Ponteland
01661 820 082

Wallsend
0191 432 4151

Alnwick
01665 511 800

Heaton
0191 432 4275

Forest Hall
0191 266 9966

Other locations
0191 640 3523

Newcastle
0191 640 2284

Durham
0191 303 8252

Gosforth
0191 640 3523

Sunderland
0191 543 6390

Whickham
0191 432 5102

Gateshead
0191 432 4294

Jesmond
0191 281 1037

Killingworth
0191 640 3602

Ryton
0191 413 9845

Head Office &
Lettings
0191 253 4815

*Highest recommended 5-star reviews than any other Estate Agent based in the North East on allAgents.co.uk - The UK's Largest Customer Review Website for the Property Industry & Awarded Best Estate Agency 2018 & 2019 - North East England by SME News