

# SIGNATURE

## NORTH EAST

OFFICIALLY RATED THE NO.1 ESTATE AGENT IN THE NORTH EAST







📍 The Covers, Morpeth NE61 2RU



# The Covers, Morpeth NE61 2RU

**Asking Price**  
**£380,000**

Signature North East welcomes you to this four-bedroom detached home, ideally located in the sought-after town of Morpeth. The property enjoys a convenient location close to a wide range of everyday amenities, including popular shops, cafés and eateries, alongside well-loved green spaces. Morpeth train station is within easy reach, offering excellent transport links across the region for commuters and leisure travel alike. The property is heated, and hot water is provided by an efficient, modern air source heat pump system, installed in April 2025 to standards exceeding current requirements and offering convenient web-based control.

Step through the hallway into the spacious living room, which is enhanced by a bay window that fills the room with natural light, creating a peaceful setting. The dining area provides a dedicated space for family meals and flows into the kitchen, which is fitted with attractive wall and base units, sleek worktops and integrated appliances including a dual oven, hob and dishwasher. French doors from the dining area lead into a bright conservatory, which provides additional living space and enjoys views over the rear garden. A utility room and ground-floor WC complete the layout.

The first floor offers four well-proportioned double bedrooms, creating a practical layout for a range of needs. The principal bedroom benefits from built-in storage and a private en suite, while bedroom two also features built-in storage. Completing this level is the family bathroom, fitted with a bathtub, overhead shower, wash basin and WC.

Externally, the property features a well-sized rear garden, laid mainly to lawn with a patio area ideal for outdoor dining and entertaining. Off-street parking is available via the double driveway and garage, adding further convenience to this appealing Morpeth home.



PLEASE NOTE THAT THE VENDOR HAS CERTIFIED THE PROPERTY INFORMATION AND IMAGES.

# PROPERTY FLOORPLAN

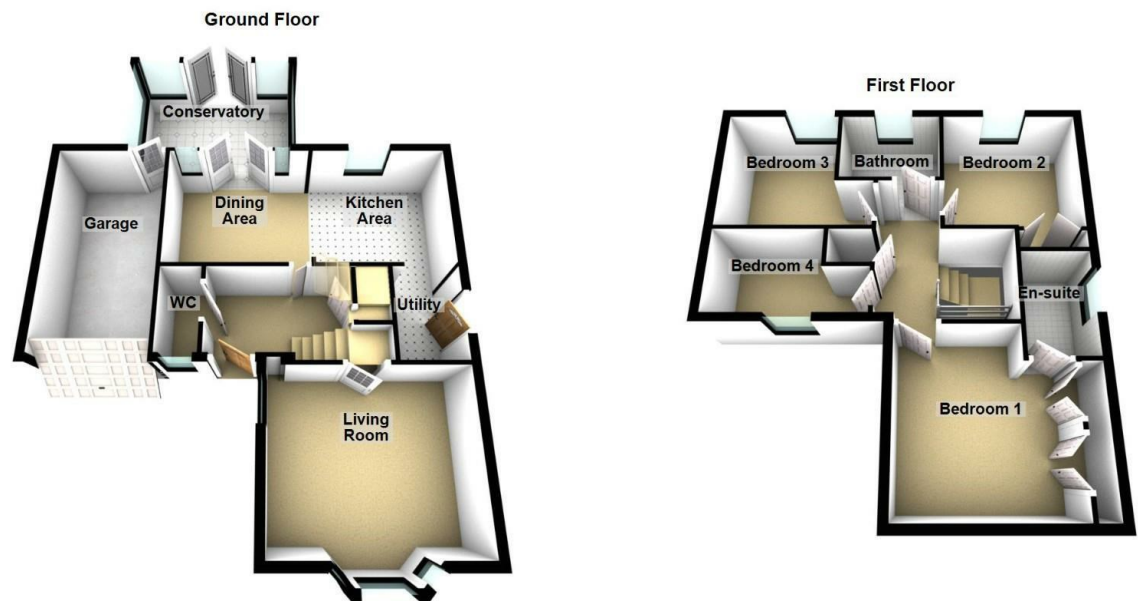

Total area: approx. 127.1 sq. metres (1368.5 sq. feet)

## Measurements:

Living Room  
11'7" x 13'10"

Kitchen  
9'6" x 10'0"

Dining Room  
9'6" x 10'8"

Conservatory  
8'5" x 12'6"

Utility  
6'10" x 3'8"

W.C  
6'3" x 2'11"

Bedroom One  
11'11" x 21'9"

En-Suite  
9'5" x 4'9"

Bedroom Two  
8'10" x 10'2"

Bedroom Three  
9'4" x 8'4"

Bedroom Four  
6'9" x 11'4"

Bathroom  
5'5" x 6'10"

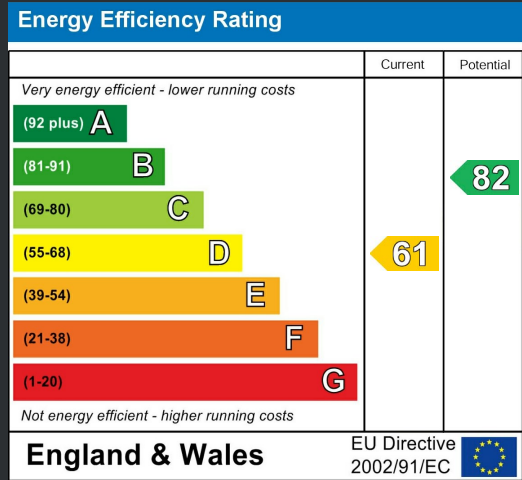









More 5 Star Customer Reviews than any other Agent based in the North East on [allAgents.co.uk](https://allAgents.co.uk)



**SALES**

**LETTINGS**

**FINANCE**

**LAW**

**WE COVER THE WHOLE OF THE NORTH EAST**

Whitley Bay  
0191 251 3344

Cramlington  
01670 897 213

Tynemouth  
0191 296 6689

Morpeth  
01670 513 966

Ponteland  
01661 820 082

Wallsend  
0191 432 4151

Alnwick  
01665 511 800

Heaton  
0191 432 4275

Forest Hall  
0191 266 9966

Other locations  
0191 640 3523

Newcastle  
0191 640 2284

Durham  
0191 303 8252

Gosforth  
0191 640 3523

Sunderland  
0191 543 6390

Whickham  
0191 432 5102

Gateshead  
0191 432 4294

Jesmond  
0191 281 1037

Killingworth  
0191 640 3602

Ryton  
0191 413 9845

Head Office &  
Lettings  
0191 253 4815

\*Highest recommended 5-star reviews than any other Estate Agent based in the North East on [allAgents.co.uk](https://allAgents.co.uk) - The UK's Largest Customer Review Website for the Property Industry & Awarded Best Estate Agency 2018 & 2019 - North East England by SME News