

# SIGNATURE

## NORTH EAST

OFFICIALLY RATED THE NO.1 ESTATE AGENT IN THE NORTH EAST







📍 Humford Way, Bedlington NE22 5ET



# Humford Way, Bedlington NE22 5ET

**Asking Price**  
**£365,000**

Signature North East welcomes you to this charming three-bedroom bungalow in Bedlington, quietly positioned within a peaceful cul-de-sac and enjoying a superb sense of privacy, with no neighbouring homes overlooking the property. Local amenities and green spaces are close at hand, with Bedlington Railway Station and the stunning Blyth beach only a short distance away by car.

Step through the entrance hallway into the inviting living room, offering ample space for furnishings, a cosy fireplace, and a large window that floods the room with natural light. The well-sized kitchen, installed in 2022, provides attractive wall and base units, quality countertops, and integrated appliances including an oven and hob. There is comfortable space for a dining set, and access to the rear garden is available directly from the kitchen.

Continuing through the home, you'll find three bedrooms, two of which are generous doubles. All bedrooms are equipped with fitted wardrobes, with bedroom one further benefiting from an en suite featuring a walk-in shower. A family bathroom, complete with a bathtub, wash basin, and WC, provides additional convenience and completes this home.

Externally, the property sits on a large plot with established front and rear gardens, offering mature lawns, well-tended hedges, and attractive patio and stone areas. Off-street parking is provided via a garage and driveway, ensuring practicality alongside the home's appealing setting.



PLEASE NOTE THAT THE VENDOR HAS CERTIFIED THE PROPERTY INFORMATION AND IMAGES.

# PROPERTY FLOORPLAN

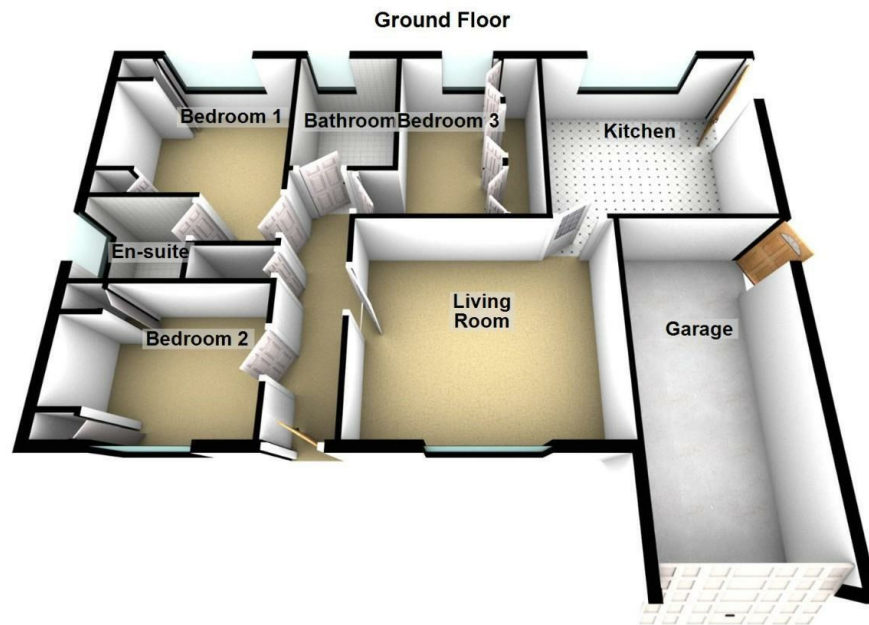

Total area: approx. 94.7 sq. metres (1019.6 sq. feet)

## Measurements:

Living Room  
12'8"

Kitchen  
11'2" x 13'0"

Bedroom One  
13'0" x 8'10"

En Suite  
5'1" x 6'2"

Bedroom Two  
8'5" x 11'1"

Bedroom Three  
11'3" x 8'7"

Bathroom  
8'0" x 6'1"

Garage  
19'2" x 8'10"

## Energy Efficiency Rating

	Current	Potential
Very energy efficient - lower running costs		
(92 plus) <b>A</b>		
(81-91) <b>B</b>		
(69-80) <b>C</b>		
(55-68) <b>D</b>		
(39-54) <b>E</b>		
(21-38) <b>F</b>		
(1-20) <b>G</b>		
Not energy efficient - higher running costs		

74

62

England & Wales

EU Directive  
2002/91/EC











More 5 Star Customer Reviews than any other Agent based in the North East on [allAgents.co.uk](https://allAgents.co.uk)



**SALES**

**LETTINGS**

**FINANCE**

**LAW**

**WE COVER THE WHOLE OF THE NORTH EAST**

Whitley Bay  
0191 251 3344

Cramlington  
01670 897 213

Tynemouth  
0191 296 6689

Morpeth  
01670 513 966

Ponteland  
01661 820 082

Wallsend  
0191 432 4151

Alnwick  
01665 511 800

Heaton  
0191 432 4275

Forest Hall  
0191 266 9966

Other locations  
0191 640 3523

Newcastle  
0191 640 2284

Durham  
0191 303 8252

Gosforth  
0191 640 3523

Sunderland  
0191 543 6390

Whickham  
0191 432 5102

Gateshead  
0191 432 4294

Jesmond  
0191 281 1037

Killingworth  
0191 640 3602

Ryton  
0191 413 9845

Head Office &  
Lettings  
0191 253 4815

\*Highest recommended 5-star reviews than any other Estate Agent based in the North East on [allAgents.co.uk](https://allAgents.co.uk) - The UK's Largest Customer Review Website for the Property Industry & Awarded Best Estate Agency 2018 & 2019 - North East England by SME News