

SIGNATURE

NORTH EAST

OFFICIALLY RATED THE NO.1 ESTATE AGENT IN THE NORTH EAST





📍 Primrose Way, Morpeth NE61 5BR

Primrose Way, Morpeth NE61 5BR

Asking Price
£325,000

Signature North East welcomes you to this modern four-bedroom detached home in Ellington, Morpeth. Finished to a high standard throughout and offered with no onward chain, this beautifully presented property is nestled in a peaceful setting with excellent access to local amenities, highly regarded schools, and the stunning Northumberland coastline. With Cresswell Beach close by and convenient road links to Morpeth and Ashington, it offers the ideal balance of tranquillity and connectivity.

Step through the entrance hall into the spacious living room, offering ample space for furnishings and flooded with natural light from a large front window and bifold doors leading to the rear garden. The contemporary kitchen features attractive wall and base units, sleek worktops, an integrated fridge freezer, and French doors opening to the garden. A generous dining room provides the perfect setting for family meals and entertaining. Completing the ground floor is a useful utility room with access to a WC.

To the first floor, you'll find four well-proportioned bedrooms, three of which are comfortable doubles. The principal bedroom enjoys the added convenience of an en suite shower room. A modern family bathroom serves the remaining rooms, fitted with a bathtub, wash basin, and WC, completing this level.

Externally, the property boasts a well-sized rear garden laid to lawn with a patio area, ideal for outdoor seating and relaxation. Off-street parking is provided for up to three cars, via a garage and a spacious driveway complete with an electric vehicle charging point.



PLEASE NOTE THAT THE VENDOR HAS CERTIFIED THE PROPERTY INFORMATION AND IMAGES.

PROPERTY FLOORPLAN

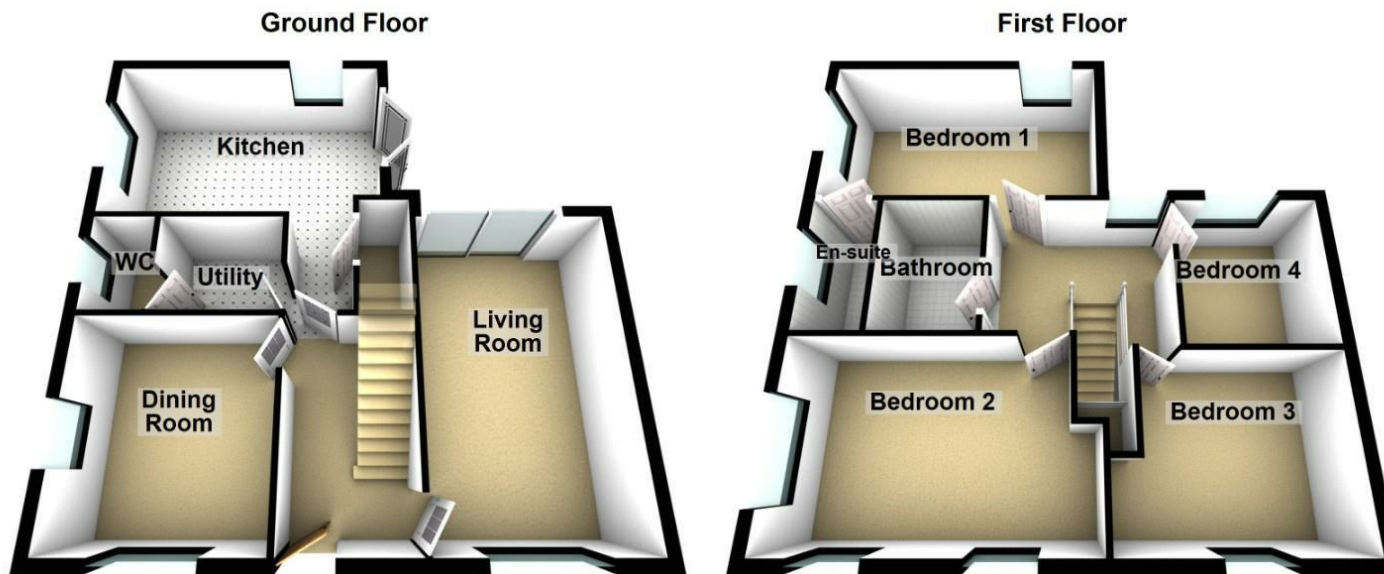

Total area: approx. 117.0 sq. metres (1259.2 sq. feet)

Measurements:

Living Room
16'9" x 10'1"

Kitchen
15'8" x 15'7"

Dining Room
11'1" x 9'10", 45'11"

Utility
5'4" x 6'7"

W.C
5'4" x 3'3"

Bedroom One
8'11" x 15'8"

En-Suite
7'10" x 3'6"

Bedroom Two
10'0" x 15'6"

Bedroom Three
8'5" x 11'8"

Bedroom Four
7'11" x 7'0"

Bathroom
7'11" x 5'6"

Energy Efficiency Rating

	Current	Potential
Very energy efficient - lower running costs		
(92 plus) A		93
(81-91) B	84	
(69-80) C		
(55-68) D		
(39-54) E		
(21-38) F		
(1-20) G		
Not energy efficient - higher running costs		

England & Wales

EU Directive
2002/91/EC







More 5 Star Customer Reviews than any other Agent based in the North East on allAgents.co.uk



SALES

LETTINGS

FINANCE

LAW

WE COVER THE WHOLE OF THE NORTH EAST

Whitley Bay
0191 251 3344

Cramlington
01670 897 213

Tynemouth
0191 296 6689

Morpeth
01670 513 966

Ponteland
01661 820 082

Wallsend
0191 432 4151

Alnwick
01665 511 800

Heaton
0191 432 4275

Forest Hall
0191 266 9966

Other locations
0191 640 3523

Newcastle
0191 640 2284

Durham
0191 303 8252

Gosforth
0191 640 3523

Sunderland
0191 543 6390

Whickham
0191 432 5102

Gateshead
0191 432 4294

Jesmond
0191 281 1037

Killingworth
0191 640 3602

Ryton
0191 413 9845

Head Office &
Lettings
0191 253 4815

*Highest recommended 5-star reviews than any other Estate Agent based in the North East on allAgents.co.uk - The UK's Largest Customer Review Website for the Property Industry & Awarded Best Estate Agency 2018 & 2019 - North East England by SME News