



Clarges Mayfair 1 Ashburton Place,
Mayfair, W1J

£4,000 Per Week,

NAPIER WATT

T: 0207 935 0011
E: enquiries@napierwatt.co.uk
W: napierwatt.co.uk

35 Berkeley Square, Mayfair, London, W1J 5BF







Description

Conveniently located close to the elegant boutiques and lavish salons of Mayfair. This exclusive development is in prime position to enjoy shopping in the capital, London's food and art scenes, as well as the natural surroundings of nearby Royal Parks, Green Park and Hyde Park. This luxurious one bedroom apartment is located in an extraordinary, brand new development in a prestigious part of Mayfair by Green Park. On the side of the development which faces Clarges Street, this apartment offers quiet and clean living. The apartment benefits from on-site state of the art amenities including concierge service, lift access, air cooling system, spa facilities which include treatment rooms, gym, 25 metre swimming pool and hydro-pool, private residents' lounge, cinema room and an allocated parking space.

Westminster Council Tax Band G. EPC Rating B.

Key Features

- GYM
- AIR COOLING SYSTEM
- PASSENGER LIFT
- 24 CONCIERGE
- SWIMMING POOL
- MEETING ROOMS

Terms

Fees & Charges: Tenancies exceeding £100,000 Per annum £480 inc VAT, Tenancies where a company is a tenant £480 Inc VAT.

The Clarges

Approx. Gross Internal Area 990 Sq Ft - 91.97 Sq M

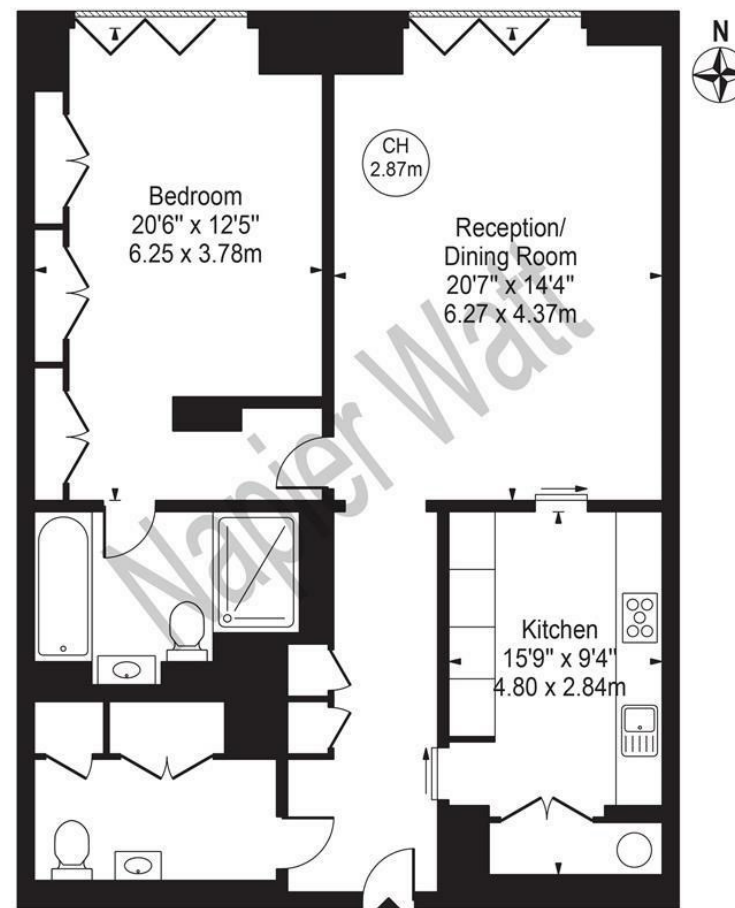

Third Floor

For Illustration Purposes Only - Not To Scale

This floor plan should be used as a general outline for guidance only and does not constitute in whole or in part an offer or contract. Any intending purchaser or lessee should satisfy themselves by inspection, searches, enquiries and full survey as to the correctness of each statement. Any areas, measurements or distances quoted are approximate and should not be used to value a property or be the basis of any sale or let.

IMPORTANT: We would inform prospective purchasers that these sales particulars have been prepared as a general guide only. A detailed survey has not been carried out, nor the services, appliances and fittings tested. Room sizes should not be relied upon for furnishing purposes and are approximate. If floor plans are included, they are for guidance only and illustration purposes only and may not be to scale. If there are any important matters likely to affect your decision to buy, please contact us before viewing the property.