



, 161 Fulham Road,
, SW3

£900 Per Week,

NAPIER WATT

T: 0207 935 0011
E: enquiries@napierwatt.co.uk
W: napierwatt.co.uk

35 Berkeley Square, Mayfair, London, W1J 5BF





Description

Located in the heart of Chelsea, we are pleased to offer this large, two double bedroom (685 sq ft) apartment set in this quiet, modern private ported building with lift. The apartment consists of large reception room and bright modern kitchen with fully integrated appliances, bathroom and guest WC. Large windows running along one side of the reception room give the room a fantastic sense of openness and space. Available furnished or unfurnished.

Key Features

Terms

Additional costs will apply for; referencing (£36 per person & guarantor); administration (£240); renewal/extensions (£120); check-out inventory & cleaning (variable); special requests (variable). Security Deposits also apply to all tenancies.

FLAT 11, 161 FULHAM ROAD, SW3

APPROX. GROSS INTERNAL AREA*
685 Ft² - 63.63 M²

ILLUSTRATION FOR IDENTIFICATION PURPOSES ONLY. NOT TO SCALE

* As Defined by RICS - Code of Measuring Practice

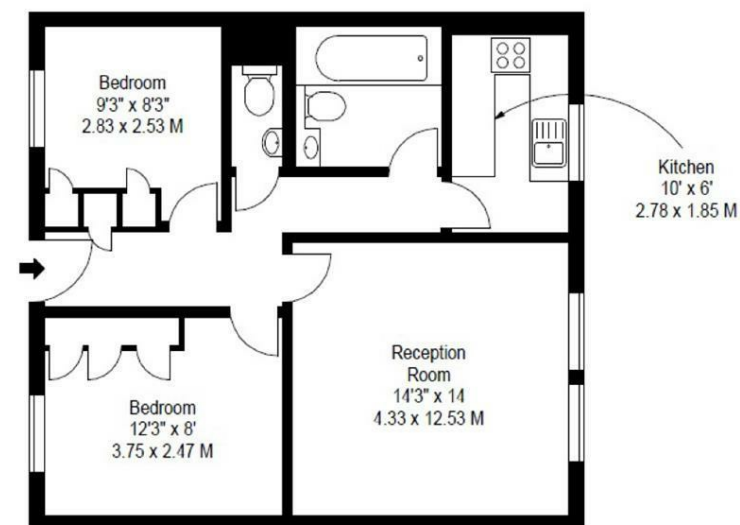

THIRD FLOOR

IMPORTANT: We would inform prospective purchasers that these sales particulars have been prepared as a general guide only. A detailed survey has not been carried out, nor the services, appliances and fittings tested. Room sizes should not be relied upon for furnishing purposes and are approximate. If floor plans are included, they are for guidance only and illustration purposes only and may not be to scale. If there are any important matters likely to affect your decision to buy, please contact us before viewing the property.