



, 10 Weymouth Street,  
Marylebone, W1W

£1,600 Per Week,

NAPIER WATT

T: 0207 935 0011  
E: [enquiries@napierwatt.co.uk](mailto:enquiries@napierwatt.co.uk)  
W: [napierwatt.co.uk](http://napierwatt.co.uk)

35 Berkeley Square, Mayfair, London, W1J 5BF









## Description

A bright and spacious lateral apartment comprising approximately 1,100 sq ft, ideally positioned on the third floor of a well-regarded purpose-built development in the heart of Fitzrovia. This well-proportioned three-bedroom residence offers thoughtfully arranged living accommodation, featuring a generous open-plan reception and kitchen area, three double bedrooms, and two modern bathrooms (one en suite). The interiors are presented in a neutral palette, with soft carpets throughout, creating a refined and welcoming atmosphere. Further benefits include 24-hour portage, an on-site management team, and secure underground parking available by separate negotiation. The property is offered fully furnished and is available for immediate occupation. Fitzrovia is one of Central London's most desirable neighborhood's, celebrated for its vibrant blend of independent boutiques, acclaimed restaurants, and cultural offerings. With excellent transport connectivity nearby, including multiple Underground stations, this apartment represents an exceptional opportunity for those seeking a stylish home in a prime West End location.

Tenure: Leasehold Local Authority: Westminster Council Tax: Band G [subject to confirmation] Service Charge: Available on request EPC Rating: C

## Key Features

- LIFTS
- BALCONY
- GOOD CONDITION
- 24 HOUR PORTERAGE
- AVAILABLE NOVEMBER 2024 - JUNE 2025
- FURNISHED

## Terms

Fees & Charges: Tenancies exceeding £100,000 Per annum £480 inc VAT, Tenancies where a company is a tenant £480 Inc VAT.

## Weymouth Street

Approx. Gross Internal Area  
1193.0 Ft<sup>2</sup> - 110.0 M<sup>2</sup>

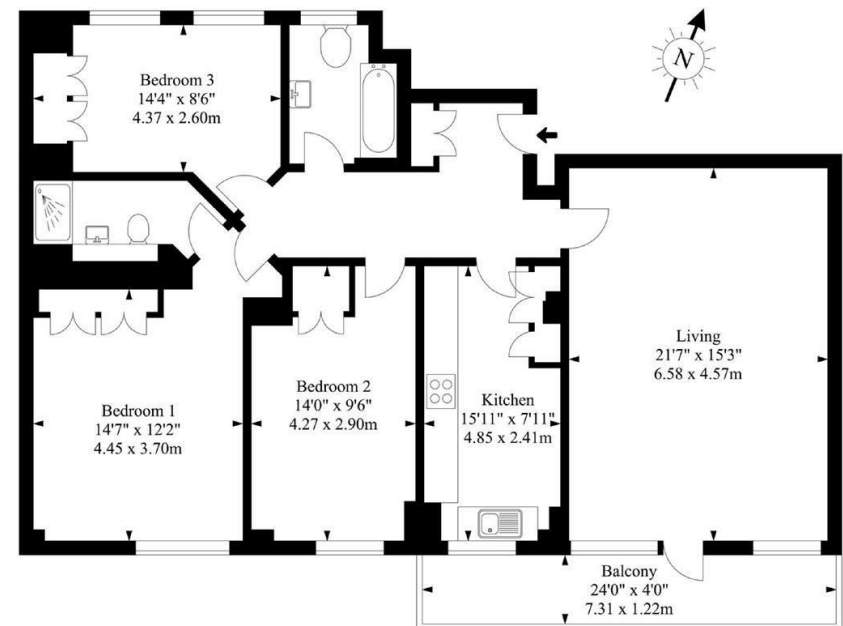

## Second Floor

Illustration For Identification Purposes Only. Not To Scale

IMPORTANT: We would inform prospective purchasers that these sales particulars have been prepared as a general guide only. A detailed survey has not been carried out, nor the services, appliances and fittings tested. Room sizes should not be relied upon for furnishing purposes and are approximate. If floor plans are included, they are for guidance only and illustration purposes only and may not be to scale. If there are any important matters likely to affect your decision to buy, please contact us before viewing the property.