



130, Mount Street,
Mayfair, W1K

£1,550 Per Week,

NAPIER WATT

T: 0207 935 0011
E: enquiries@napierwatt.co.uk
W: napierwatt.co.uk

35 Berkeley Square, Mayfair, London, W1J 5BF







Description

Napier Watt are delighted to be offering this unique one-bedroom property located on corner of the world famous Mount Street and Berkeley Square. The apartment is set over 1,100 square feet, has two bathrooms, a separate kitchen and a large master bedroom. The property also benefits from a mezzanine with great views of Berkeley Square. The property benefits from being located in the heart of Mayfair moments' walk from Bond Street station and Green Park Station. Mayfair is an incredible place to live with the some of the world's finest shops, bars and restaurants. Available, furnished.

1 Bedroom : 2 Bathroom : Mazzanine : EPC Rating E : Westminster Council Tax Band G

Key Features

- GOOD CONDITION
- MOUNT STREET
- MAYFAIR
- LIGHT AND AIRY
- FOURTH FLOOR WITH LIFT
- STUDY
- FURNISHED
- SPACIOUS 1 BED

Terms

Fees & Charges: Tenancies exceeding £100,000 Per annum £480 inc VAT, Tenancies where a company is a tenant £480 Inc VAT.

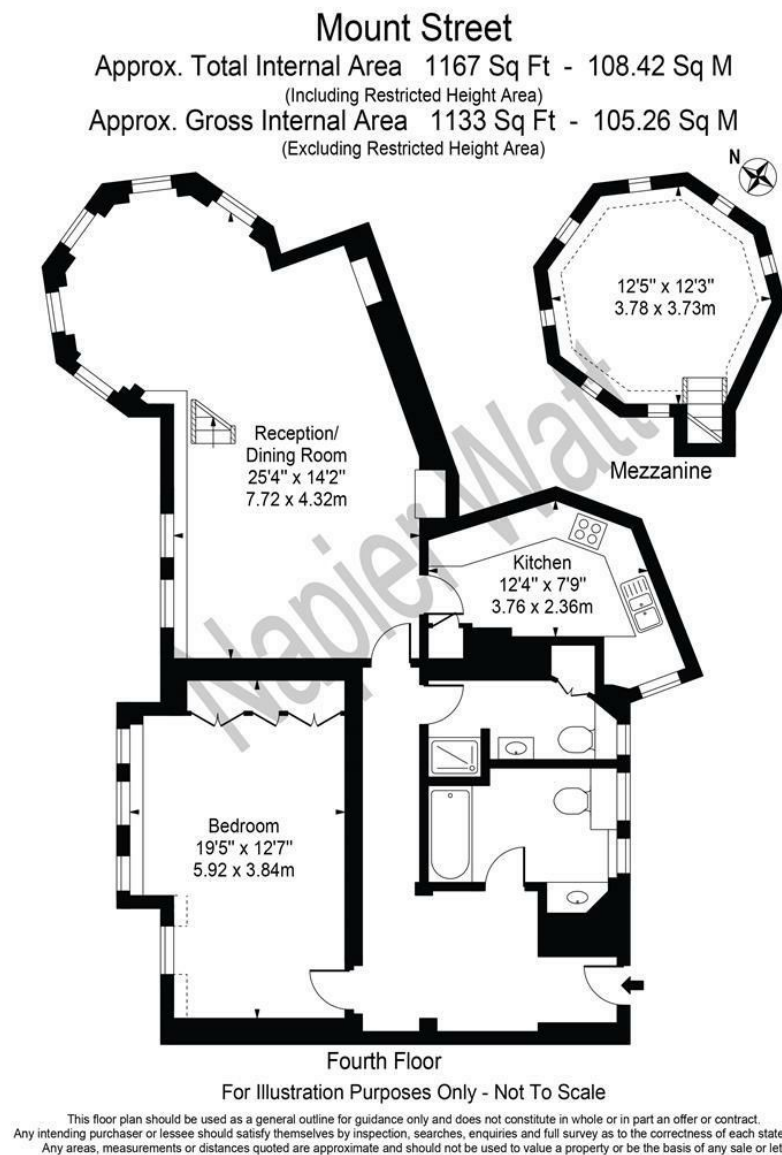

IMPORTANT: We would inform prospective purchasers that these sales particulars have been prepared as a general guide only. A detailed survey has not been carried out, nor the services, appliances and fittings tested. Room sizes should not be relied upon for furnishing purposes and are approximate. If floor plans are included, they are for guidance only and illustration purposes only and may not be to scale. If there are any important matters likely to affect your decision to buy, please contact us before viewing the property.