



Fursecroft, George Street,  
Marylebone, W1H

Asking Price £2,500,000, Leasehold

NAPIER WATT

T: 0207 935 0011  
E: [enquiries@napierwatt.co.uk](mailto:enquiries@napierwatt.co.uk)  
W: [napierwatt.co.uk](http://napierwatt.co.uk)

35 Berkeley Square, Mayfair, London, W1J 5BF











## Description

Joint Sole Agents Napier Watt are pleased to offer for sale this stunning, interior designed three bedroom, three bathroom, eighth floor apartment set within this newly renovated 24 hour portered block.

The property has been fully refurbished to a very high standard and benefits from comfort cooling, all new joinery, wiring and plumbing, and under floor heating to tiled areas.

Fursecroft is a extremely popular purpose built block which has recently undergone extensive redecoration and refurbishment of the communal lobby and hallways. The block also benefits from 24 hour uniformed portorage and lifts.

Entrance : Double Reception Room : Fully Fitted Kitchen : 3 Double Bedrooms : 3 Bathrooms (2 ensuite) : Guest WC : Council Westminster City : Tax Band F. EPC Rating C.

## Key Features

- 24 HOUR PORTER
- AIR CONDITIONING
- LUXURY INTERIOR
- EIGHTH FLOOR WITH LIFT
- BRAND NEW REFURBISHED APARTMENT
- PASSENGER LIFT
- CCTV
- ROOF TOP VIEWS

## Terms

Term : From 24 November 2016 and expiring on 22 March 2123 ie 99 Years.

Service Charge : £6849 per half year including reserve fund

Ground Rent £250 pa

Fursecroft, W1H  
Approx. Gross internal Area 1400 Sq Ft - 130.06 Sq M

Key :  
CH - Ceiling Height

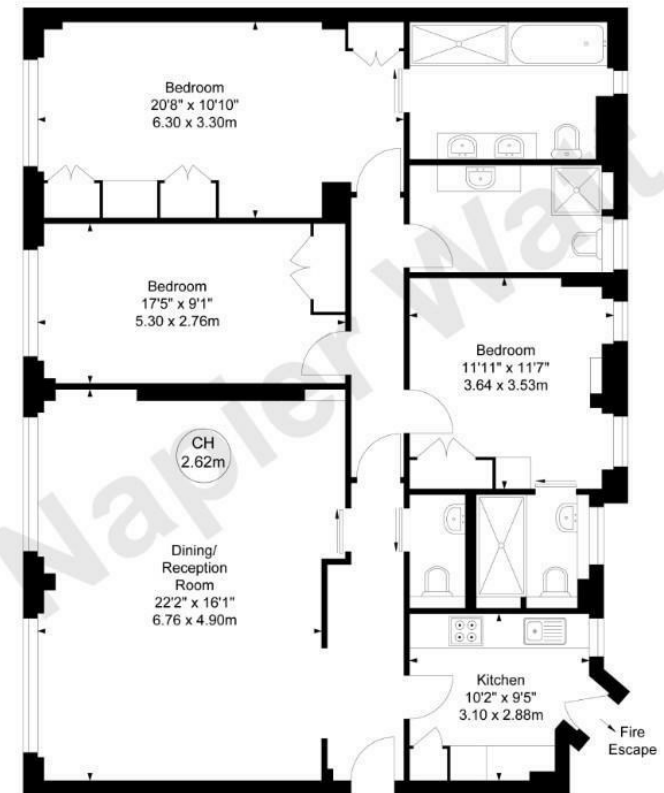

Eighth Floor

Not to scale, for guidance only and must not be relied upon as a statement of fact.  
All measurements and areas are approximate only

IMPORTANT: We would inform prospective purchasers that these sales particulars have been prepared as a general guide only. A detailed survey has not been carried out, nor the services, appliances and fittings tested. Room sizes should not be relied upon for furnishing purposes and are approximate. If floor plans are included, they are for guidance only and illustration purposes only and may not be to scale. If there are any important matters likely to affect your decision to buy, please contact us before viewing the property.