



11-13 Sloane Court West,
Chelsea, SW3

£1,850 Per Week,

NAPIER WATT

T: 0207 935 0011
E: enquiries@napierwatt.co.uk
W: napierwatt.co.uk

35 Berkeley Square, Mayfair, London, W1J 5BF







Description

Beautifully finished two-bedroom apartment in immaculate condition. Set on the first floor (with lift) of this imposing red-brick mansions block, this property boasts high ceilings and an exquisite finish throughout. The property of approximately 1,446sq ft (134sq m) comprises a spacious living room with Juliette balconies overlooking peaceful gardens, separate dining room, kitchen, master en-suite, second double bedroom and a family bathroom. The home benefits from a on-site caretaker and is a short walk from Sloane Square and it's transport links, as well as the shops, bars and amenities of the Kings Road. Available now, furnished.

Two Bedrooms : Two Bathrooms : Lift : Caretaker : Royal Borough of Chelsea & Kensington Tax Band H : EPC Rating C

Key Features

- STUNNING INTERIOR
- PASSENGER LIFT
- GENEROUS PROPORTIONS
- LATERAL TWO-BEDROOM
- CARETAKER
- GREAT CEILING HEIGHT

Terms

Fees & Charges: Tenancies exceeding £100,000 Per annum £480 inc VAT, Tenancies where a company is a tenant £480 Inc VAT.

Sloane Court West, SW3 4TD

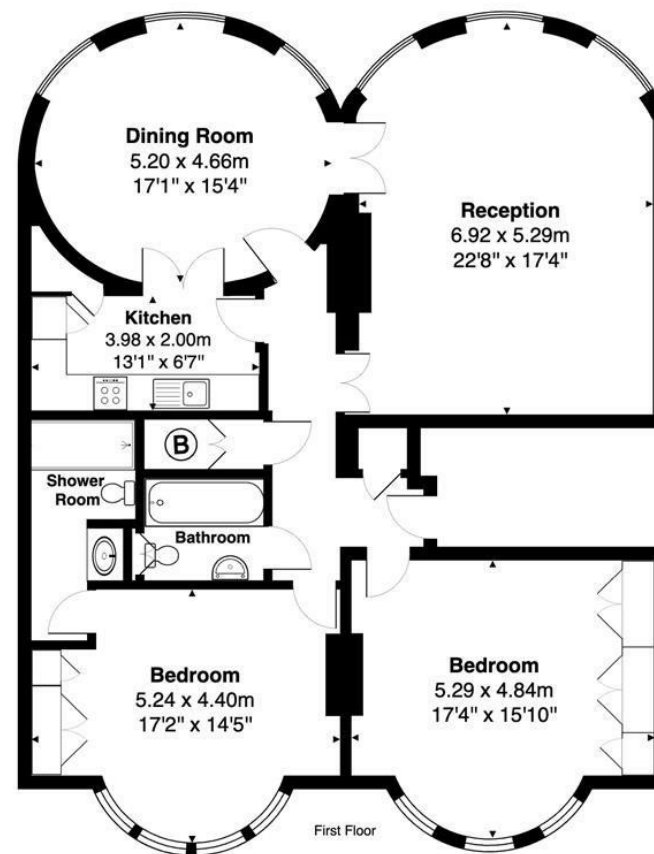

Approx. Gross Internal Area: 134.3 m² ... 1446 ft²

Dimensions are not to scale.

This plan is for guidance only and must not be relied upon as a statement of fact.

IMPORTANT: We would inform prospective purchasers that these sales particulars have been prepared as a general guide only. A detailed survey has not been carried out, nor the services, appliances and fittings tested. Room sizes should not be relied upon for furnishing purposes and are approximate. If floor plans are included, they are for guidance only and illustration purposes only and may not be to scale. If there are any important matters likely to affect your decision to buy, please contact us before viewing the property.