



24 Park Crescent,
Regents Park, W1B

£1,500 Per Week,

NAPIER WATT

T: 0207 935 0011
E: enquiries@napierwatt.co.uk
W: napierwatt.co.uk

35 Berkeley Square, Mayfair, London, W1J 5BF







Description

A stunning one bedroom apartment to rent on the lower ground floor of one of London's most exquisite developments. At approximately 732 sq ft, the apartment comprises a large living area, master bedroom with en-suite bathroom, large utility room and separate WC. Residents of the building have access to the incredible on site facilities including a 20 meter pool, sauna, steam room, gym and cinema room as well as 24-hour concierge service. Moments from Regents Park and Great Portland Street tube station.

Key Features

- 24-HOUR CONCEIRGE
- POOL
- GYM
- CINEMA

Terms

Fees & Charges: Tenancies exceeding £100,000 Per annum £480 inc VAT, Tenancies where a company is a tenant £480 Inc VAT.

Park Crescent

Approx. Gross Internal Area 740 Sq Ft - 68.75 Sq M

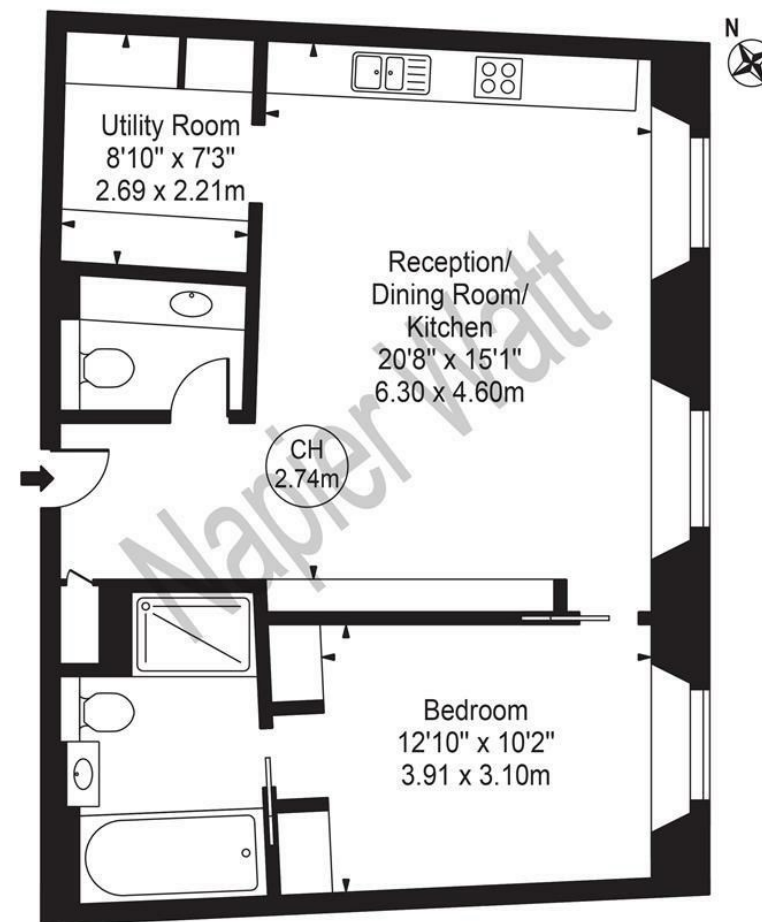

Lower Ground Floor

For Illustration Purposes Only - Not To Scale

This floor plan should be used as a general outline for guidance only and does not constitute in whole or in part an offer or contract. Any intending purchaser or lessee should satisfy themselves by inspection, searches, enquiries and full survey as to the correctness of each statement. Any areas, measurements or distances quoted are approximate and should not be used to value a property or be the basis of any sale or let.

IMPORTANT: We would inform prospective purchasers that these sales particulars have been prepared as a general guide only. A detailed survey has not been carried out, nor the services, appliances and fittings tested. Room sizes should not be relied upon for furnishing purposes and are approximate. If floor plans are included, they are for guidance only and illustration purposes only and may not be to scale. If there are any important matters likely to affect your decision to buy, please contact us before viewing the property.