



31 St Martin's Lane,
Covent Garden, WC2N

£2,565 Per Week,

NAPIER WATT

T: 0207 935 0011
E: enquiries@napierwatt.co.uk
W: napierwatt.co.uk

35 Berkeley Square, Mayfair, London, W1J 5BF







Description

This unique triplex apartment spans approximately 1,983 square feet and is spread across three floors. The lower level features a spacious reception room with ornate ceilings, complemented by a separate large kitchen. The upper levels house the bedrooms and bathrooms, offering ample living space. Additionally, there is loft storage space and abundant natural light throughout the apartment.

Located in Covent Garden, a popular shopping and tourist destination on the outskirts of the West End, the area boasts attractions such as the renowned Royal Opera House, which is home to the Royal Opera and Royal Ballet. Covent Garden's central square is famous for its street performers, theaters, restaurants, and elegant buildings, providing a vibrant and cultural atmosphere.

The nearest Tube stations are Covent Garden and Leicester Square, offering convenient transportation links.

Westminster Council Tax Band H : EPC Rating

Key Features

Terms

Fees & Charges: Tenancies exceeding £100,000 Per annum £480 inc VAT, Tenancies where a company is a tenant £480 Inc VAT.

St Martin's Lane, WC2N

Approximate Floor Area = 184.2 sq m / 1983 sq ft

Loft Storage = 19.2 sq m / 207 sq ft

Total = 203.4 sq m / 2190 sq ft

Including Limited Use Area (3.7 sq m / 40 sq ft) And Excluding Void

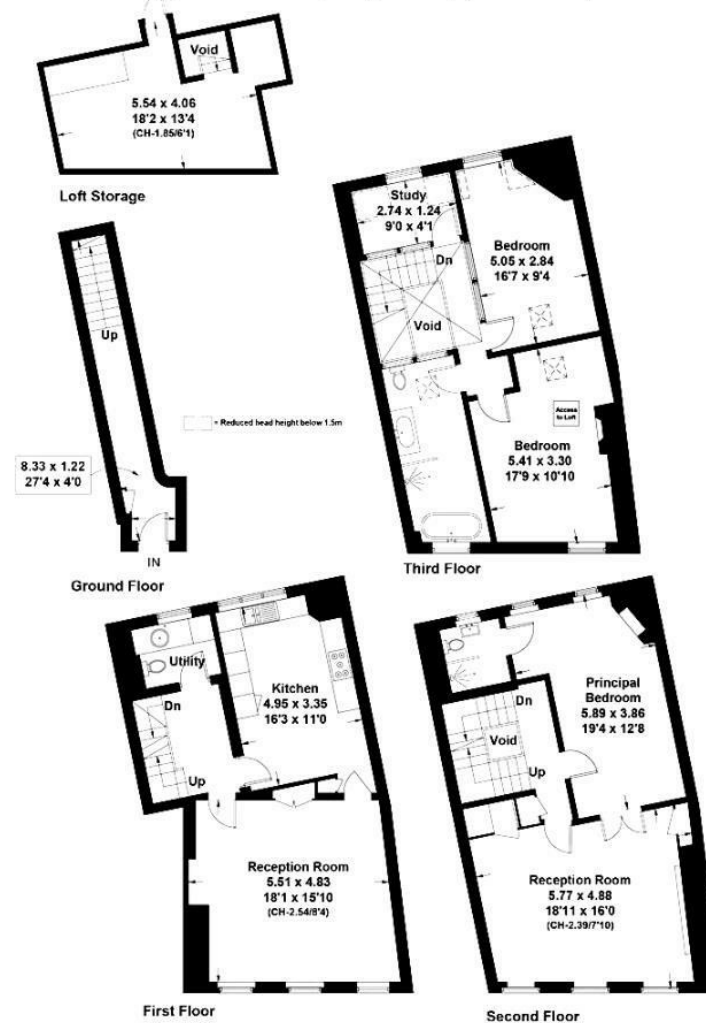

This plan is for layout guidance only. Not drawn to scale unless stated. Windows and door openings are approximate. Whilst every care is taken in the preparation of this plan, please check all dimensions, shapes and compass bearings before making any decisions reliant upon them. (ID842704)

IMPORTANT: We would inform prospective purchasers that these sales particulars have been prepared as a general guide only. A detailed survey has not been carried out, nor the services, appliances and fittings tested. Room sizes should not be relied upon for furnishing purposes and are approximate. If floor plans are included, they are for guidance only and illustration purposes only and may not be to scale. If there are any important matters likely to affect your decision to buy, please contact us before viewing the property.