



Bryanston Court II George Street,  
Marylebone, W1H

£2,475 Per Week,

NAPIER WATT

T: 0207 935 0011  
E: [enquiries@napierwatt.co.uk](mailto:enquiries@napierwatt.co.uk)  
W: [napierwatt.co.uk](http://napierwatt.co.uk)

35 Berkeley Square, Mayfair, London, W1J 5BF







## Description

A spacious four-bedroom apartment located on the ground floor of one of Marylebone's most desirable developments. Combining period charm and modern fixtures, this family home offers luxurious style in a fantastic building with 24-hour concierge. Featuring high ceilings, wooden floors and an abundance of natural light throughout, this newly refurbished unit comprises a large living room with dining area, separate fitted kitchen, master bedroom with built-in storage and en-suite shower room, three further bedrooms, a family bathroom with shower and a guest cloakroom. This property is ideally located for the boutique shops and restaurants in Marylebone Village. It is also within easy reach of the green open spaces of both Regent's and Hyde Park. Nearby transport links include Baker Street (Metropolitan, Bakerloo, Circle, Hammersmith & City and Jubilee Lines) and Marble Arch (Central Line) underground stations. Available now, furnished.

4 Bedrooms : 2 Bathrooms : Guest W.C. : 24-Hour Concierge : Lifts : Westminster Council Tax Band H : EPC Rating D

## Key Features

- FOUR BEDROOMS
- PASSENGER LIFT
- BEAUTIFULLY PRESENTED
- 24-HOUR CONCIERGE
- HIGH CEILINGS

## Terms

Fees & Charges: Tenancies exceeding £100,000 Per annum £480 inc VAT, Tenancies where a company is a tenant £480 Inc VAT.

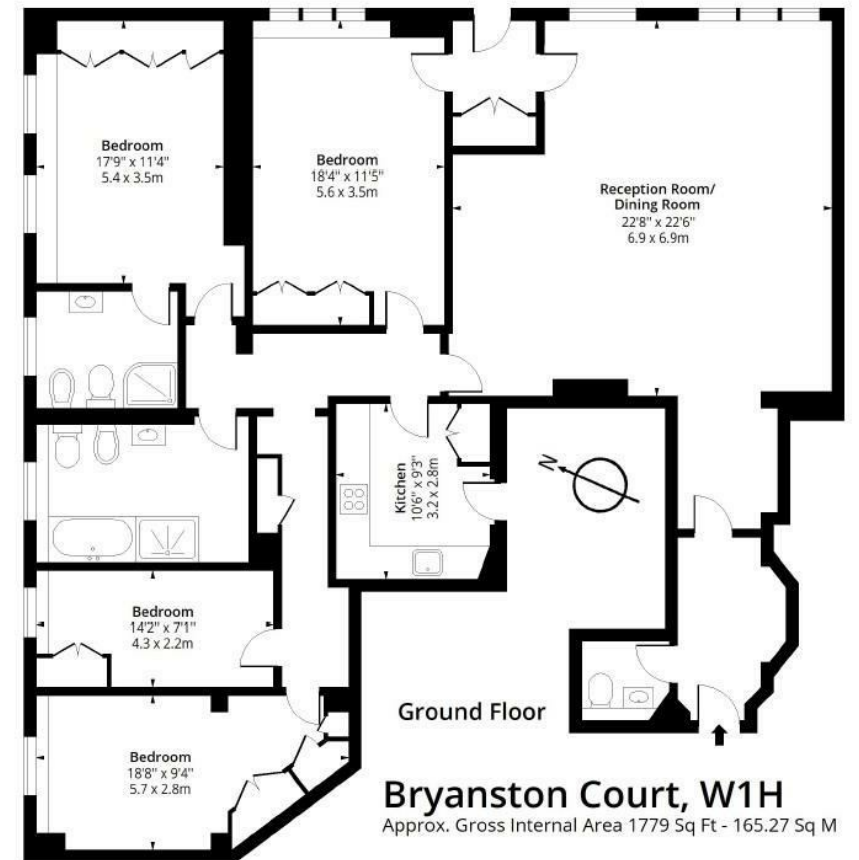

IMPORTANT: We would inform prospective purchasers that these sales particulars have been prepared as a general guide only. A detailed survey has not been carried out, nor the services, appliances and fittings tested. Room sizes should not be relied upon for furnishing purposes and are approximate. If floor plans are included, they are for guidance only and illustration purposes only and may not be to scale. If there are any important matters likely to affect your decision to buy, please contact us before viewing the property.