



Belvedere House
Kew Bridge, TW8





A breath-taking and unique Penthouse apartment located in the prestigious St George's development.

A truly exceptional spacious lateral apartment extending to 1,976 sq. ft, offering an abundance of natural light and remarkable panoramic views. The highlight is the circa 60ft south-facing roof terrace, providing spectacular river views and an outstanding space for relaxing or entertaining.

Positioned within this prestigious modern development, residents benefit from a 24-hour concierge, lift access, and a well-equipped residents' gym. The property also includes underground parking with a right to park (not allocated).

Beautifully arranged throughout, the apartment comprises three generous bedrooms and three bathrooms, including a stunning main suite, offering superb comfort and flexibility for both family living and hosting guests.

The reception room is equally impressive with floor to ceiling windows and leading through to a custom designed fully fitted kitchen and a utility room.

The apartment has been interior designed to the highest specification and has a multi-room audio/visual system throughout.

- Circa 60ft south facing roof terrace
- Spectacular panoramic and river views
- 24-hour concierge, lift and residents gym
- Underground Parking (Right to Park - Not Allocated)
- Spacious lateral apartment - 1,976 sq. ft
- Three bedrooms, three bathrooms

Asking Price £2,350,000

Energy Efficiency Rating		
Energy efficient - lower running costs	Current	Potential
92-100 A		
81-91 B	86	86
69-80 C		
55-68 D		
49-54 E		
41-48 F		
31-39 G		
Not energy efficient - higher running costs		
England, Scotland & Wales EU Directive 2002/91/EC		

Tenure: Leasehold 984 years remaining
Service Charge: £15,040 per annum
Ground Rent: £425 per annum
Local Authority: Hounslow Council
Council Tax Band: C

Chestertons South West Prime Sales

23a Friars Stile Road
 Richmond
 Surrey
 TW10 6NH
 swprime@chestertons.co.uk

Kew Bridge Road, Brentford, Middlesex, TW8

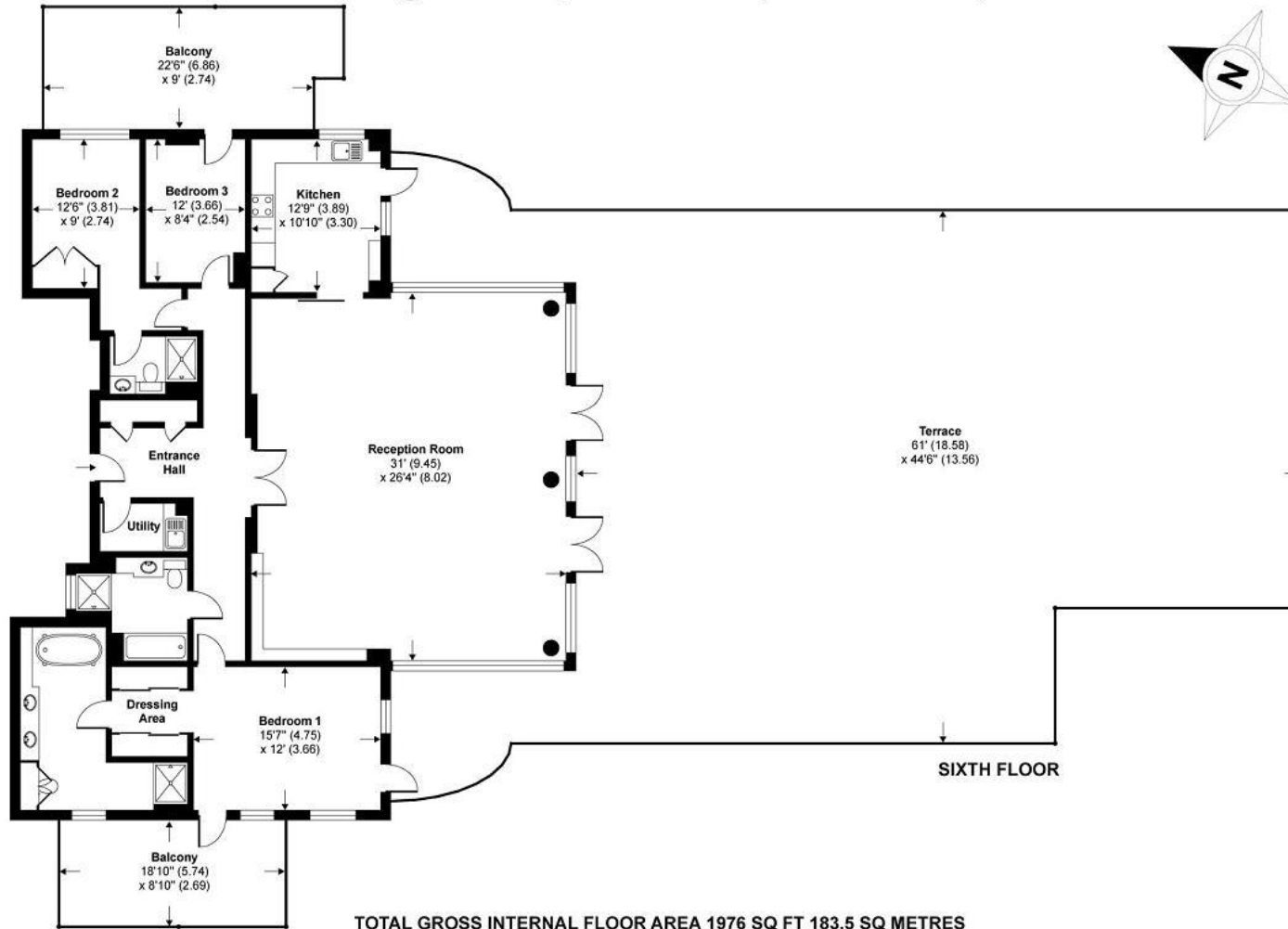

TOTAL GROSS INTERNAL FLOOR AREA 1976 SQ FT 183.5 SQ METRES

Whilst every attempt has been made to ensure the accuracy of the floor plan contained here, measurements of doors, windows and rooms are approximate and no responsibility is taken for any error, omission or misstatement. These plans are for representation purposes only as defined by RICS Code of Measuring Practice and should be used as such by any prospective purchaser. Specifically no guarantee is given on the total square footage of the property if quoted on this plan. Any figure given is for initial guidance only and should not be relied on as a basis of valuation.

Copyright nichecom.co.uk 2013 Produced for Chesterton Humberts REF : 432636

Chesterton UK Services Limited trading as Chestertons for themselves and for the vendor of this property whose agents they are, give notice that (i) these particulars do not constitute any part of an offer or contract, (ii) all statements contained within these particulars are made without responsibility on the part of Chestertons or the vendor, (iii) whilst made in good faith, none of the statements contained within these particulars are to be relied upon as a statement or representation of fact, (iv) any intending purchasers must satisfy themselves by inspection or otherwise as to the correctness of each of the statements contained within these particulars, (v) the vendor does not make or give either Chestertons or any person in their employment any authority to make or give representation or warranty whatsoever in relation to this property. Wide angle lenses may be used. ©Copyright Chestertons | Chesterton UK Services Limited | Registered Office 40 Connaught Street, Hyde Park, London W2 2AB Registered Company Number 05334580.



This paper is
100% recyclable