



WEST RIDING

SELLING HOMES

High Street, Uppermill, Saddleworth

£360,000

🛏 4 🚿 1 🚿 1



Discover this stunning four-bedroom property nestled in the vibrant heart of Uppermill village. Having undergone a meticulous restoration, this home effortlessly combines original charm with modern comforts. As you enter the inviting lounge, you will be captivated by the remarkable original features and the wealth of character. The centrepiece of the lounge is an exquisite original stone fireplace, complemented by a vintage, log-fueled, Jotul Easter Island stove, offering a cosy atmosphere. Large windows with a charming window seat flood the room with natural light, while wood-paneled walls and built-in bookcases add both character and functionality. The elegant oak wood floor sets the perfect backdrop for your gatherings.

Step into the hand-built solid wood kitchen, where culinary dreams come to life! With a solid oak wood surface, a Belfast sink featuring a boiling tap, an integrated dishwasher, a Stoves Range, a wine fridge, and bespoke cabinetry, this kitchen is truly a chef's delight. Beautiful marble tiling adorns the walls, adding a touch of luxury. Conveniently located off the kitchen are a utility room and a WC, featuring a Fisher & Paykel fridge that can quickly chill your favorite beverages. The energy-efficient air pump condenser dryer not only saves you money but is also environmentally friendly. Locally sourced, custom-made stone flooring completes this space beautifully. The useful cellar to this property is currently utilised as a wine cellar and provides ample storage space.

This remarkable property is equipped with stylish column radiators, and the advanced Hive boiler can be controlled from your smartphone, ensuring comfort at your fingertips. A beautifully crafted stable door invites you to the decked area in the back, offering a tranquil escape along with access to a communal garden and convenient parking for one car, with plenty of additional visitor spaces available.



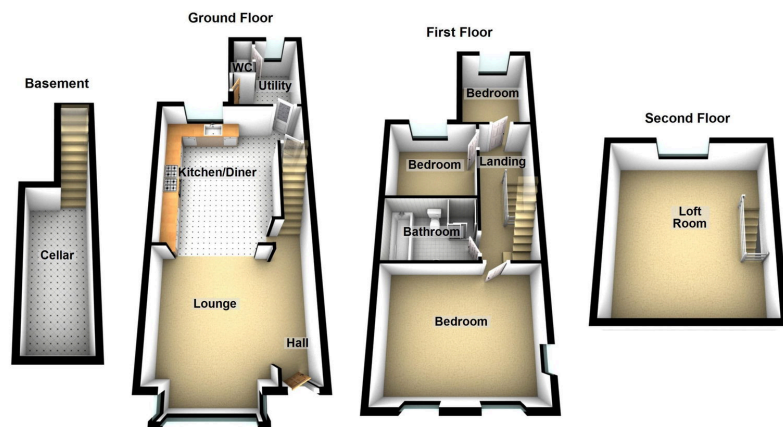

- 4 Bedroom Property in The Heart Of Uppermill Village
- Lovingly Restored
- Character Filled
- Allocated Off Road Parking
- Within Walking Distance to Local Schools
- Walking Distance to Local Amenities
- 5 Minute Drive to Greenfield Trainstation with Trans Peninne Routes
- View of River Tame
- View of Pots and Pans
- Energy Rating - E

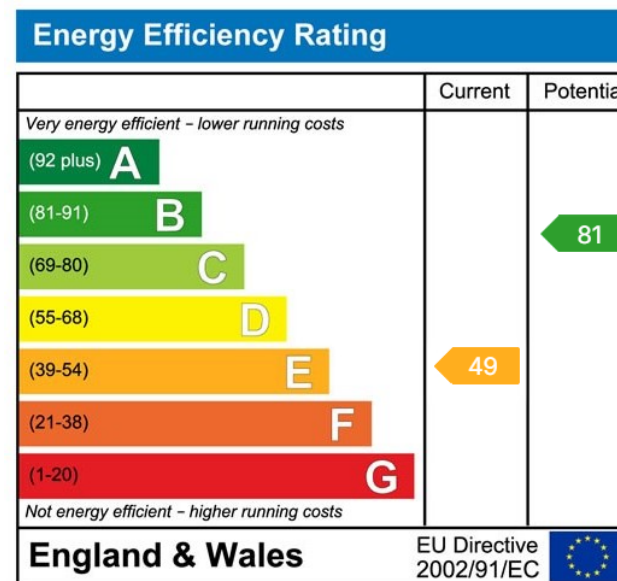

hello@west-riding.co.uk

01457 819181

www.west-riding.co.uk