



# Huddersfield Road, Diggle, Saddleworth

£220,000

3 1 1



- Stone Terrace Property
- Communal Rear Yard
- Useful Storage/Study Room
- Ideal First Purchase
- Three Bedrooms
- Central Village Location
- Primary & Secondary School Nearby
- Energy Rating C



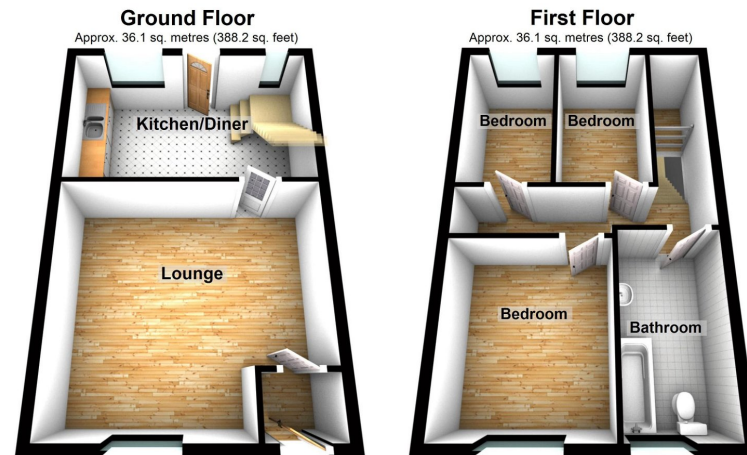

Total area: approx. 72.1 sq. metres (776.3 sq. feet)

Located in central Diggle village is this stone terrace property. Well presented to the market and making the ideal first home in one of Saddleworth's most popular villages, this home is within easy walking distance of both Diggle Primary School and Saddleworth Secondary School.

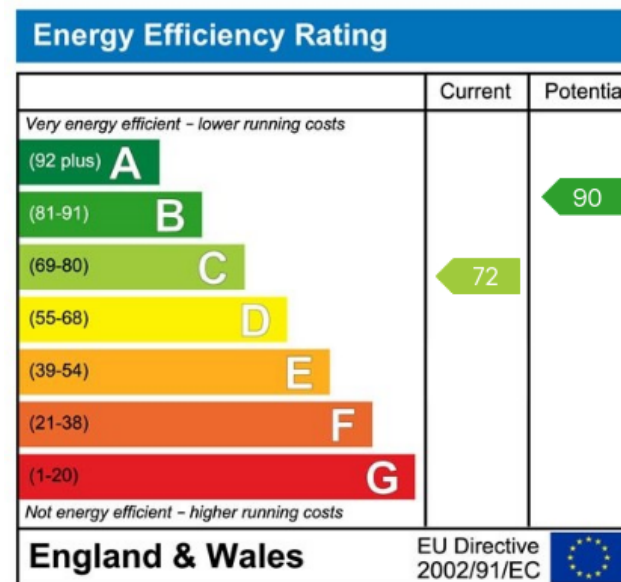

### Uppermill Office

35 High Street  
Uppermill,  
Saddleworth  
OL3 6HS

Monday – Friday. 9am – 5pm  
Saturday. 10am – 3 pm  
uppermill@kirkham-property.co.uk  
t: 01457 810 076  
f: 01457 810 222

Out of hours telephone service  
Monday – Thursday 8:30am – 7pm  
Friday – 8:30am – 5pm  
Saturday – Sunday 10am – 3pm