

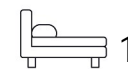

Living
made
better

Harvesters Close
Isleworth, TW7 7PS



Asking Price £294,950

Harvesters Close, Isleworth TW7 7PS

Madison Brook

A beautifully presented ground floor garden maisonette with one double bedroom, very long lease with 998 years, and offered for sale with no chain. The property offers direct access to a lovely West facing private rear garden, has its own private entrance, and an allocated off-street parking space. This location gives good access to green spaces and the amenities and railway stations of both Whitton and Twickenham town centres.

A double-glazed front door leads to the entrance porch with space for coats storage. There is a through reception room with ample space for separate sitting and dining areas. Light floods in through front and side aspect double-glazed windows and there is a built-in understairs storage cupboard. The kitchen has a range of modern fitted units with solid wood worksurfaces. There is an integrated stainless-steel oven, four ring hob and extractor fan. There is space and plumbing for a washing machine, space for a fridge freezer, and side aspect double-glazed window. A door leads to an inner hall with a large walk-in storage cupboard and wall mounted gas central heating boiler. There is a good-sized double bedroom with double-glazed French style doors to the garden. The bathroom and W.C have a modern fitted white suite with a bath with a wall mounted shower attachment. There is a pedestal wash hand basin, chrome heated towel rail, part tiled walls, and



Floorplan

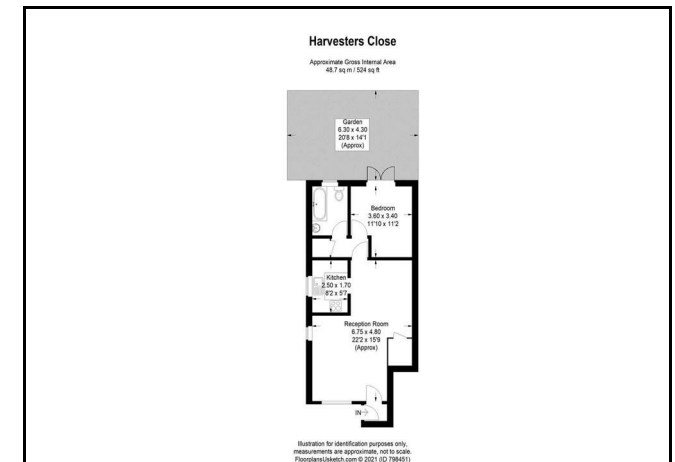

Area Map

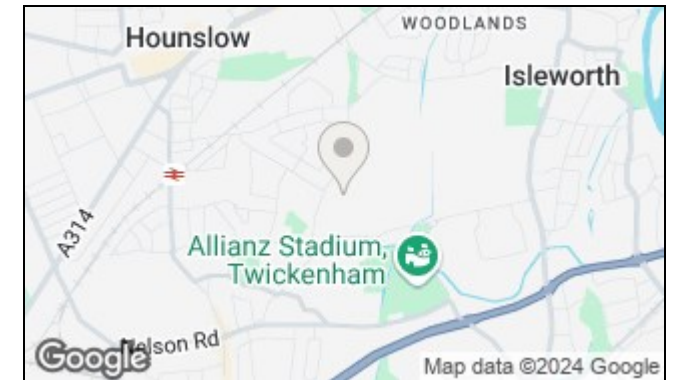

Energy Efficiency Graph

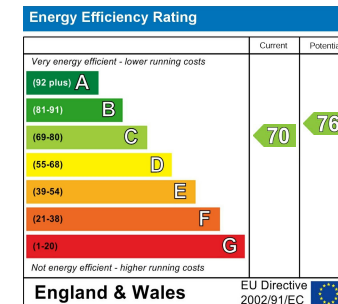

These particulars, whilst believed to be accurate are set out as a general outline only for guidance and do not constitute any part of an offer or contract. Intending purchasers should not rely on them as statements of representation of fact, but must satisfy themselves by inspection or otherwise as to their accuracy. No person in this firm's employment has the authority to make or give any representation or warranty in respect of the property.

103 High Street, Hampton Hill, TW12 1NJ
Tel: 020 3946 6700 Email: hamptonhill@madisonbrook.com <https://madisonbrook.com/>