



Flat 5, 46 Brownlow Road , London, N11, N11 2DE

We are proud to offer this modern one bedroom flat for sale in Bounds Green.

Offered chain free, this delightful one bedroom flat is situated on Brownlow Road, just a short walk from Bounds Green tube station, making it an excellent location for commuters. Bowes Park Overground Station is also just a short walk away, with direct trains to Kings Cross and the city. The property is located on the ground floor and offers a spacious South facing private wrap around garden area.

The flat benefits from a good sized double bedroom, an open plan living room with kitchen area and a recently tiled modern bathroom which features a shower, WC and washbasin. The private garden area is a real selling point of this property, offering plenty of space for outdoor entertaining, gardening, or simply relaxing in the sun.

Furthermore, the property is double glazed throughout and has gas central heating, ensuring a warm and cosy living environment. Ideal for first time buyers or investors.

Early viewings advised

Asking price £279,000

Flat 5, 46 Brownlow Road

, London, N11, N11 2DE



- Excellent Transport Links
- Individual Front Door Access
- Recently Tiled Bathroom
- Ideal For First Time Buyers / Investors
- Private South Facing Garden
- Modern Throughout
- Within Close Proximity To Bowes Park Overground Station
- Ground Floor
- Chain Free
- 2 Minute Walk To Bounds Green Station (Piccadilly Line)

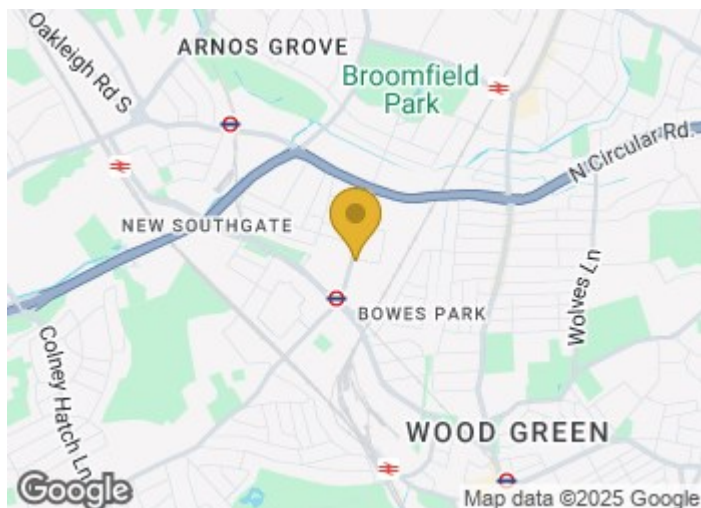

[Directions](#)



Floor Plan

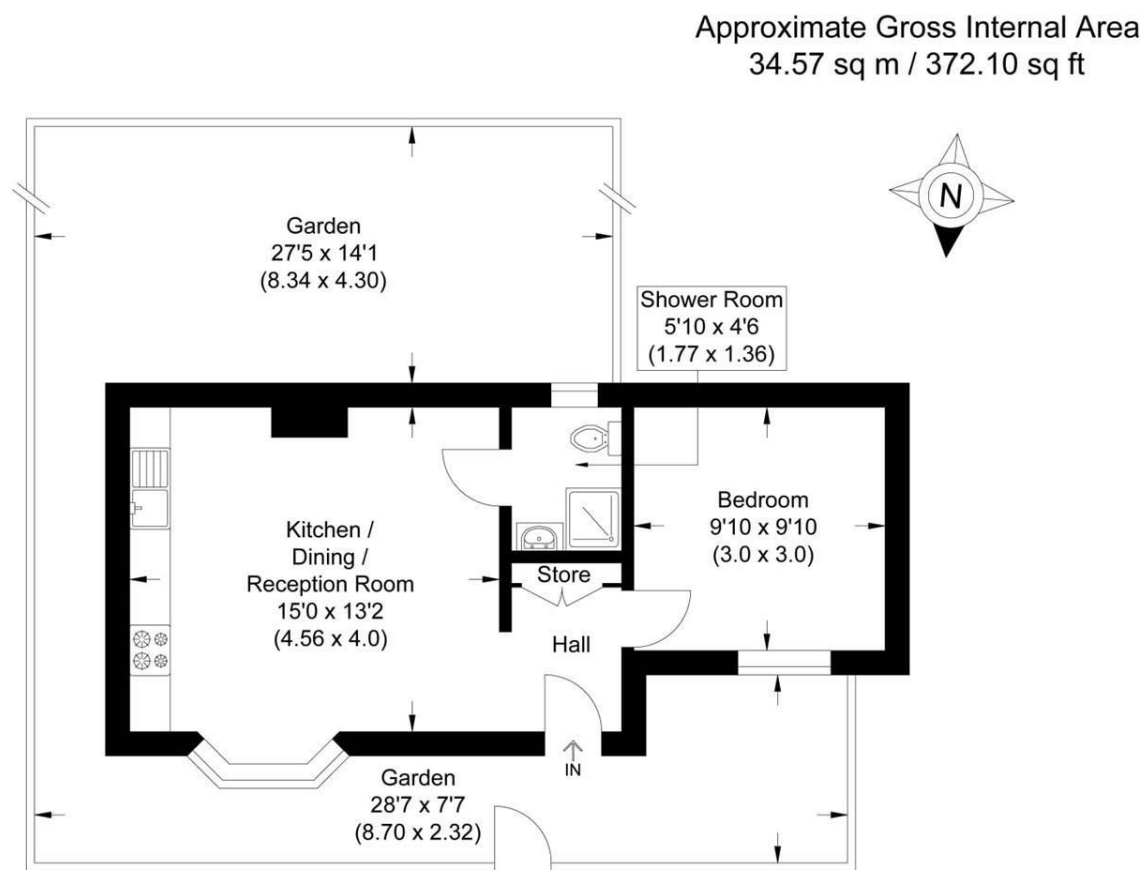

Illustration for identification purposes only, measurements are approximate, not to scale.

These particulars, whilst believed to be accurate are set out as a general outline only for guidance and do not constitute any part of an offer or contract. Intending purchasers should not rely on them as statements of representation of fact, but must satisfy themselves by inspection or otherwise as to their accuracy. No person in this firms employment has the authority to make or give any representation or warranty in respect of the property.

