



Clipstone Street, W1W 5DH
£3,500 Per Week

coopers
OF LONDON EST. 1986

Clipstone Street, W1W

- Available 13th October 2025
- Fully Furnished
- Duplex Apartment
- Spacious Double Bedrooms
- Balcony
- Communal Gardens
- Excellent Transport Links

Coopers of London are delighted to present a spacious four bedroom property in stylish Fitzrovia, close to Westminster University.

This bright, spacious flat features four double bedrooms, fully equipped kitchen/diner, bathroom and guest WC.

This 4th floor, fully furnished property would be perfect for students or professional sharers.

Excellent transport links via Great Portland Street, Warren Street and Regent`s Park tube stations.





Holcroft Court Clipstone Street, London, W1W 5DH

GROSS INTERNAL AREA
78.8sqm / 848.2sqft

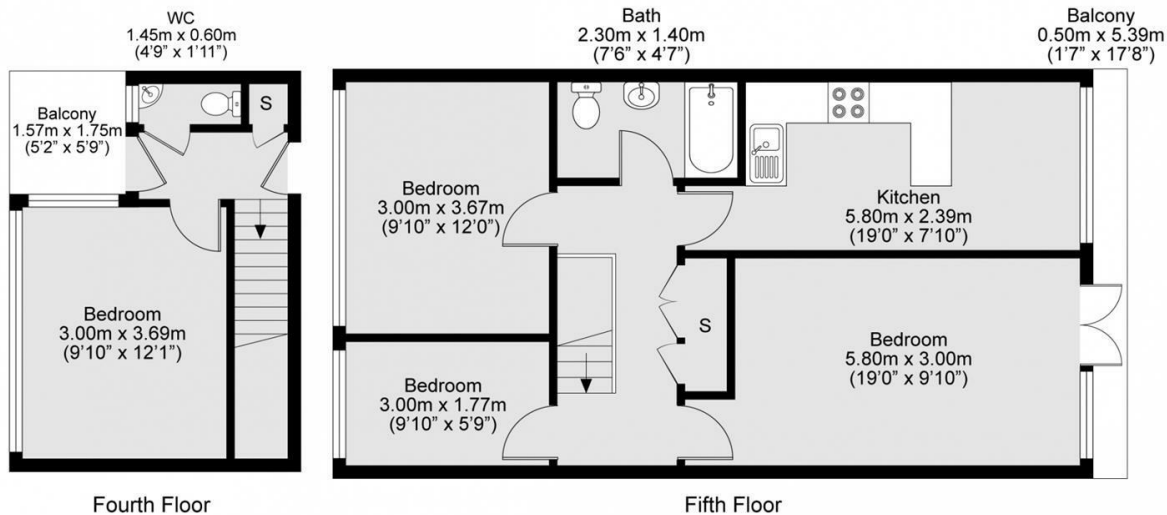

GROSS INTERNAL AREA(GIA)
The footprint of the property
78.8sqm / 848.2sqft

TOTAL STORAGE SPACE
Storage and wardrobe total area
1.5sqm / 16.2sqft

EXTERNAL STRUCTURAL FEATURES
Balcony, Terrace, Verandah etc.
2.7sqm / 29.1sqft

RESTRICTED HEAD HEIGHT
Limited use area under 1.5m
0.0sqm / 0.0sqft



Disclaimer: Floorplan measurements are approximate and are for illustrative purposes only. While we do not doubt the floorplan accuracy and completeness, you or your advisors should conduct a careful, independent investigation of the property in respect of monetary valuation.

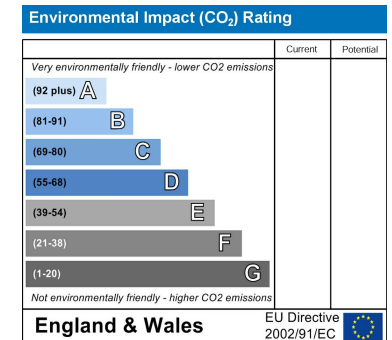
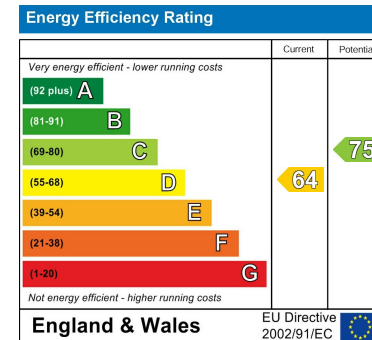

Viewing

Strictly by appointment with:
Coopers of London, 22 Cleveland Street,
Fitzrovia, London W1T 4JB
info@coopersonlondon.co.uk

0207 580 9658

These particulars, whilst believed to be accurate are set out as a general outline only for guidance and do not constitute any part of an offer or contract. Intending purchasers should not rely on them as statements or representation of fact, but must satisfy themselves by inspection or otherwise as to their accuracy. No person in this firm's employment has the authority to make or give any representation or warranty in respect of the property.