



Queens Quay, 58 Upper Thames Street, EC4V 3EH
£1,850 Per Month

coopers
OF LONDON EST. 1986

Queens Quay, 58 Upper Thames Street, EC4V

- AVAILABLE JUNE
- STUDIO APARTMENT
- CITY LOCATION
- DAY PORTER
- LIFT ACCESS

A fantastic fourth floor studio apartment situated in the heart of the city boasting panoramic views from the communal roof terrace. Located close to St Paul's Cathedral and Tate Modern.

The property has recently been re-decorated with new furniture. It has a fully fitted kitchen, modern bathroom, ample storage and a good size studio room.

The building has a day porter available and lift access.

Mansion House and Cannon Street are the nearest underground stations.





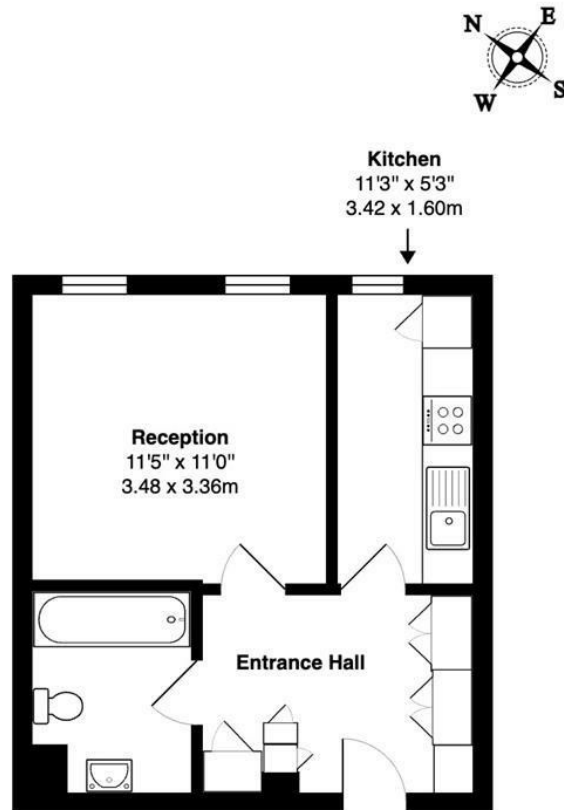

4th Floor

Queens Quay Upper Thames Street, EC4V

Total Gross Area: 332 ft² ... 30.8 m²

All measurements are approximate and for identification guideline purposes only, not to scale.
Compliant with the RICS code of measuring practice

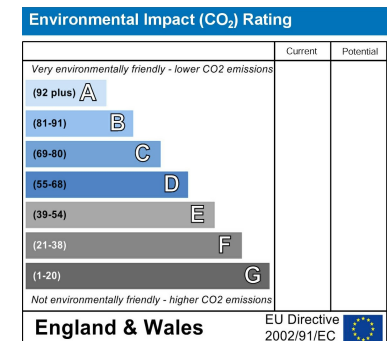
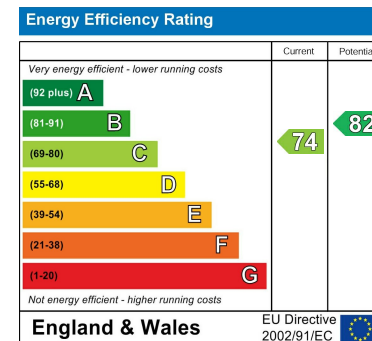

Viewing

Strictly by appointment with:
Coopers of London , 22 Cleveland Street,
Fitzrovia, London W1T 4JB
info@coopersonlondon.co.uk

0207 580 9658

These particulars, whilst believed to be accurate are set out as a general outline only for guidance and do not constitute any part of an offer or contract. Intending purchasers should not rely on them as statements or representation of fact, but must satisfy themselves by inspection or otherwise as to their accuracy. No person in this firms employment has the authority to make or give any representation or warranty in respect of the property.