



Botanic Square, E14 0NJ
£2,850 Per Month

coop
OF LONDON
EST. 1986

Botanic Square, E14

- Available August 1st
- Furnished
- 14th Floor
- 2 Bedroom 2 Bathroom
- Balcony
- Concierge
- Resident's Gym, Spa and Pool
- Excellent Transport Links
- Parking Included

Coopers of London are delighted to present this 14th floor, modern, spacious two bedroom furnished apartment in the exclusive London City Island development.

This stylish apartment is finished to a very high spec throughout and comprises: entrance hallway, master bedroom with en suite, double bedroom, bathroom, open plan kitchen/reception and balcony with great views of Canary Wharf and development's garden area. Both bedrooms include fitted wardrobes with ample storage space in the hallway and kitchen.

The residents will have exclusive use of the development's gym, pool & spa. With an on site grocery store, as well as 24 hour concierge.

London City Island is situated on a private peninsula with an exclusive entrance walkway to Canning Town Underground and DLR station. Access to Canary Wharf and The City is extremely quick and simple.

Parking included (registration admin fees apply).



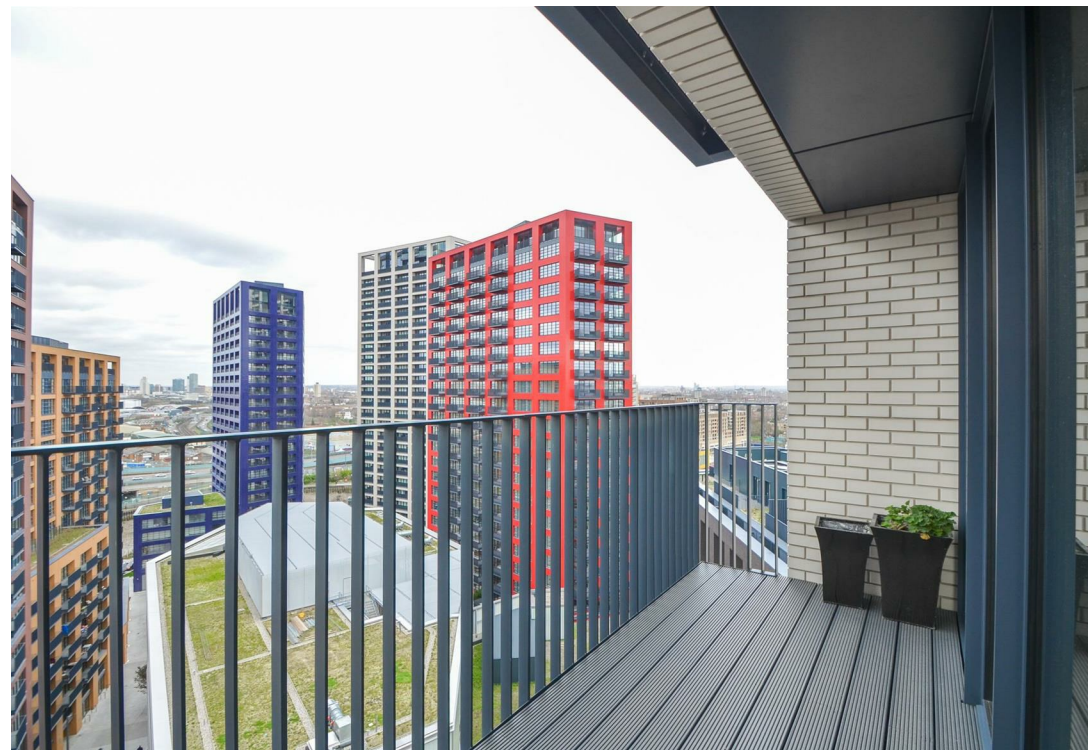

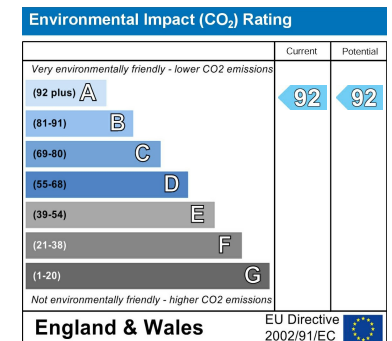
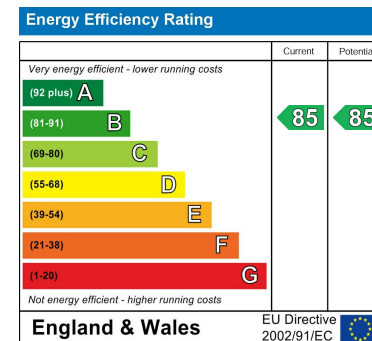

Viewing

Strictly by appointment with:
Coopers of London , 22 Cleveland Street,
Fitzrovia, London W1T 4JB
info@coopersoflondon.co.uk

0207 580 9658

These particulars, whilst believed to be accurate are set out as a general outline only for guidance and do not constitute any part of an offer or contract. Intending purchasers should not rely on them as statements or representation of fact, but must satisfy themselves by inspection or otherwise as to their accuracy. No person in this firms employment has the authority to make or give any representation or warranty in respect of the property.