

Hosier Lane

London • • EC1A 9LS

PCM: £2,600 PCM



coopers
est 1986

Hosier Lane

London • • EC1A 9LS

Coopers of London are delighted to present this beautifully designed one bedroom flat in the heart of the City, close to St Paul's, Farringdon and Barbican tube stations.

This spacious apartment on the fifth floor of the popular 10 Hosier Lane development, features modern open plan kitchen & lounge, bathroom, double bedroom with fitted wardrobe and ample storage space throughout.

Available furnished.

Available 11th October 2024

Furnished

5th Floor

Good Storage Space

Double Sized Bedroom

Excellent Transport Links

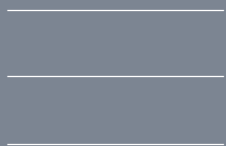

These particulars are intended as a guide and must not be relied upon as statements of fact. Your attention is drawn to the Important Notice on the last page.



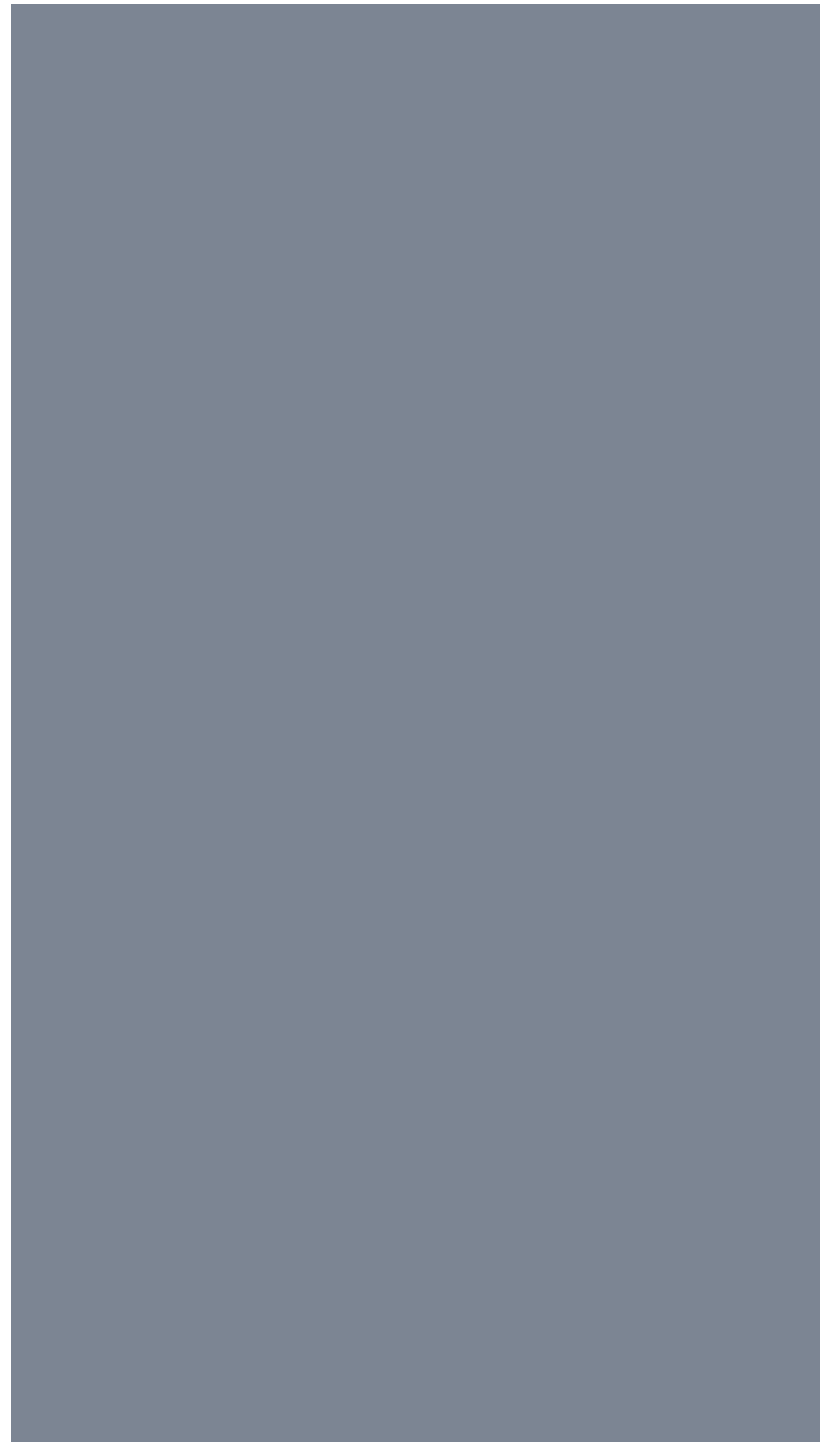



Schools:

video tour within listing



Train:



Car:

M4, A40, M25, M40



Council Tax Band:

(Distances are straight line measurements from centre of postcode)



Fifth Floor

Approx. 42.6 sq. metres (458.0 sq. feet)

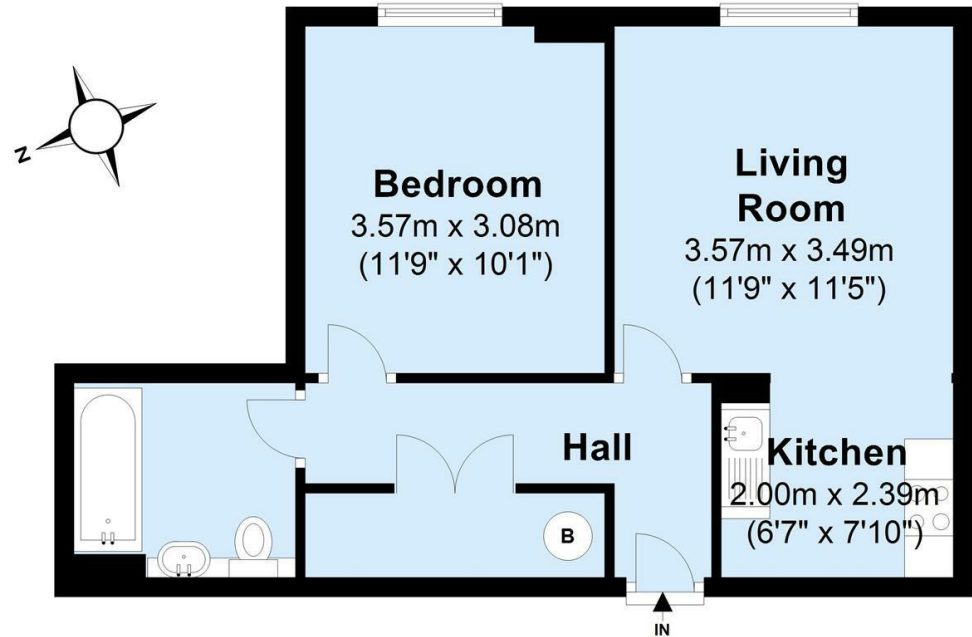

Total area: approx. 42.6 sq. metres (458.0 sq. feet)



0207 580 9658
22 Cleveland Street, Fitzrovia,
London, W1T 4JB
info@coopersonlondon.co.uk

CoopersResidential.co.uk

Energy Efficiency Rating	
Current	Potential
Very energy efficient - lower running costs	
Very good (A)	
Good (B)	
Good (G)	70
Not energy efficient - higher running costs	
Very poor (G)	
England & Wales	EU Directive 2002/91/EC

Important Notice: These particulars, whilst believed to be accurate are set out as a general outline only for guidance and do not constitute any part of an offer or contract. Intending purchasers should not rely on them as statements or representation of fact, but must satisfy themselves by inspection or otherwise has the authority to make or give any representation or warranty in respect of the property.