

Because life is

PettyTM
Real

9 Prospect Terrace
Barrowford
BB9 6HN



For Sale

£109,950

- Spacious mid terrace
- Popular location
- Ideal for a first time buyer or downsizer
- Near to amenities
- Lounge

- Dining kitchen
- Utility & WC
- Two bedrooms
- Bathroom
- Some updating required



Don't miss out on this amazing opportunity to own a charming two-bedroom terrace home nestled in the highly coveted area of Barrowford. Perfectly positioned near local conveniences, transportation hubs, and trendy bistros, this residence offers both comfort and convenience. With the M65 motorway just a stone's throw away, commuting to Burnley, Blackburn, and Preston is a breeze.

Step inside to discover a welcoming sitting room, a convenient downstairs w.c, a functional kitchen, and a utility. Upstairs, you'll find two generously sized bedrooms along with a sleek and coloured 3-piece bathroom suite. Outside, a tidy enclosed forecourt awaits at the front, while a well-maintained yard graces the rear.

This property boasts numerous desirable features and presents a fantastic opportunity for homeownership. Act fast and schedule your viewing today to secure your chance at this exceptional dwelling.

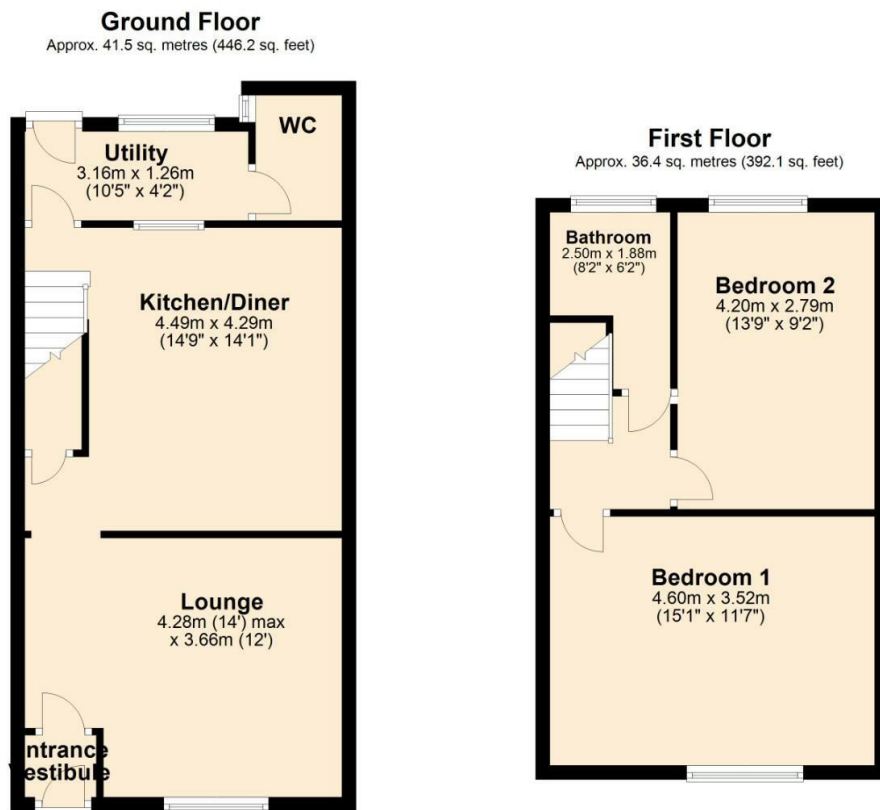

Total area: approx. 77.9 sq. metres (838.3 sq. feet)



These particulars, whilst believed to be accurate are set out as a general outline only for guidance and do not constitute any part of an offer or contract. Intending purchasers should not rely on them as statements of representation of fact, but must satisfy themselves by inspection or otherwise as to their accuracy. No person in this firm's employment has the authority to make or give any representation or warranty in respect of the property.

134 Gisburn Road, Barrowford, Lancashire, BB9 6HQ
T. 01282 615900
Barrowford.sales@pettyreal.co.uk

www.pettyreal.co.uk