

Because life is

PettyTM
Real

117 Hollingreave Road
Burnley
BB11 2HU



- For Sale by Auction – T & C's apply
- Subject to an undisclosed Reserve Price
- Reservation Fee applicable
- The Modern Method of Auction



For Sale

- Mid-Terrace
- Elevated Position
- Two Bedrooms
- Renovation Required
- One Large Reception Room

Auction Guide £40,000

- Kitchen/Diner
- Close To Towneley Park
- Near To Bus Stops
- Leasehold
- Gas Central Heating



Lovely, elevated two-bed mid-terrace located in Burnley Wood. Perfect for first-time buyers or an investor with a potential rent of £575 PCM. Close to local schools, bus stops, and a short walk to Towneley Park.

Entering into the living room it provides plenty of space and fantastic potential to make your own. To the rear is the kitchen/diner with matching wall, base, and drawer units with contrasting working surfaces.

On the first floor, there are two double bedrooms and a central bathroom suite comprising a low-level WC, a pedestal hand wash basin, and a paneled bath.

Externally there is an enclosed rear yard.

Ground Floor

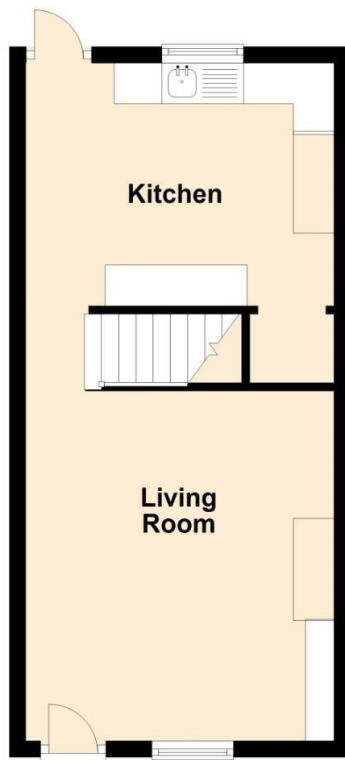

First Floor



These particulars, whilst believed to be accurate are set out as a general outline only for guidance and do not constitute any part of an offer or contract. Intending purchasers should not rely on them as statements of representation of fact, but must satisfy themselves by inspection or otherwise as to their accuracy. No person in this firm's employment has the authority to make or give any representation or warranty in respect of the property.

4 Manchester Road, Burnley, Lancashire, BB11 1HH

T.

Burnley.sales@pettyreal.co.uk burnley.lettings@pettyreal.co.uk
property.management@pettyreal.co.uk

www.pettyreal.co.uk