

Because life is

Petty
Real™

110 Richmond Avenue
Burnley
BB10 4JL



For Sale

- Two Bedrooms
- Semi Detached
- Bungalow
- Conservatory
- Fitted Kitchen

Offers Over £250,000

- Beautiful Views
- Driveway And Garage
- Garden Front And Rear
- Quiet Location



Nestled in a picturesque area of Burnley, this charming 2-bedroom semi-detached bungalow is the epitome of tranquility and comfort. With its idyllic location, spacious living areas, and breathtaking views, this could be the next property for you.

This bungalow features two generously sized bedrooms, perfect for accommodating a small family or hosting guests. Each room is designed for maximum comfort and tranquility, ensuring restful nights and peaceful mornings.

Step inside the cozy living room and feel immediately at home. Natural light floods the space, creating an inviting ambiance where you can relax with family and friends. The room is the heart of the home, ideal for both entertaining and unwinding.

The modern fitted kitchen offers plenty of counter space and modern appliances. Whether you're preparing a quick breakfast or a gourmet dinner, you'll have everything you need at your fingertips.

The bathroom comprises a white three piece suite with shower over bath, basin and toilet.

One of the highlights of this property is the beautiful conservatory. It's the perfect place to enjoy your morning coffee or curl up with a good book while basking in the warmth of the sun. With views of the garden and the fields beyond, this space truly brings the outdoors inside.

The bungalow's unique selling point is its remarkable view. You'll wake up to stunning vistas of rolling fields every morning, providing a sense of peace and tranquility that's hard to find elsewhere.

To the rear of the property, the garden offers a serene escape, complete with lush greenery and a stunning vista of open fields. It's a space where you can garden, dine al fresco, or simply unwind as you take in the breathtaking scenery. To the front of the property is a driveway and a small lawn surrounded by shrubbery.

The property benefits from modern day comforts of double glazing and gas central heating

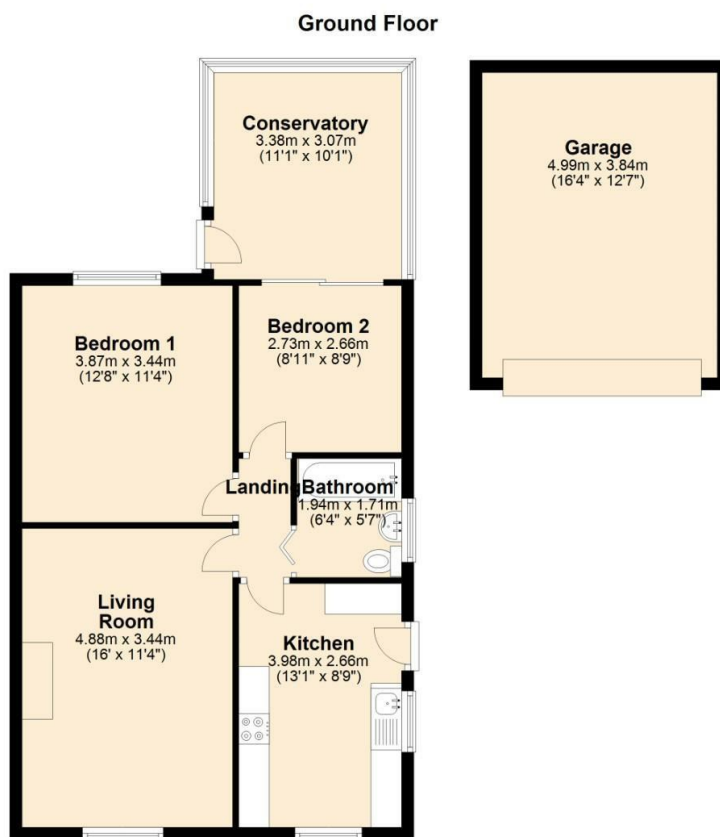

These particulars, whilst believed to be accurate are set out as a general outline only for guidance and do not constitute any part of an offer or contract. Intending purchasers should not rely on them as statements of representation of fact, but must satisfy themselves by inspection or otherwise as to their accuracy. No person in this firm's employment has the authority to make or give any representation or warranty in respect of the property.

4 Manchester Road, Burnley, Lancashire, BB11 1HH

T.

Burnley.sales@pettyreal.co.uk burnley.lettings@pettyreal.co.uk
property.management@pettyreal.co.uk

www.pettyreal.co.uk