



49 Briarfield Avenue

Offers Over £240,000

1 1

A well presented three bedroom semi-detached family home. This property is located just off Ditchfield Road in a 'sought after' location handily placed for local schooling and within walking distance of Hough Green railway station, occupying a superb position tucked away at the bottom of the road.



Floor Area: sq. ft.

Tenure: Freehold

Service Charge: £ per annum

Ground Rent: £ per annum

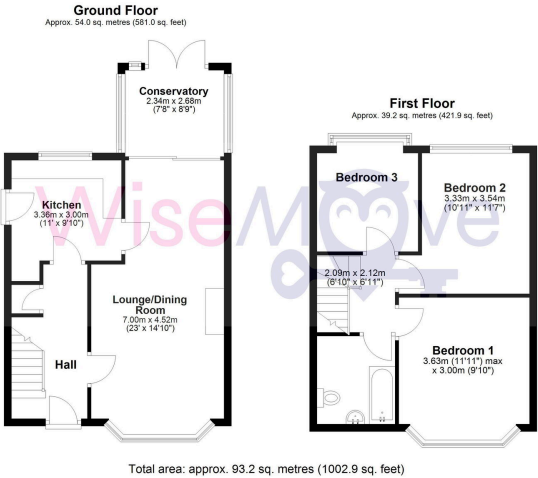

hello@wise-move.co.uk

Company Number:- 14695463

wise-move.co.uk
0151 424 3401

Agents Note: Whilst every care has been taken to prepare these sales particulars, they are for guidance purposes only. All measurements are approximate are for general guidance purposes only and whilst every care has been taken to ensure their accuracy, they should not be relied upon and potential buyers are advised to recheck the measurements