





## 304 Liverpool Road

£350,000

3 2

Welcome to Liverpool Road, a superb three bed semi with an garage conversion to give an additional BEDROOM WITH EN-SUITE. This family home has an abundance of space with an extension to the ground floor.

Early viewing is highly recommended.





Floor Area: sq. ft.

Tenure: Not given

Service Charge: £ per annum

Ground Rent: £ per annum

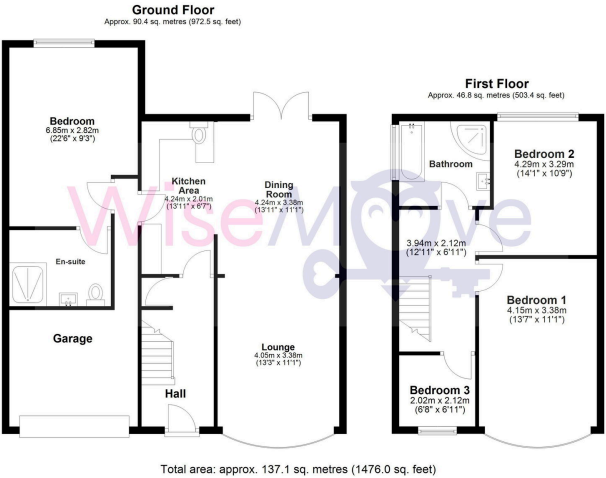

hello@wise-move.co.uk

Company Number:- 14695463

wise-move.co.uk  
0151 424 3401

Agents Note: Whilst every care has been taken to prepare these sales particulars, they are for guidance purposes only. All measurements are approximate and for general guidance purposes only and whilst every care has been taken to ensure their accuracy, they should not be relied upon and potential buyers are advised to recheck the measurements