



## 6 Albion Crescent, Portland

£400,000 Freehold

Five Double Bedrooms • Off Road Parking • Sea Views • Two Receptions • Three Bathrooms • Spacious Accommodation • Kitchen/Diner • Character Features • Garage/Workshop

**COCO**  
PROPERTY





Stunning five bed end of terrace house with sea views. Spacious living, three bathrooms, two reception rooms, and character features. Ideal for seeking comfort in sought-after seaside location.

Council Tax band: C

Tenure: Freehold

EPC Energy Efficiency Rating: D

EPC Environmental Impact Rating:



- › Five Double Bedrooms
- › Off Road Parking
- › Sea Views
- › Two Receptions
- › Three Bathrooms
- › Spacious Accommodation
- › Kitchen/Diner
- › Character Features
- › Garage/Workshop





**Living Room**

18' 3" x 15' 1" (5.56m x 4.59m)

**Dining Room**

16' 0" x 12' 8" (4.89m x 3.85m)

**Kitchen/Diner**

22' 1" x 9' 6" (6.72m x 2.90m)

**(First Floor) Bedroom One**

18' 1" x 15' 4" (5.50m x 4.67m)

Into Bay Max Measurements

**(Second Floor) Bedroom Two**

18' 7" x 12' 10" (5.67m x 3.92m)

**(First Floor) Bedroom Three**

12' 8" x 9' 4" (3.87m x 2.85m)

**(First Floor) Bedroom Four**

12' 7" x 12' 6" (3.84m x 3.82m)

**(First Floor) Bedroom Five**

12' 9" x 8' 1" (3.88m x 2.47m)

**(First Floor) Bathroom**

9' 5" x 8' 10" (2.87m x 2.70m)

Max Measurements

**Shower Room**

6' 9" x 5' 4" (2.05m x 1.63m)

**En-Suite**

5' 6" x 5' 3" (1.68m x 1.59m)



Approx Gross Internal Area  
218 sq m / 2350 sq ft

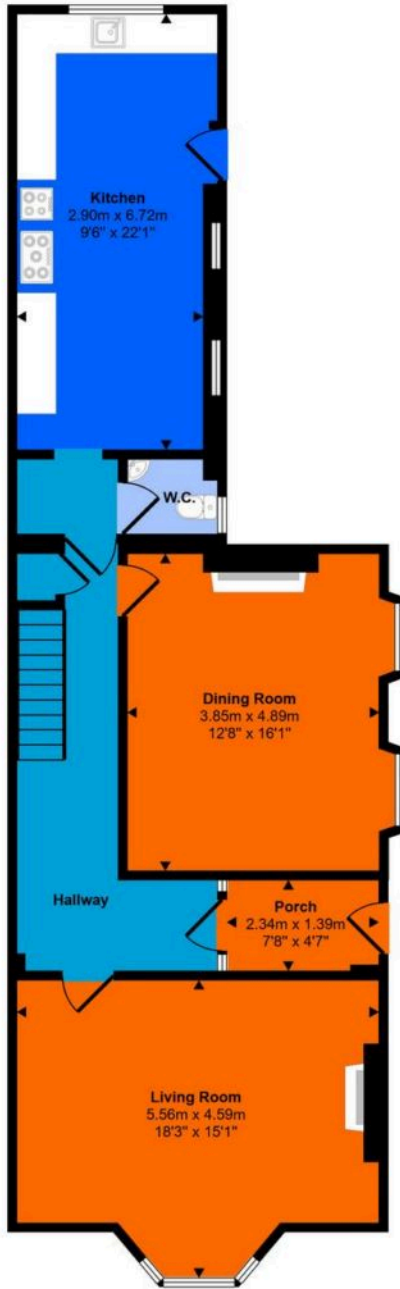

Ground Floor  
Approx 87 sq m / 931 sq ft



First Floor  
Approx 72 sq m / 772 sq ft



Second Floor  
Approx 60 sq m / 647 sq ft

This floorplan is only for illustrative purposes and is not to scale. Measurements of rooms, doors, windows, and any items are approximate and no responsibility is taken for any error, omission or mis-statement. Icons of items such as bathroom suites are representations only and may not look like the real items. Made with Made Snappy 360.

You can include any text here. The text can be modified upon generating your brochure.