

41 Officers Field, Portland

£495,000 Freehold

Southerly Aspect Garden • Four Double Bedrooms • Balcony • Sea Views • Two Bathrooms • Successful Holiday Let • Moments To Beach • Open Plan Ground Floor • Cloakroom



Stunning Four bed family home with southerly garden, private parking, balcony & sea views. Offers no chain, close to beach & bus routes.

Successful holiday let.

Council Tax band: TBD

Tenure: Freehold

EPC Energy Efficiency Rating: C

EPC Environmental Impact Rating: C



- Southerly Aspect Garden
- Four Double Bedrooms
- Balcony
- Sea Views
- Two Bathrooms
- Successful Holiday Let
- Moments To Beach
- Open Plan Ground Floor
- Cloakroom



Sitting Room

19' 9" x 12' 2" (6.03m x 3.72m)

Kitchen/Diner

21' 7" x 15' 2" (6.57m x 4.62m)

Bedroom One

15' 1" x 14' 10" (4.59m x 4.53m)

Bedroom Two

14' 10" x 12' 5" (4.52m x 3.78m)

Bedroom Three

14' 11" x 12' 0" (4.55m x 3.67m)

Bedroom Four

14' 11" x 9' 9" (4.55m x 2.97m)

Bathroom

7' 9" x 6' 4" (2.37m x 1.94m)

Shower Room

7' 9" x 6' 4" (2.37m x 1.94m)

Balcony**Cloakroom**

6' 4" x 4' 4" (1.93m x 1.31m)



Approx Gross Internal Area
146 sq m / 1576 sq ft

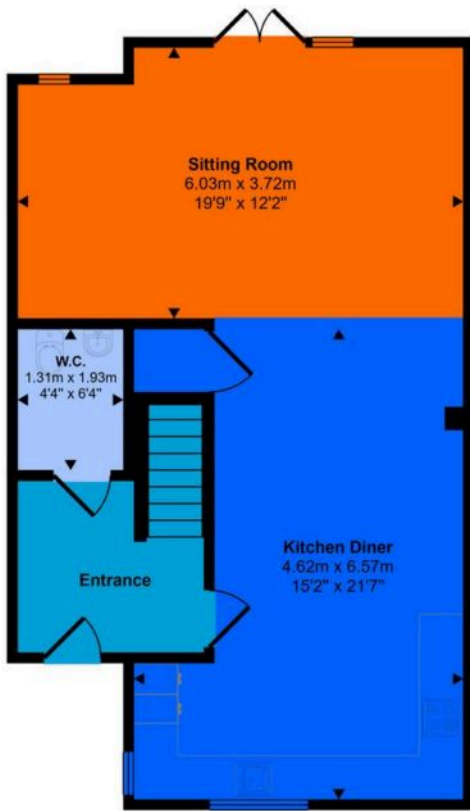

Ground Floor
Approx 60 sq m / 642 sq ft

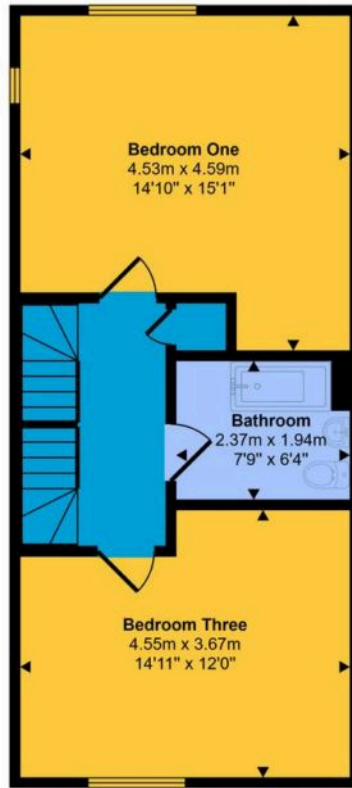

First Floor
Approx 48 sq m / 512 sq ft

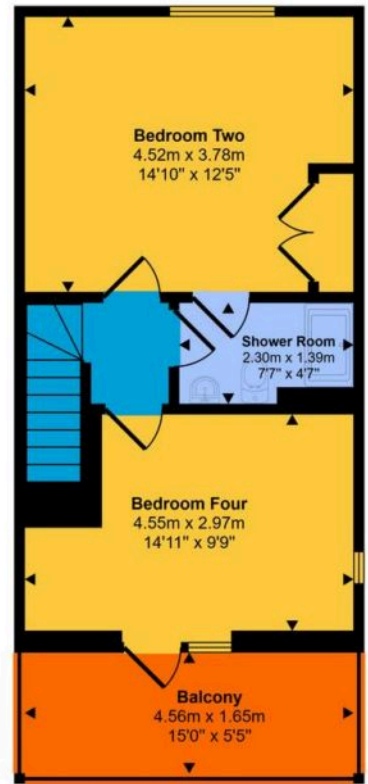

Second Floor
Approx 39 sq m / 422 sq ft

This floorplan is only for illustrative purposes and is not to scale. Measurements of rooms, doors, windows, and any items are approximate and no responsibility is taken for any error, omission or mis-statement. Icons of items such as bathroom suites are representations only and may not look like the real items. Made with Made Snappy 360.

You can include any text here. The text can be modified upon generating your brochure.