



Price

£2,250 PCM

Fees Apply



Available 24/06/24

Holmesdale Road
Reigate RH2

cubitt&west
Helping you move forwards



Main Features

- **Pets Considered**
- **Central Location**
- **Basement Area**
- **Conservatory**
- **Close to Station**
- **Suit Family**



Deposit required is £2,596.15
Reigate and Banstead District - Council Tax Band Tax Band D

Renting a property is a big commitment and we recommend that you visit the local authority website and these websites which offer helpful information and advice about letting

www.gov.uk/government/publications/how-to-rent

www.gov.uk/private-renting

www.cubittandwest.co.uk/renting/tenancy-fees-individuals/

www.gov.uk/green-deal-energy-saving-measures

Call Sutton 020 86426266 ■ **cubittandwest.co.uk**

IMPORTANT INFORMATION: Please contact our Lettings Team who will confirm the total costs involved in renting this property. For clarification, we wish to inform the prospective tenant that we have prepared these details as a general guide. The agent has not carried out a detailed survey nor tested the services, appliances, or specific fittings (unless otherwise stated), and no warranty can be given as to their condition. All room measurements are taken at floor level. We strongly recommend that all the information which we provide about the property is verified by yourself and your advisers. The contents of this publication are © Cubitt & West, 2015. Cubitt & West is a trading name of Arun Estates Limited Registered in England No. 2597969

Accommodation

Bedroom 1 3.8 x 3.8
Bedroom 2 2.88 x 2.1
Bedroom 3 3.2 x 2
Bathroom 2.5 x 1.7
Lounge 3.84 x 3.6
Kitchen Area 3.84 x 3
Dining Area 3.84 x 2.4
WC & Utility Room 2.65 x 1.2
Basement 3.7 x 3.6
Study/Storage Area 2.8 x 1.85

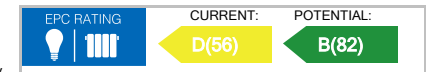

Ground Floor

Approx. 50.9 sq. metres (548.2 sq. feet)

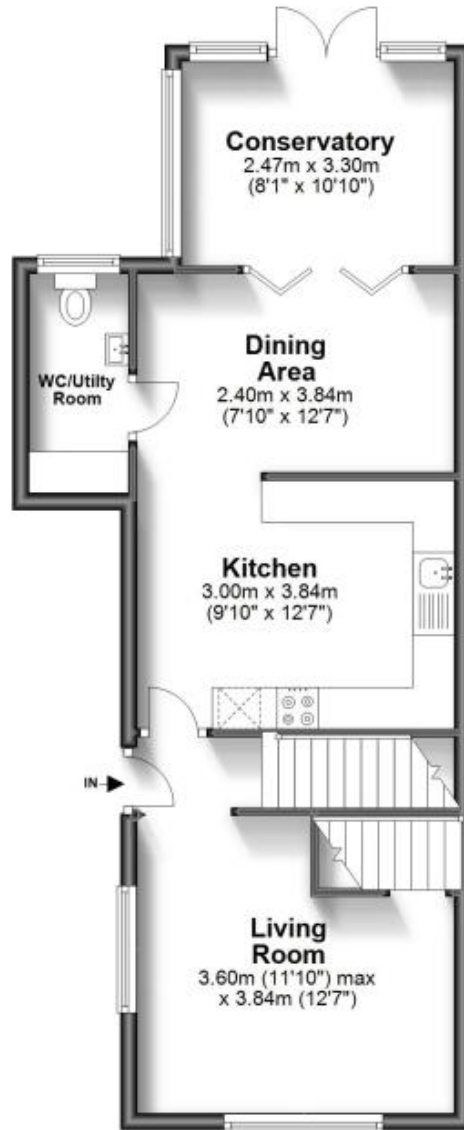

First Floor

Approx. 45.7 sq. metres (492.2 sq. feet)



Basement Level

Approx. 13.3 sq. metres (143.4 sq. feet)



First Floor

Approx. 19.3 sq. metres (208.0 sq. feet)

