



MH

METROPOLITAN HOUSE

STATION ROAD, CHEADLE HULME, **CHESHIRE SK8 7AZ**

# A METAMORPHOSIS IS UNDERWAY

**METROPOLITAN HOUSE**

---

FULLY REFURBISHED  
CONTEMPORARY OFFICE SUITES

FROM 750 SQ FT TO 3,355 SQ FT

• FULL REFURBISHMENT PROGRAMME SCHEDULED FOR COMPLETION 2018 • EXCELLENT LOCAL AMENITIES • FLEXIBLE FLOORPLATES • VALUE FOR MONEY

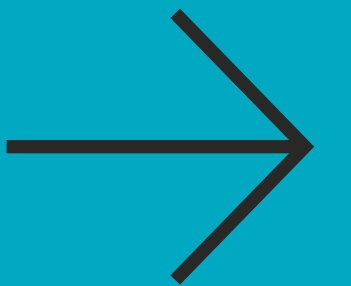





METROPOLITAN HOUSE

- HOME
- DESCRIPTION
- LOCATION
- AMENITIES
- AERIAL
- ACCOMMODATION
- AVAILABILITY
- GALLERY
- CONTACT



# A METROPOLITAN TRANSFORMATION

Metropolitan House is a prominent four storey multi-tenanted building situated in the heart of the high profile and popular Cheadle Hulme Village. The property offers suites of various sizes and is due to undergo a programme of extensive refurbishment due for completion spring 2018.

Already a significant landmark within Cheadle Hulme's landscape, Metropolitan House's contemporary new look will provide an enviable work location, with a makeover to compliment any future occupiers requirements. The transformation and flexibility of the accommodation will suit modern business needs.

AN ENVIABLE  
WORK  
LOCATION



RE-MODELLED EXTERIOR

PROPOSED NEW RECEPTION AREA







METROPOLITAN HOUSE

- HOME
- DESCRIPTION
- LOCATION
- AMENITIES
- AERIAL
- ACCOMMODATION
- AVAILABILITY
- GALLERY
- CONTACT

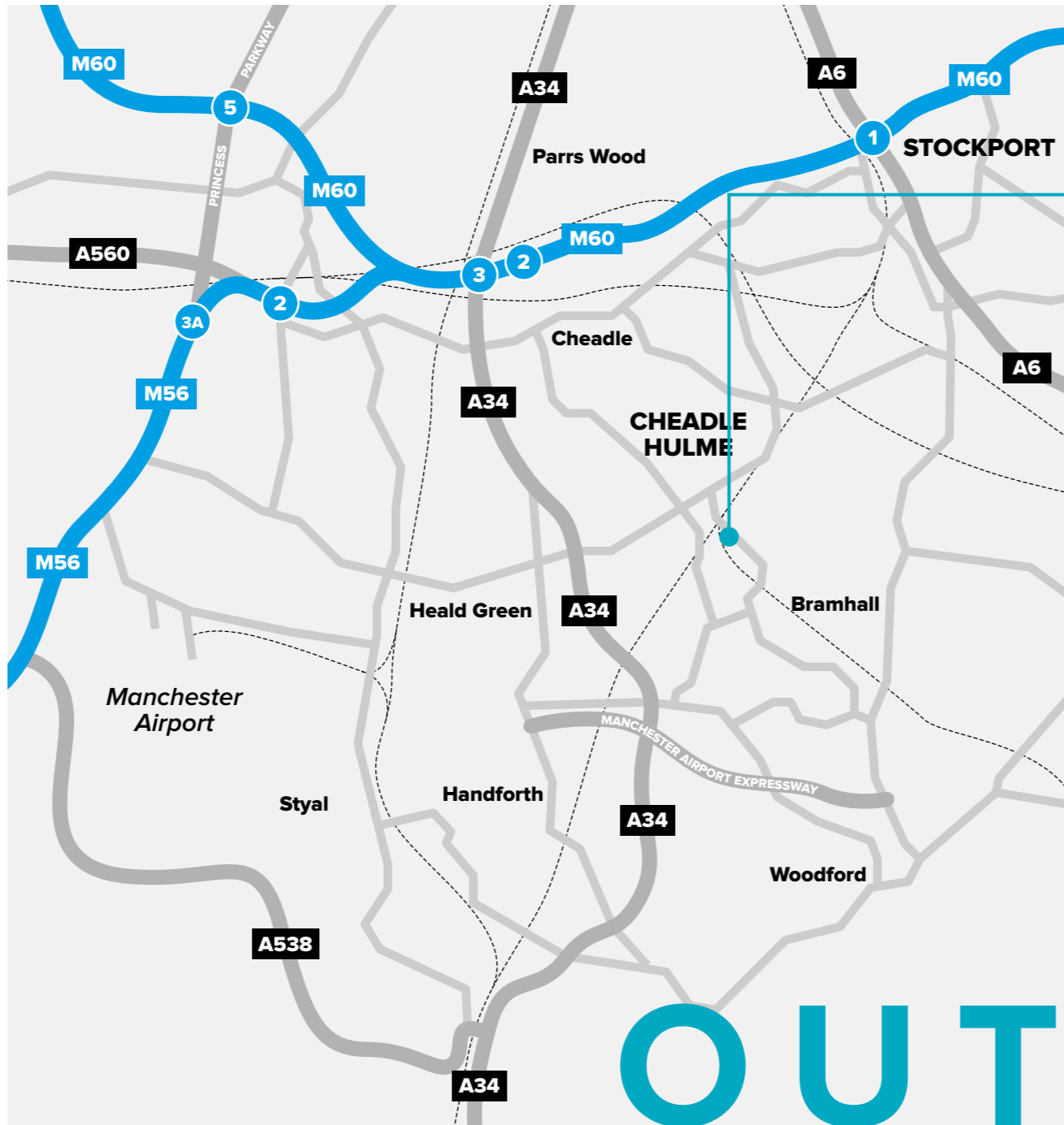

## A BUSY AND THRIVING SUBURB

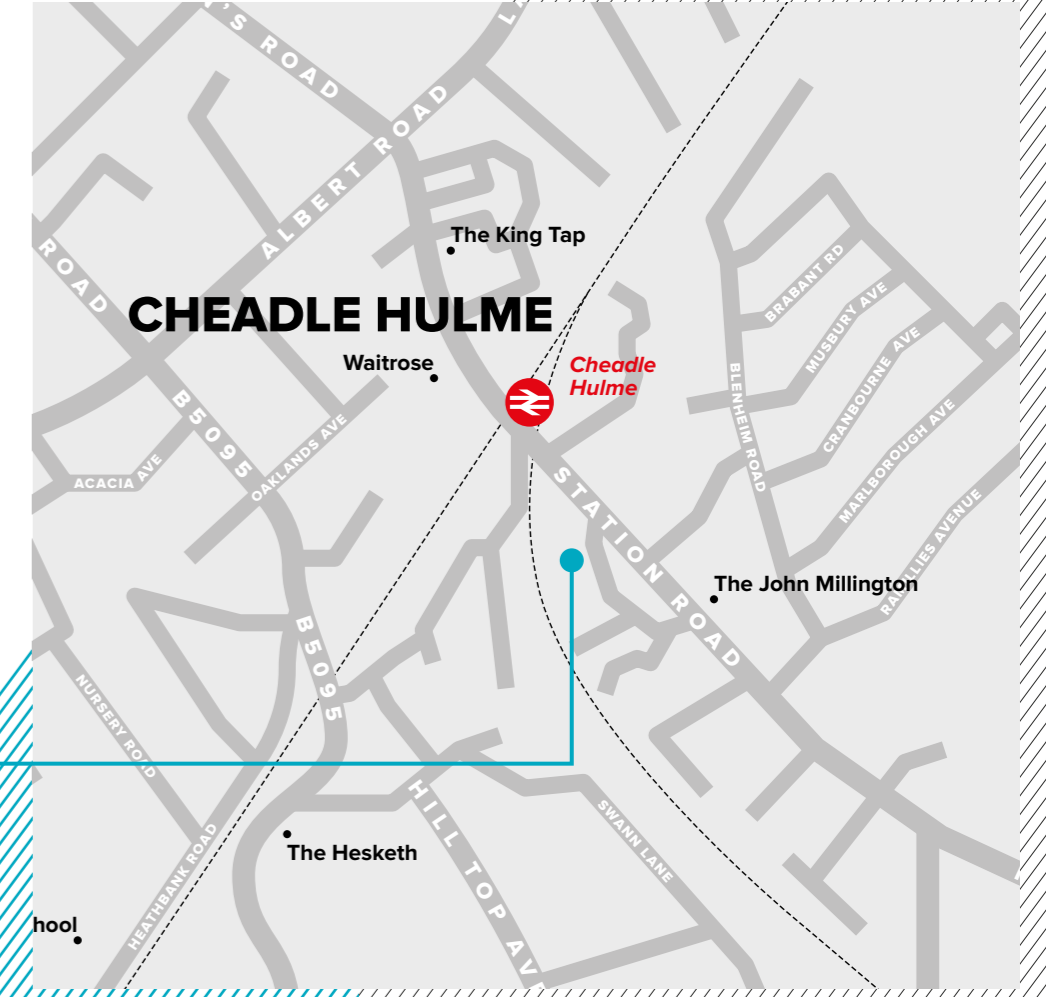

The building lies in the centre of Cheadle Hulme, Cheshire which is a busy and thriving suburb of Stockport and Manchester. Cheadle Hulme station is a short walk away with regular services to Stockport, Manchester, Stoke, Crewe and Macclesfield. In addition to rail travel Cheadle Hulme is well serviced by regular bus services.

The M56 and Manchester Airport are both a 10 minute drive away with the A34 bypass only a 5 minute drive away providing excellent links to nearby localities, the M60 motorway orbital loop and the wider regional motorway network. Manchester City centre can be found 9 miles to the north.

# OUTSTANDING LOCATION



# MM

METROPOLITAN HOUSE

- HOME
- DESCRIPTION
- LOCATION
- AMENITIES
- AERIAL
- ACCOMMODATION
- AVAILABILITY
- GALLERY
- CONTACT

# SUPERB AMENITIES

A VARIETY OF RETAIL AND LEISURE FACILITIES



Cheadle Hulme has a wide variety of amenities available with retail and leisure facilities well provided. Waitrose, Asda and Tesco Express can be found within a short walk of Metropolitan House, along with eateries, bars and coffee bars such as Gusto, Platform 5, The John Millington, Costa Coffee and Subway.

Larger retail parks can be found within a 10 minute drive at Stanley Green and Handford Dean that include B&Q, Halfords, TK Maxx, Marks & Spencer, and Sainsburys. Also within a 10 minute drive gym facilities can be found at Total Fitness and David Lloyd Leisure.





METROPOLITAN HOUSE

- HOME
- DESCRIPTION
- LOCATION
- AMENITIES
- AERIAL
- ACCOMMODATION
- AVAILABILITY
- GALLERY
- CONTACT



METROPOLITAN HOUSE

- 1 RBS
- 2 Rainbow 88 Chinese Restaurant
- 3 Subway
- 4 Asda
- 5 Costa
- 6 Pharmacy
- 7 BetFred
- 8 Whittakers fish and Chips
- 9 Kings Hall pub
- 10 La casetta Restaurant
- 11 D'Agostino Trattoria
- 12 Garam Masala
- 13 Waitrose
- 14 Istanbul Grill
- 15 Waterhouse Food Market
- 16 Chivenors Tap
- 17 Platform 5 Pub restaurant
- 18 Post Office
- 19 Pizza Hut
- 20 Station 22 Meze Bar & Grill
- 21 The Board Café Bar
- 22 Gusto
- 23 Tesco Express
- 24 SK Eight Café
- 25 The John Millington Pub
- 26 Flint's Sandwich Bar





METROPOLITAN HOUSE

- HOME
- DESCRIPTION
- LOCATION
- AMENITIES
- AERIAL
- ACCOMMODATION
- AVAILABILITY
- GALLERY
- CONTACT



# A BLANK CANVAS



Suites are available from 750 sq ft to 3,355 sq ft with an excellent car parking ratio. The property is due to undergo extensive refurbishment and the specification will include:

- LED pendant Lighting
- Comfort cooling available
- Flexible floor plates
- Perimeter trunking and Cat II lighting.
- Communal Kitchen
- Meeting rooms available on the ground floor





METROPOLITAN HOUSE

- HOME
- DESCRIPTION
- LOCATION
- AMENITIES
- AERIAL
- ACCOMMODATION
- AVAILABILITY
- GALLERY
- CONTACT

## AVAILABILITY

Ground Floor - North Wing	750 sq ft
2nd Floor - South Wing	3,355 sq ft
3rd Floor Suite 3 - North Wing	2,520 sq ft
4th Floor - South Wing	2,011 sq ft

Car parking spaces available at a ratio of 1:332 sq ft.

- Due for full refurbishment
- Fully refurbished and available for immediate occupation

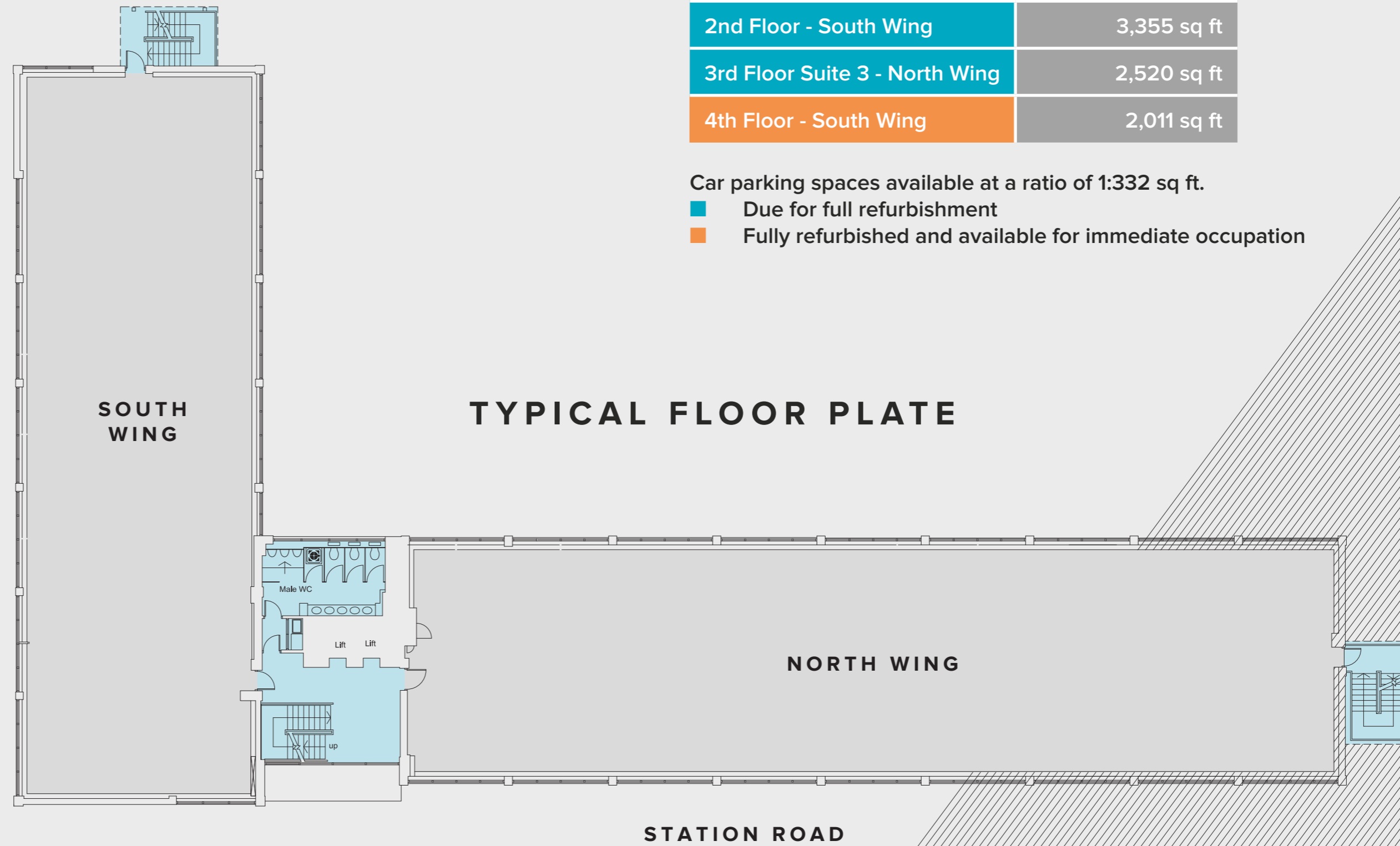

## TYPICAL FLOOR PLATE



# MM

METROPOLITAN HOUSE

[HOME](#)

[DESCRIPTION](#)

[LOCATION](#)

[AMENITIES](#)

[AERIAL](#)

[ACCOMMODATION](#)

[AVAILABILITY](#)

[GALLERY](#)

[CONTACT](#)







METROPOLITAN HOUSE

- HOME
- DESCRIPTION
- LOCATION
- AMENITIES
- AERIAL
- ACCOMMODATION
- AVAILABILITY
- GALLERY
- CONTACT







METROPOLITAN HOUSE

- [HOME](#)
- [DESCRIPTION](#)
- [LOCATION](#)
- [AMENITIES](#)
- [AERIAL](#)
- [ACCOMMODATION](#)
- [AVAILABILITY](#)
- [GALLERY](#)
- [CONTACT](#)







METROPOLITAN HOUSE

- [HOME](#)
- [DESCRIPTION](#)
- [LOCATION](#)
- [AMENITIES](#)
- [AERIAL](#)
- [ACCOMMODATION](#)
- [AVAILABILITY](#)
- [GALLERY](#)
- [CONTACT](#)







METROPOLITAN HOUSE

- [HOME](#)
- [DESCRIPTION](#)
- [LOCATION](#)
- [AMENITIES](#)
- [AERIAL](#)
- [ACCOMMODATION](#)
- [AVAILABILITY](#)
- [GALLERY](#)
- [CONTACT](#)







METROPOLITAN HOUSE

- HOME
- DESCRIPTION
- LOCATION
- AMENITIES
- AERIAL
- ACCOMMODATION
- AVAILABILITY
- GALLERY
- CONTACT







METROPOLITAN HOUSE

- HOME
- DESCRIPTION
- LOCATION
- AMENITIES
- AERIAL
- ACCOMMODATION
- AVAILABILITY
- GALLERY
- CONTACT







METROPOLITAN HOUSE

- HOME
- DESCRIPTION
- LOCATION
- AMENITIES
- AERIAL
- ACCOMMODATION
- AVAILABILITY
- GALLERY
- CONTACT







METROPOLITAN HOUSE

- HOME
- DESCRIPTION
- LOCATION
- AMENITIES
- AERIAL
- ACCOMMODATION
- AVAILABILITY
- GALLERY
- CONTACT







METROPOLITAN HOUSE

- HOME
- DESCRIPTION
- LOCATION
- AMENITIES
- AERIAL
- ACCOMMODATION
- AVAILABILITY
- GALLERY
- CONTACT







METROPOLITAN HOUSE

- HOME
- DESCRIPTION
- LOCATION
- AMENITIES
- AERIAL
- ACCOMMODATION
- AVAILABILITY
- GALLERY
- CONTACT

# CONTACT

Viewing arrangements - contact either of the joint letting agents.

Michael Blackshaw  
MBRE  
E: [mb@mbre.space](mailto:mb@mbre.space)  
T: 0161 850 1111

Charlie Williams  
Williams Sillitoe  
E: [cw@williamscomm.co.uk](mailto:cw@williamscomm.co.uk)  
T: 01625 800 066

James Dickinson  
Canning O'Neil  
E: [james@canningoneill.com](mailto:james@canningoneill.com)  
T: 0161 244 5500

**MBRE**  
0161 850 1111  
[www.mbre.space](http://www.mbre.space)

**Williams Sillitoe**  
01625 800 066  
[willsill.co.uk](http://willsill.co.uk)

**CANNING O'NEILL**  
[canningoneill.com](http://canningoneill.com)  
0161 244 5500

Misrepresentation Act 1967. Unfair Contract Terms Act 1977 The Property Misdescriptions Act 1991. These particulars are issued without any responsibility on the part of the agent and are not to be construed as containing any representation or fact upon which any person is entitled to rely. Neither the agent nor any person in their employ has any authority to make or give any representation or warranty whatsoever in relation to the property. July 2018. RB&Co 0161 833 0555. [www.richardbarber.co.uk](http://www.richardbarber.co.uk)