

Streamlight Tower, E14

£575,000

A two bedroom apartment in a modern development. This bright apartment has an open plan reception room, floor to ceiling windows and a full length dock facing balcony with stunning City views.

Streamlight Tower is moments from the Poplar Dock Marina and within easy reach of the shops, bars, restaurants of Canary Wharf.

Features

- Two Bedrooms
- Two Bathrooms
- Full Length Private Balcony
- Amazing City Views
- Concierge

Province Square, London, E14

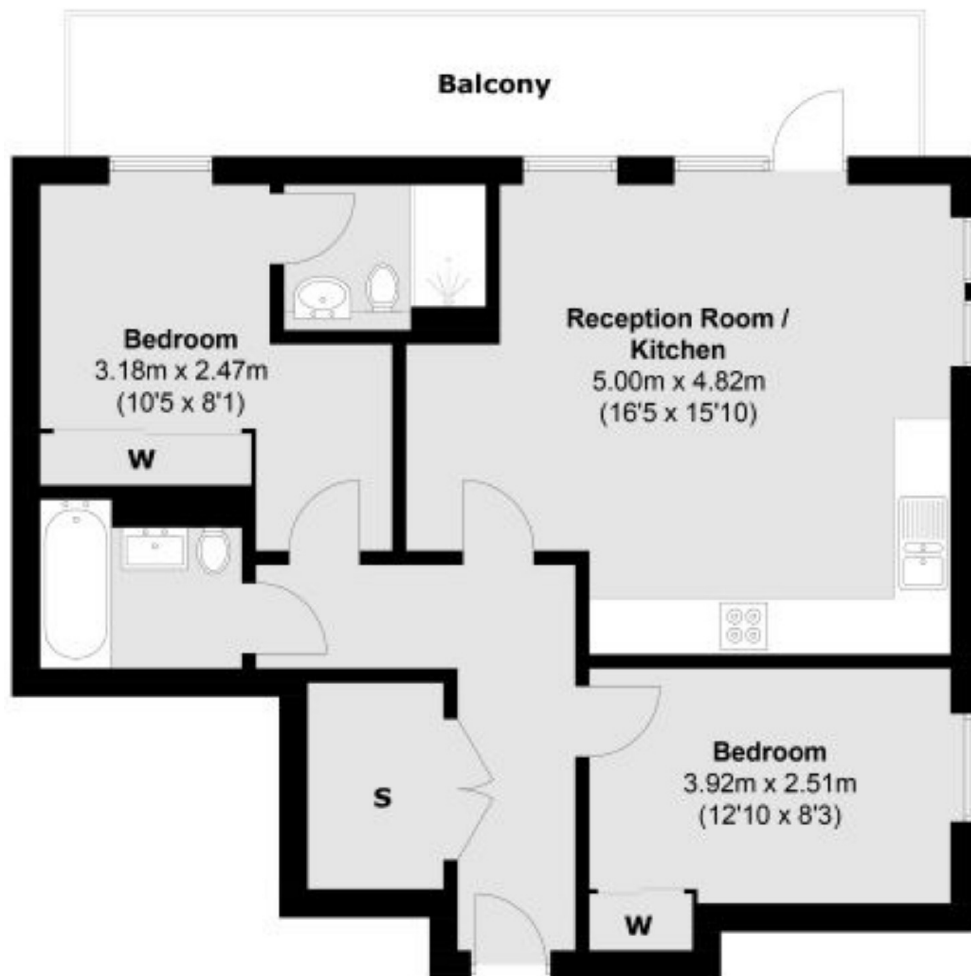

Total area (approx.): 69.2 sq. m (744.8 sq. ft)
Balcony : 13.6 sq. m (146.4 sq. ft)

Contact

To arrange a viewing call our office on the number below or visit our website.



Energy Rating: C. We aim to make our particulars both accurate and reliable. However they are not guaranteed; nor do they form part of an offer or contract. If you require clarification on any points then please contact us, especially if you're traveling some distance to view. Please note that appliances and heating systems have not been tested and therefore no warranties can be given as to their good working order.