



## Hutchings Street, E14

### £300,000

A well-presented one-bedroom apartment located in the sought-after Seacon Wharf development, offered to the market on a chain-free basis. Key features include allocated parking, a concierge service, residents' leisure facilities, a private balcony and a lease of over 900 years.

Ideally located for Canary Wharf, offering easy access to a wide range of shops, supermarkets, restaurants and bars. With the DLR, Jubilee Line and Elizabeth Line stations close by, residents benefit from excellent transport links and swift connections across London.

### Features

- 490 Square Feet
- Private Balcony
- 900 Plus Year Lease
- Concierge Service
- Residents Leisure Facilities
- Gated Development

# Hutchings Street, London, E14

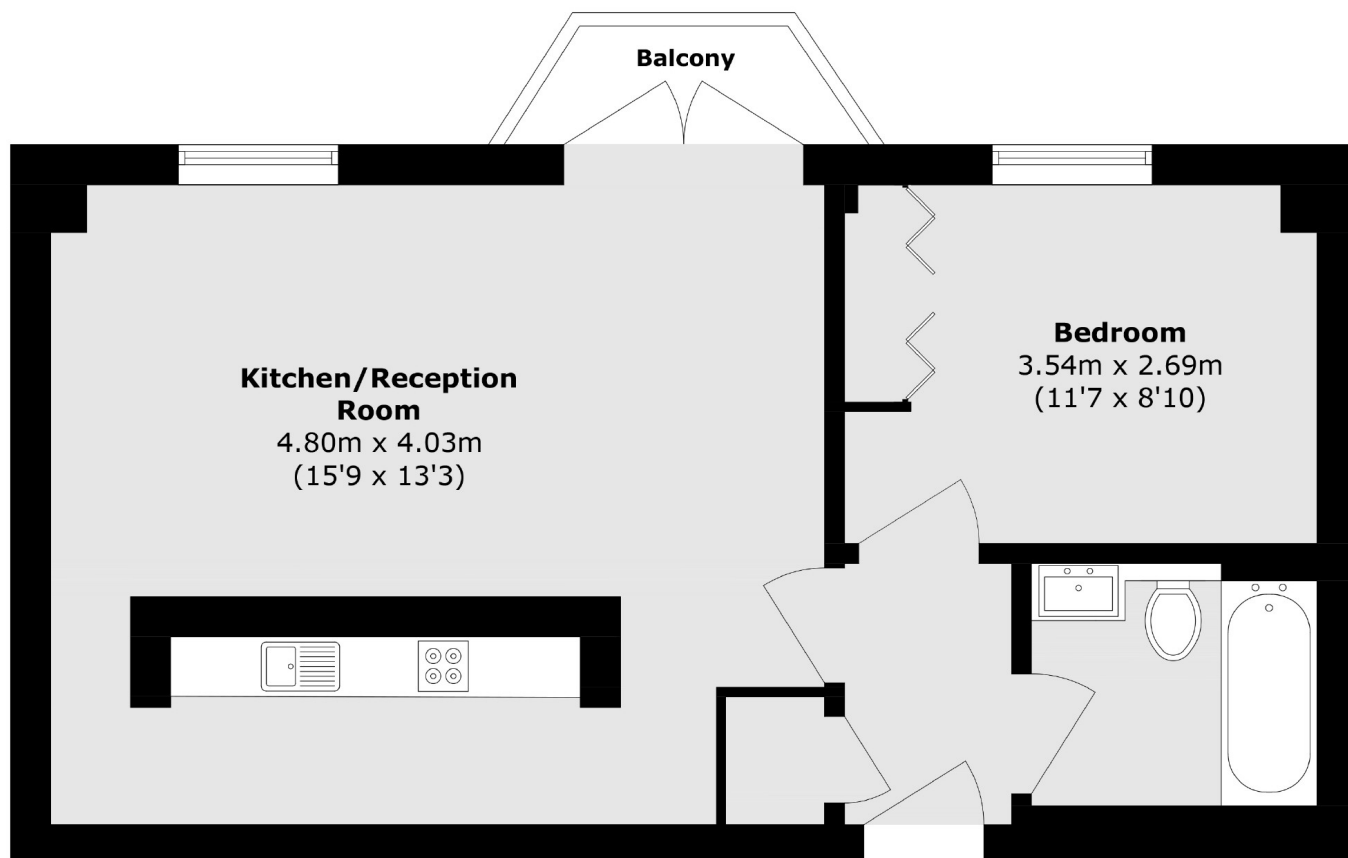

Total area (approx.): 45.5 sq. m (489.7 sq. ft)

Balcony area (approx.): 1.9 sq. m (20.4 sq. ft)