



Crossharbour Plaza, E14

£530,000

Welcome to this charming one-bedroom apartment located in the highly sought-after Arena Tower development. This well-presented property boasts a generous 166 sq ft private balcony overlooking the dock, perfect for relaxing or entertaining. Residents benefit from concierge services, access to exclusive on-site facilities, and the property is offered chain-free, ensuring a smooth and straightforward purchase.

Arena Tower is conveniently located just 0.1 miles from Crossharbour DLR Station, providing excellent transport links across the City and beyond.

Features

- 166 Square Feet Balcony
- Dock Facing
- Resident Facilities
- Concierge Service
- Modern Throughout
- Chain Free

Crossharbour Plaza, London, E14

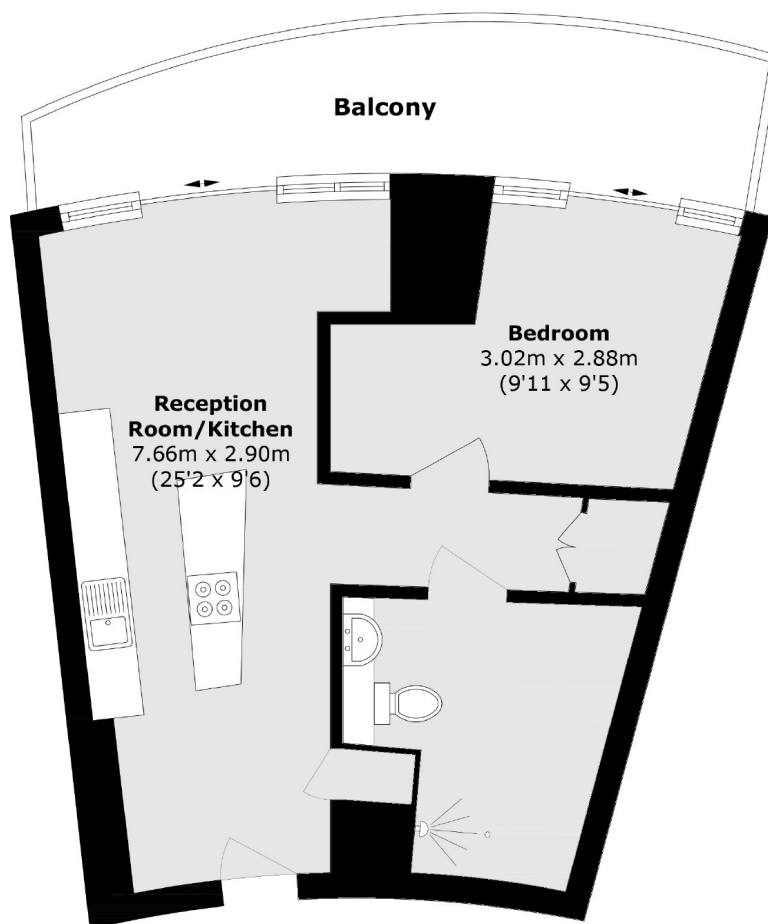

Total area (approx.): 52.0 sq. m (559.7 sq. ft)
Balcony area (approx.): 15.5 sq. m (166.8 sq. ft)