



South Quay Square, E14

£480,000

Offered to the market with no onward chain is this spacious one-bedroom property located in the heart of Canary Wharf. The property includes a concierge service, residents' facilities, and it is just a short walk from South Quay DLR station.

South Quay Square is located just 0.2 miles from South Quay DLR station.

Features

- Large One Bedroom
- Open Planned Reception
- Chain Free
- Concierge Service
- Resident Facilities
- Moments From Station

South Quay Square, London, E14

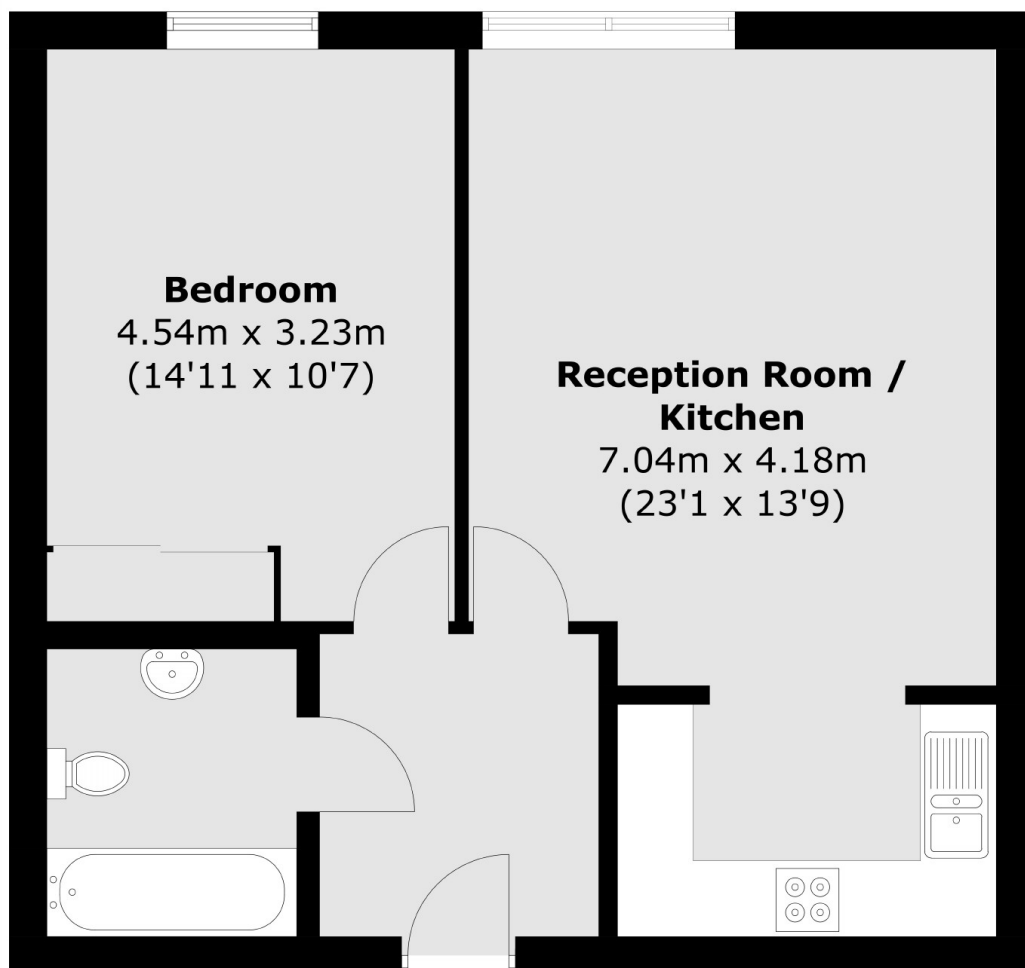

Total area (approx.): 53.0 sq. m (570.5 sq. ft)

Dexters

Canary Wharf
39 Westferry Road
London
E14 8JH
Sales
020 7517 1199

Energy Rating: C. We aim to make our particulars both accurate and reliable. However they are not guaranteed; nor do they form part of an offer or contract. If you require clarification on any points then please contact us, especially if you're traveling some distance to view. Please note that appliances and heating systems have not been tested and therefore no warranties can be given as to their good working order.

 **RICS** | Regulated
Estate Agent
and Letting Agent

[dexters.co.uk](https://www.dexters.co.uk)