



## Prestons Road, E14

### £350,000

Offered to the market on a chain free basis is this charming home. The property includes a large private balcony with views of Canary Wharf and a concierge service.

Wharfside Point has great transport links being under three quarters of a mile from Canary Wharf and there are three DLR stations within a third of a mile away.

### Features

- Private Balcony
- Communal Roof Terrace
- Concierge Service
- Views Of Canary Wharf
- Chain Free
- Two Double Bedrooms

# Prestons Road, London, E14

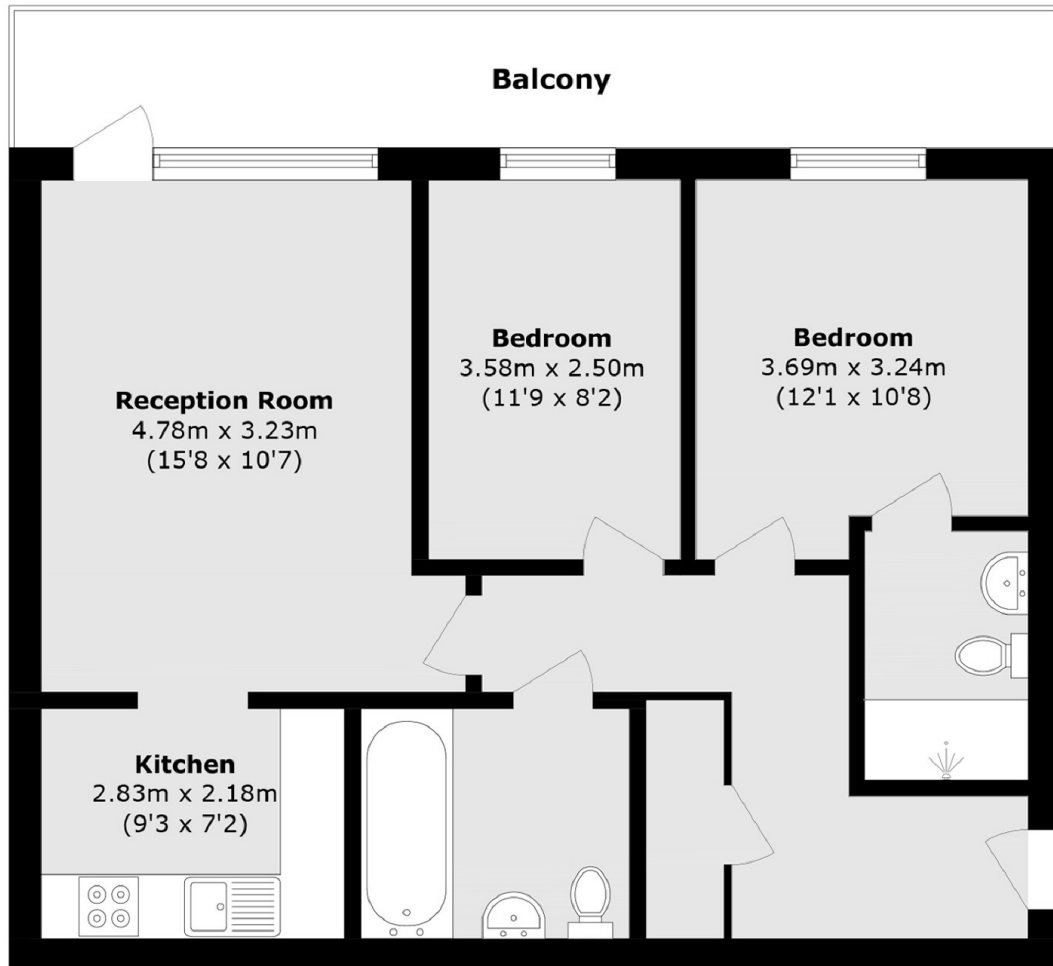

Total area (approx.): 65.1 sq. m (700.7 sq. ft)

Balcony area (approx.): 12.4 sq. m (133.4 sq. ft)