



## Millharbour, E14

### £350,000

A spacious one-bedroom apartment located within the Millharbour development. The property features an open-plan reception room and benefits from easy access to the city.

Millharbour is located just 0.8 miles from Canary Wharf and 0.2 miles from South Quay DLR Station, both offering excellent transport links to the City.

### Features

By Millharbour Dockside  
579 Square Feet  
Walking Distance To Canary Wharf  
Dual Aspect Reception  
Chain Free

# Millharbour, London, E14

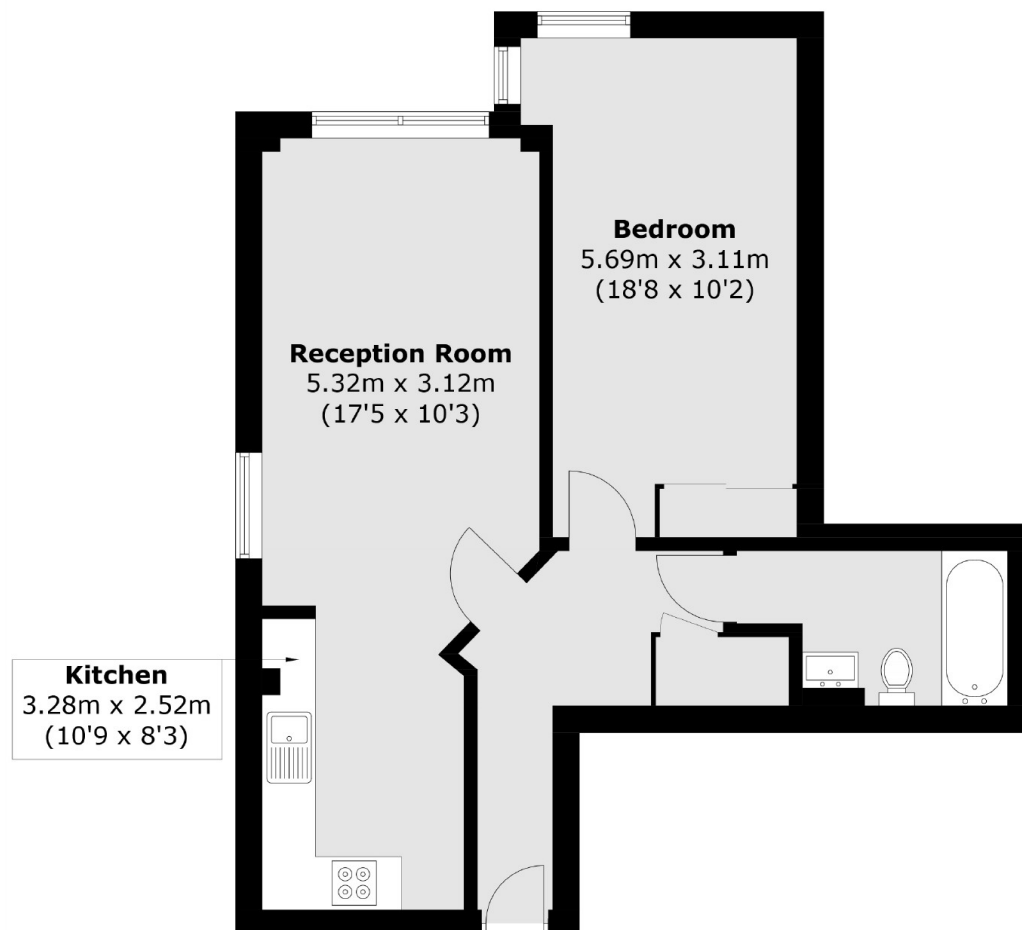

Total area (approx.): 53.8 sq. m (579.1 sq. ft)

## Dexters

Canary Wharf  
39 Westferry Road  
London  
E14 8JH  
Sales  
020 7517 1199

Energy Rating: B. We aim to make our particulars both accurate and reliable. However they are not guaranteed; nor do they form part of an offer or contract. If you require clarification on any points then please contact us, especially if you're traveling some distance to view. Please note that appliances and heating systems have not been tested and therefore no warranties can be given as to their good working order.

 **RICS** | Regulated  
Estate Agent  
and Letting Agent

[dexters.co.uk](https://www.dexters.co.uk)