

St. Davids Square, E14

£669 Per week

A bright and spacious modern two bedroom, two bathroom apartment, located in this popular residential development. This apartment has an open plan reception, private balcony with amazing views and a parking space.

St. Davids Square is a private development moments from the The Docklands Sailing Centre and the amenities of Canary Wharf.

Features

Two Bedroom
Two Bathroom
Top Floor
River views
Furnished
Parking

St. Davids Square, London, E14

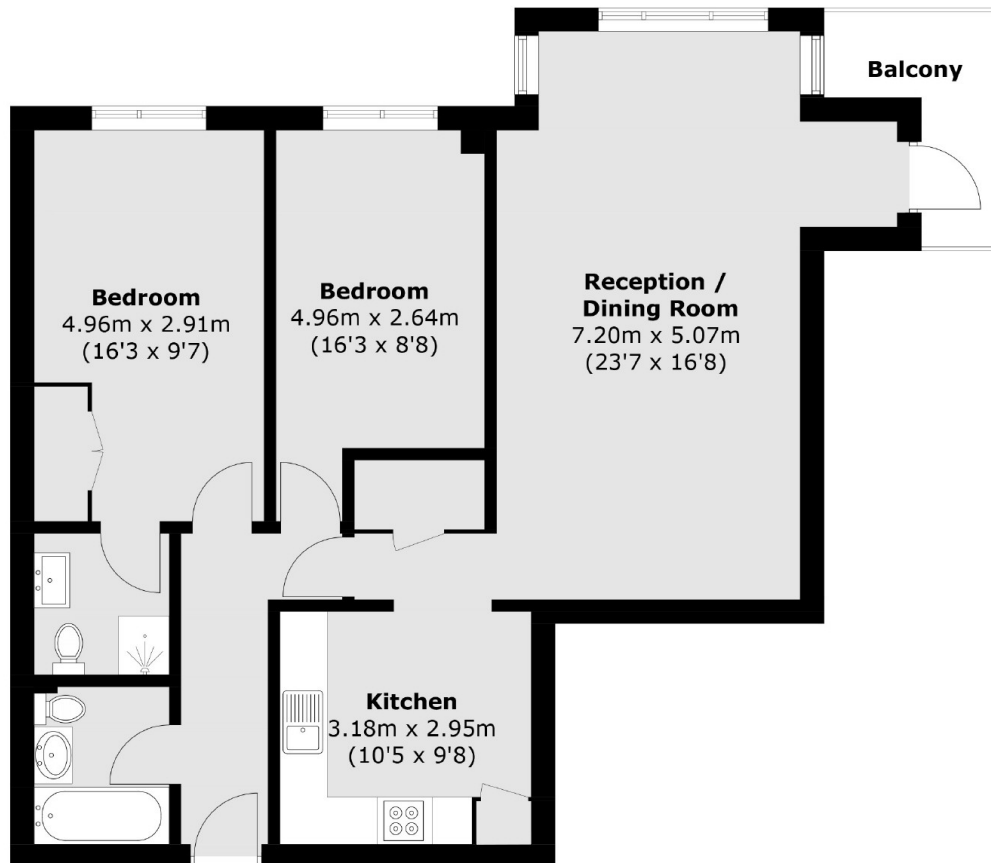

Total area (approx.): 83.2 sq. m (895.5 sq. ft)
Balcony : 4.2 sq. m (45.2 sq. ft)