



## Southern Road, E13

### £280,000

This stunning one-bedroom property with off-street parking and an allocated garage offers an exceptional living space of over 500 square feet. Boasting a sleek and modern design, the property has been beautifully maintained and offers a bright and inviting atmosphere throughout. Additional features include a large communal garden, and wooden flooring throughout.

Plaistow Station, which is on the District and Hammersmith & City lines, is just 0.6 miles from Southern Road, offering excellent links to the City and Canary Wharf.

### Features

- 514 Square Feet
- Allocated Garage
- Large Communal Garden
- Wooden Flooring Throughout
- Low Service Charge
- Well Presented

# Southern Road, London, E13

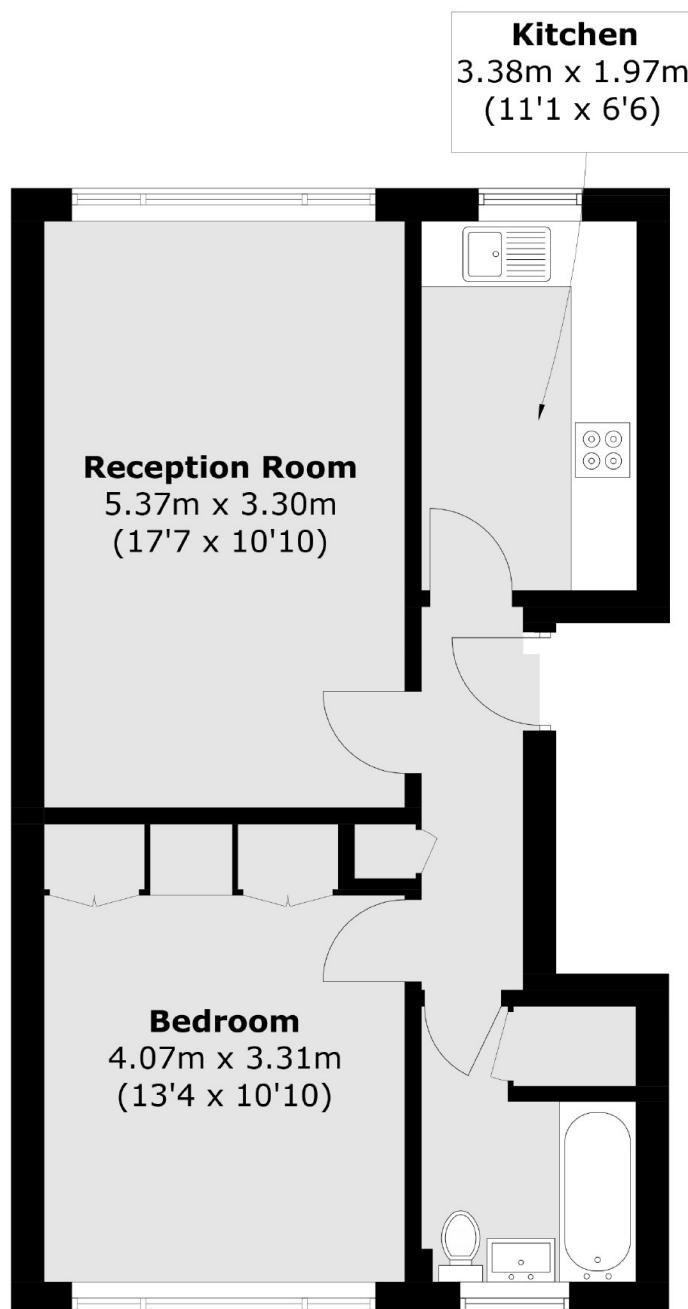

Total area (approx.): 48.7 sq. m ( 524.2sq. ft)