



## Barry Blandford Way, E3

### £600,000

Welcome to this beautifully designed, modern three-bedroom, two-bathroom home, ideally located just a short walk from the station, offering both convenience and style.

Barry Blandford Way is just a short walk from Devons Road DLR Station, providing easy access to Canary Wharf, Westfield Stratford City and central London. It also offers a range of local amenities.

### Features

- Three Double Bedrooms
- Private Balcony
- 924 Square Feet
- Allocated Parking
- Views Of The City
- Seventh Floor





**Barry Blandford Way, E3**





# Barry Blandford Way, London, E3

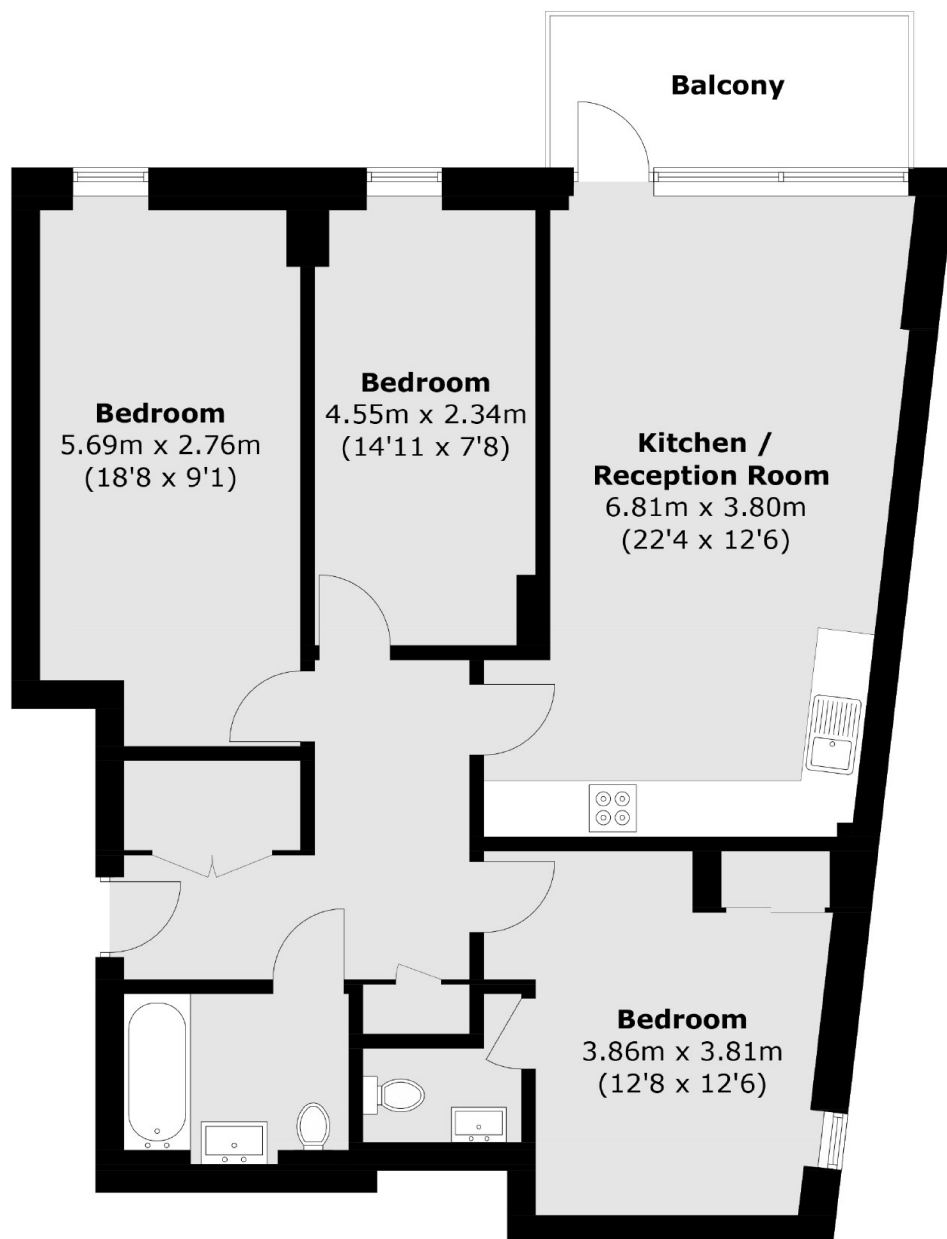

Total area (approx.): 85.9 sq. m (924.6 sq. ft)  
Balcony: 4.8 sq. m (51.7 sq. ft)

## Dexters

Canary Wharf  
39 Westferry Road  
London  
E14 8JH  
Sales  
020 7517 1199

Energy Rating: B. We aim to make our particulars both accurate and reliable. However they are not guaranteed; nor do they form part of an offer or contract. If you require clarification on any points then please contact us, especially if you're traveling some distance to view. Please note that appliances and heating systems have not been tested and therefore no warranties can be given as to their good working order.

 **RICS** | Regulated  
Estate Agent  
and Letting Agent

[dexters.co.uk](https://www.dexters.co.uk)