



Rathbone Market, E16

£310,000

A well presented one bedroom, one bathroom modern apartment in Rathbone Market set on the third floor of a modern purpose built apartment block. Features include wooden flooring throughout, modern open plan kitchen & bathroom and private balcony.

Located a short 3 minute walk from Canning Town Tube Station (Zone 2), you have the Jubilee Line & DLR which will get you to Canary Wharf in 4 minutes and London Bridge in 10 minutes. Royal Victoria Docks is also a short stroll and easy access to the new Elizabeth line. The complex is also surrounded by amenities, shops, restaurants, library, gym.

Features

Third Floor
24 hour security on site.
Private Balcony
Lockable Bike storage.
Car parking spaces are available to rent.
5th Floor Roof Garden.

Rathbone Market, London, E16

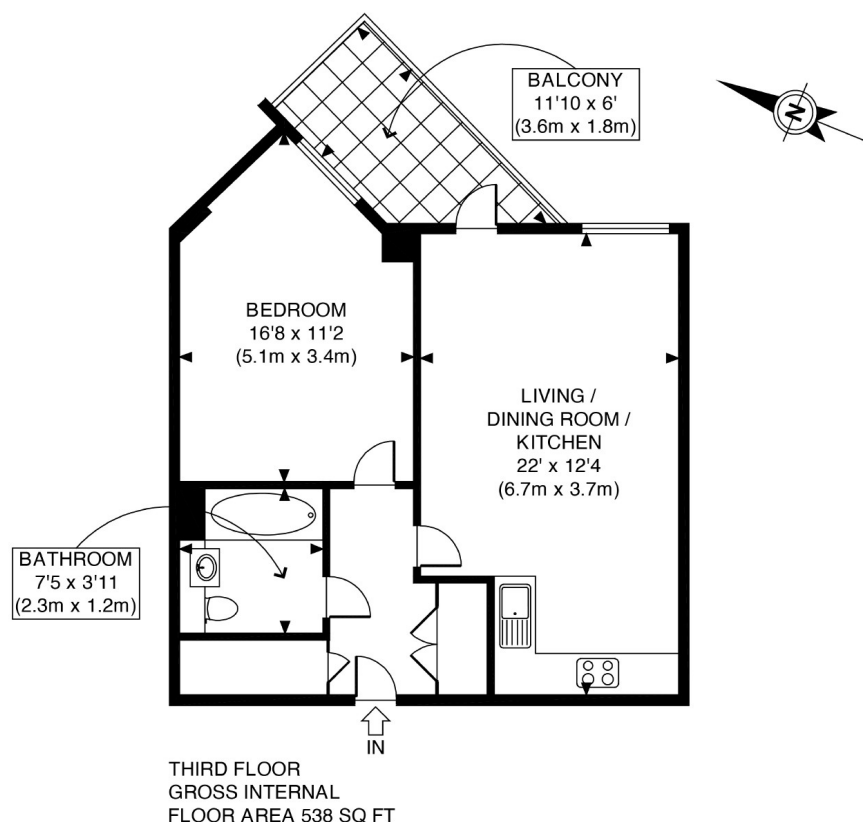

APPROX. GROSS INTERNAL FLOOR AREA 538 SQ FT / 50 SQ M
Ref: OSNHHRL - 140621 Copyright **photoplan**

Disclaimer: Floor plan measurements are approximate and are for illustrative purposes only. While we do not doubt the floor plan accuracy and completeness, you or your advisors should conduct a careful, independent investigation of the property in respect of monetary valuation