



## Milligan Street, E14

£623 Per week

A modern three bedroom house set within this quiet cul-de-sac. Arranged over two levels, this house has a large separate kitchen, two bathrooms, wooden flooring, a private garden and allocated parking.

Milligan Street is within walking distance of the shops, bars and restaurants of Canary Wharf including the Elizabeth, Jubilee and DLR lines into Central London.

### Features

- Three Bedrooms
- Two Bathrooms
- Guest W/C
- Terraced House
- Wooden Flooring
- Private Garden

# Milligan Street, London, E14

## Ground Floor

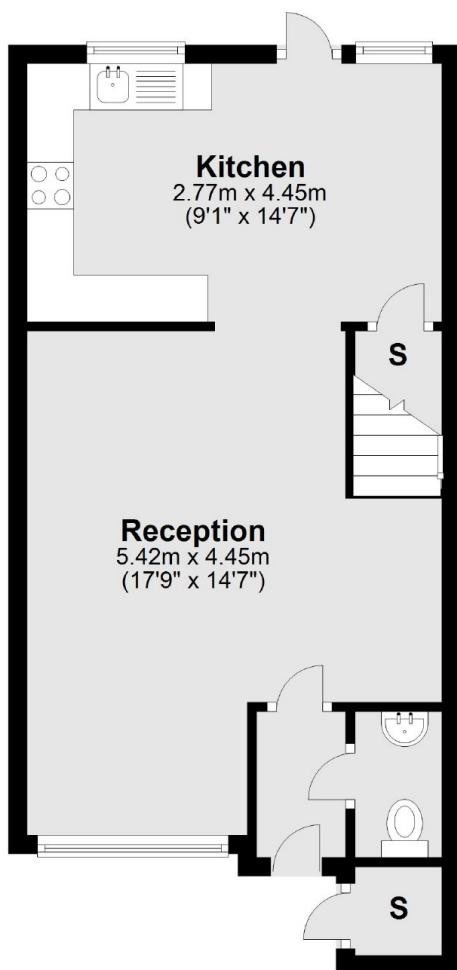

## First Floor

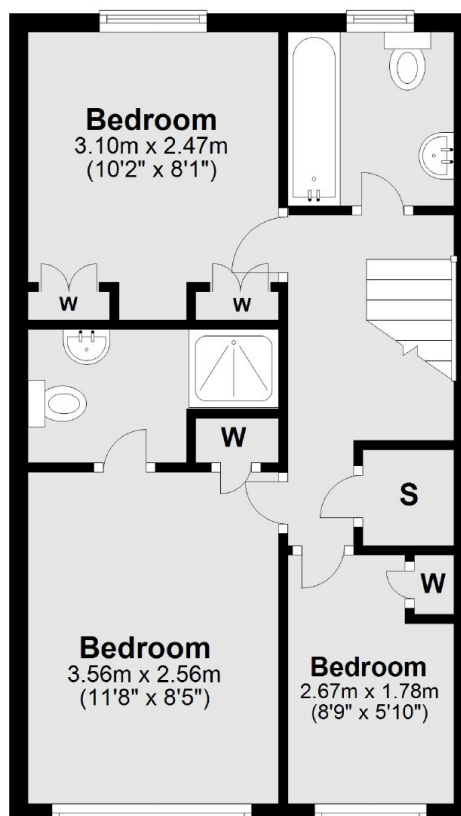

Total area: approx. 74.8 sq. metres (804.8 sq. feet)