

Botanic Square, E14

£773 Per week

A unique two bedroom penthouse on the eleventh floor of this dockside development. This split level apartment has been finished to a high specification with wooden flooring and floor to ceiling windows.

London City Island is a modern development within walking distance of the shops, bars and restaurants of Canning Town and Canary Wharf.

Features

- Two Bedrooms
- Two Bathrooms
- River Views
- Roof Terrace
- Concierge
- Gym and Leisure Facilities

Botanic Square, London, E14

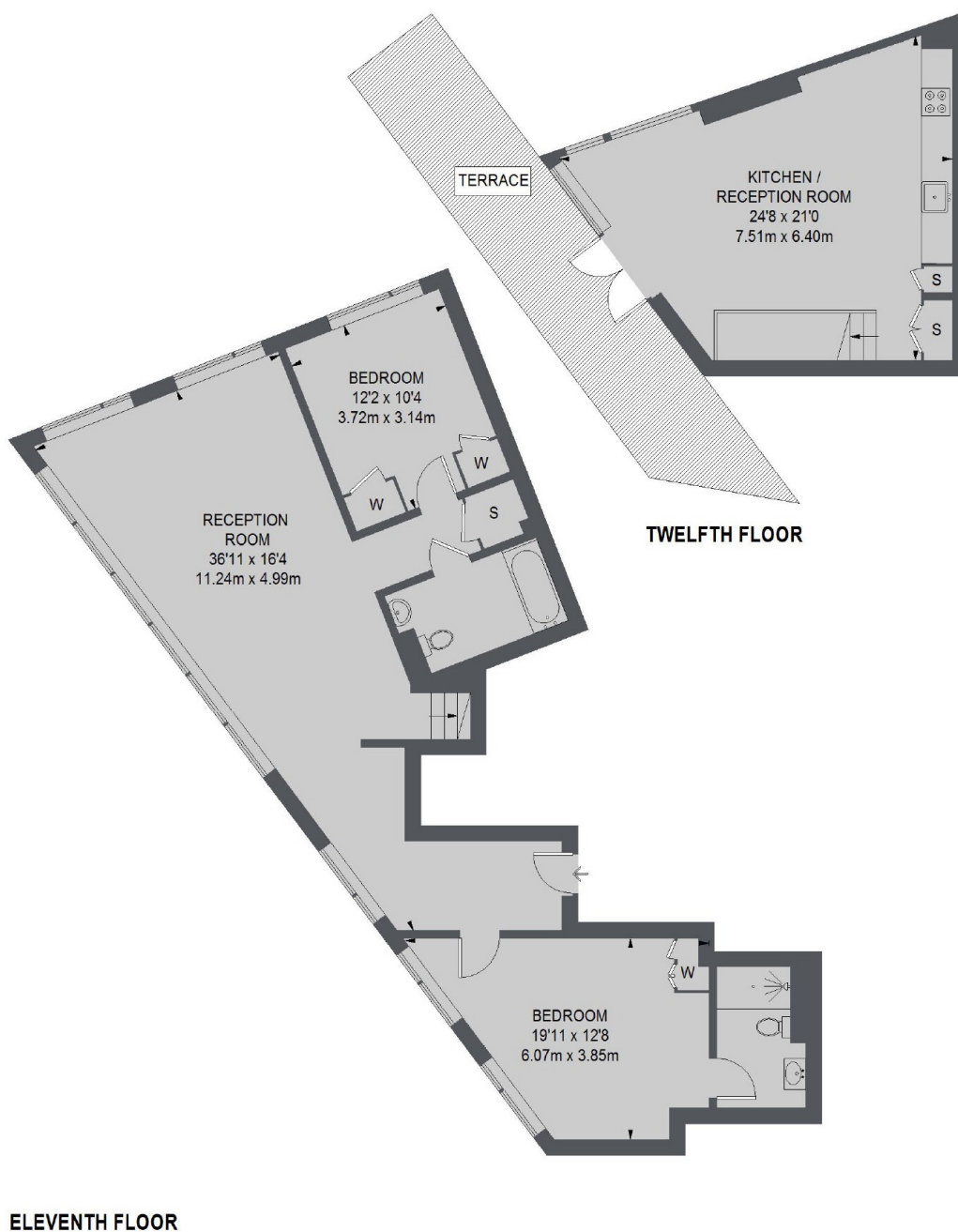

TOTAL APPROX. FLOOR AREA 1282 SQ. FT. (119.1 SQ. M.)