



Manchester Road, E14

£323 Per week

A two bedroom apartment on the first floor of this quiet, residential development. This bright apartment has a separate kitchen, refurbished bathroom, private balcony and off-street parking.

This gated development is within walking distance of the The Docklands Sailing Centre. The shops, bars and restaurants of Canary Wharf are also close by.

Features

- Two Bedrooms
- One Bathroom
- First Floor
- Ample Storage
- Off-Street Parking
- Balcony

Manchester Road,
London, E14

Second Floor

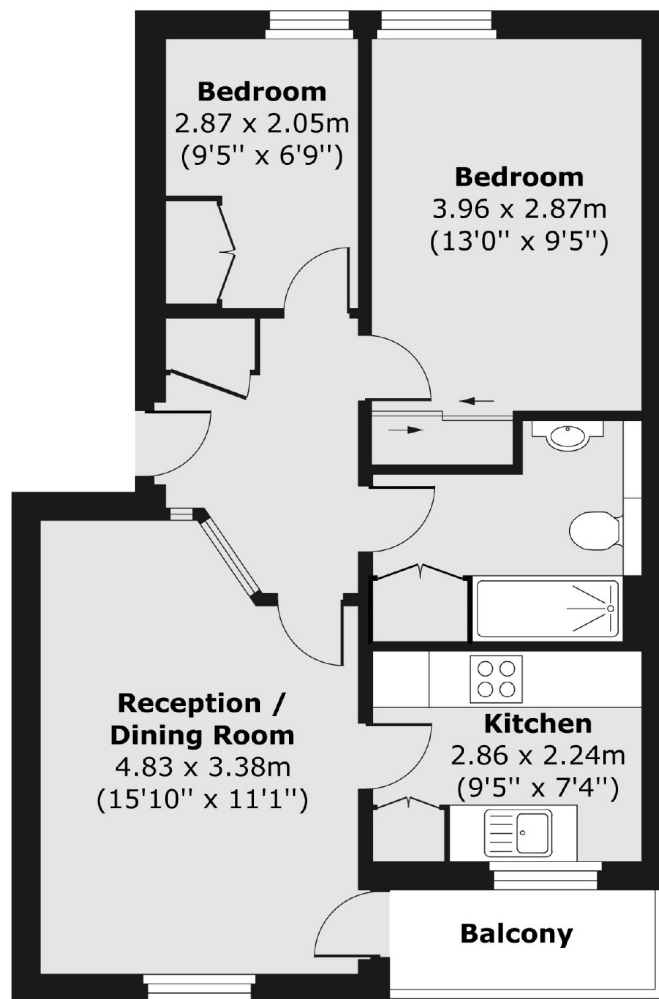

Total area (approx.) 53.40 sq. m (575 sq. ft)

Balcony area (approx.) 2.99 sq. m (32 sq. ft)

Contact

To arrange a viewing call our office on the number below or visit our website.



Energy Rating: . We aim to make our particulars both accurate and reliable. However they are not guaranteed; nor do they form part of an offer or contract. If you require clarification on any points then please contact us, especially if you're traveling some distance to view. Please note that appliances and heating systems have not been tested and therefore no warranties can be given as to their good working order.