



Crossharbour Plaza, E14

£519 Per week

A one bedroom apartment on the thirteenth floor of the popular Arena Tower. With an open plan reception, built in storage and private balcony. The property comes with 24hr concierge and gym facilities.

Arena Tower is moments from South Quay DLR and a short walk from Canary Wharf shopping centre where there are restaurants, high end retail and also where the Jubilee line runs through.

Features

- One Bedroom
- Thirteenth Floor
- Open Plan Reception
- Private Balcony
- 24hr Concierge
- Gym and Leisure Facilities

Crossharbour Plaza, London, E14

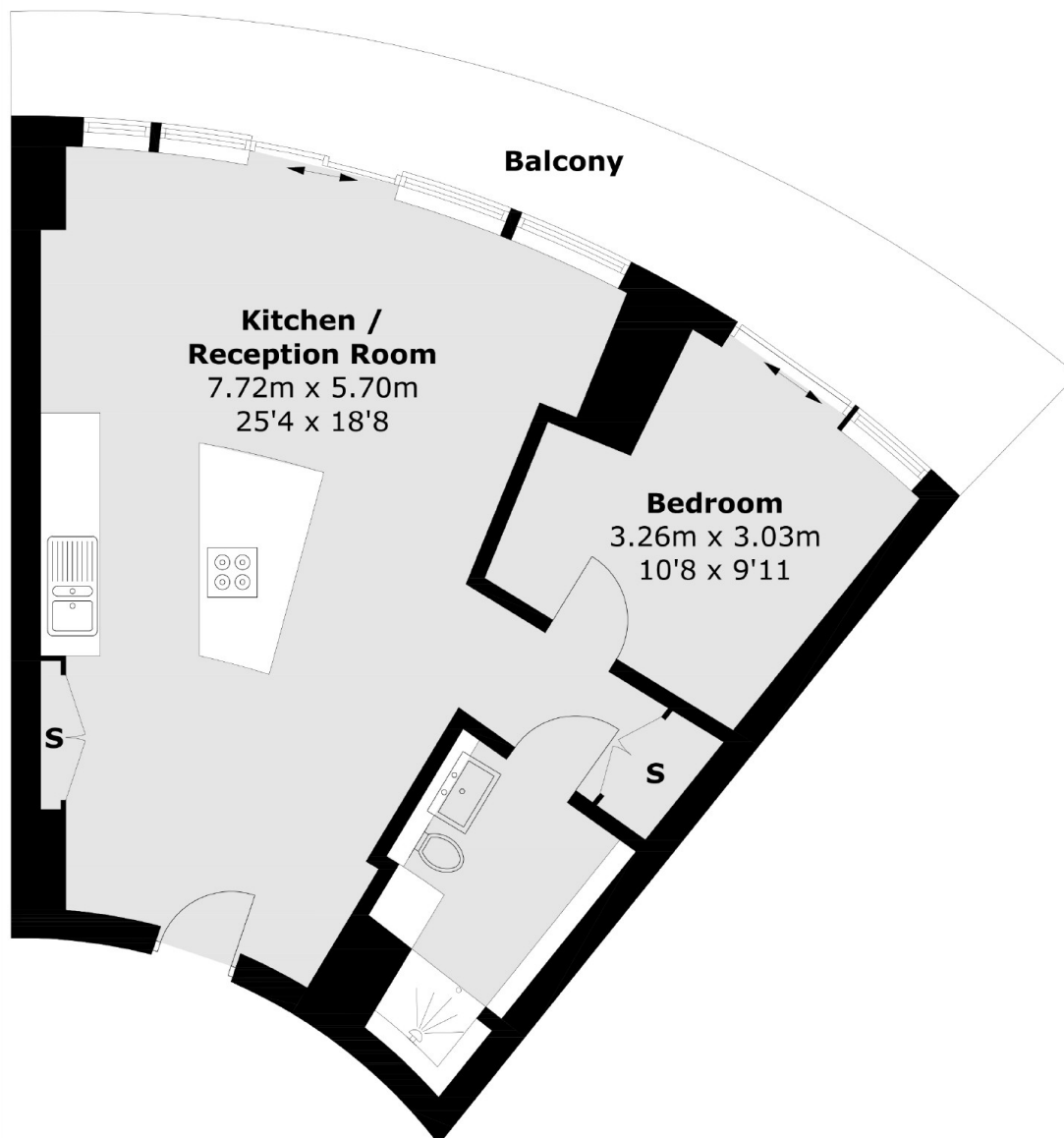

Thirteenth Floor

Total area (approx.): 55.6 sq. m (598.4 sq. ft)
Balcony: 14.7 sq. m (158.2 sq. ft)