



## Thunderer Street, E13

£600 Per week

A three bedroom apartment over 1300 sq ft on Thunderer Street. This beautiful apartment has three double bedrooms, two bathrooms, modern kitchen with integrated appliances, private patio and parking.

Thunderer Street is close to Upton Park station and is situated perfectly for a family or professionals with easy access to the City and Canary Wharf.

### Features

- Three Double Bedrooms
- Two Bathrooms
- Open Plan Reception
- Parking
- Concierge
- Residents Gym

# Thunderer Street, London, E13

## Ground Floor

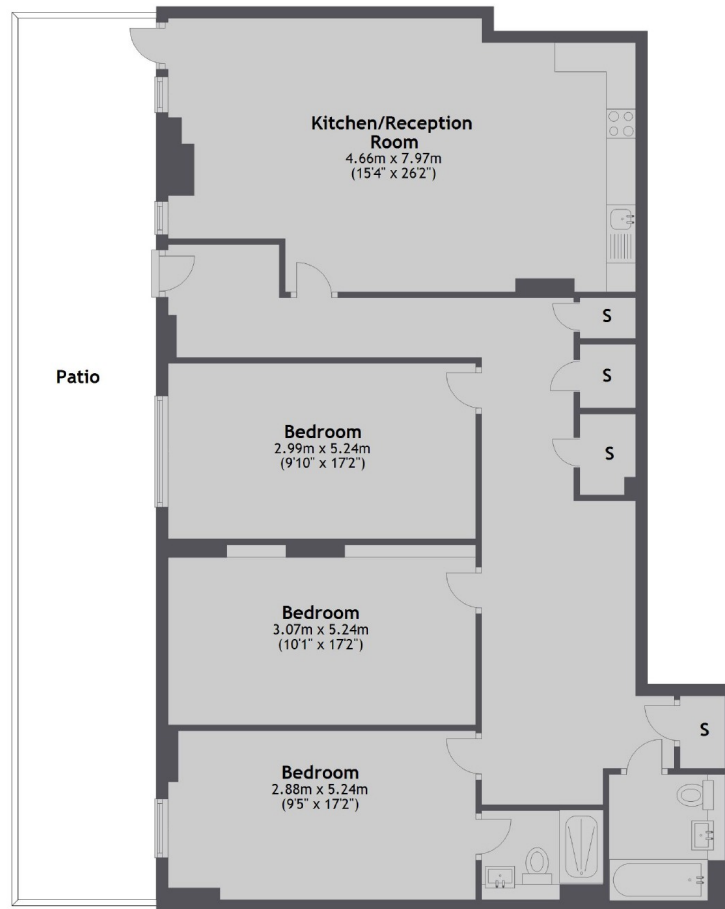

Total area: approx. 123.9 sq. metres (1333.4 sq. feet)