



## Millharbour, E14

£375,000

A large one bedroom apartment located in the Millharbour development. Features to include open plan reception room, private balcony, 24 hour concierge and allocated underground parking as well as fully air conditioned.

Millharbour is 0.8 miles from Canary Wharf and 0.2 miles from South Quay DLR Station which both provide good links to the City.

### Features

Guide Price £375,000-  
£400,000  
547.9 Sq.Ft  
Water Views  
Newly Refurbished  
Private Balcony  
24 Hour Concierge  
Allocated Underground  
Parking

Millharbour,  
London, E14

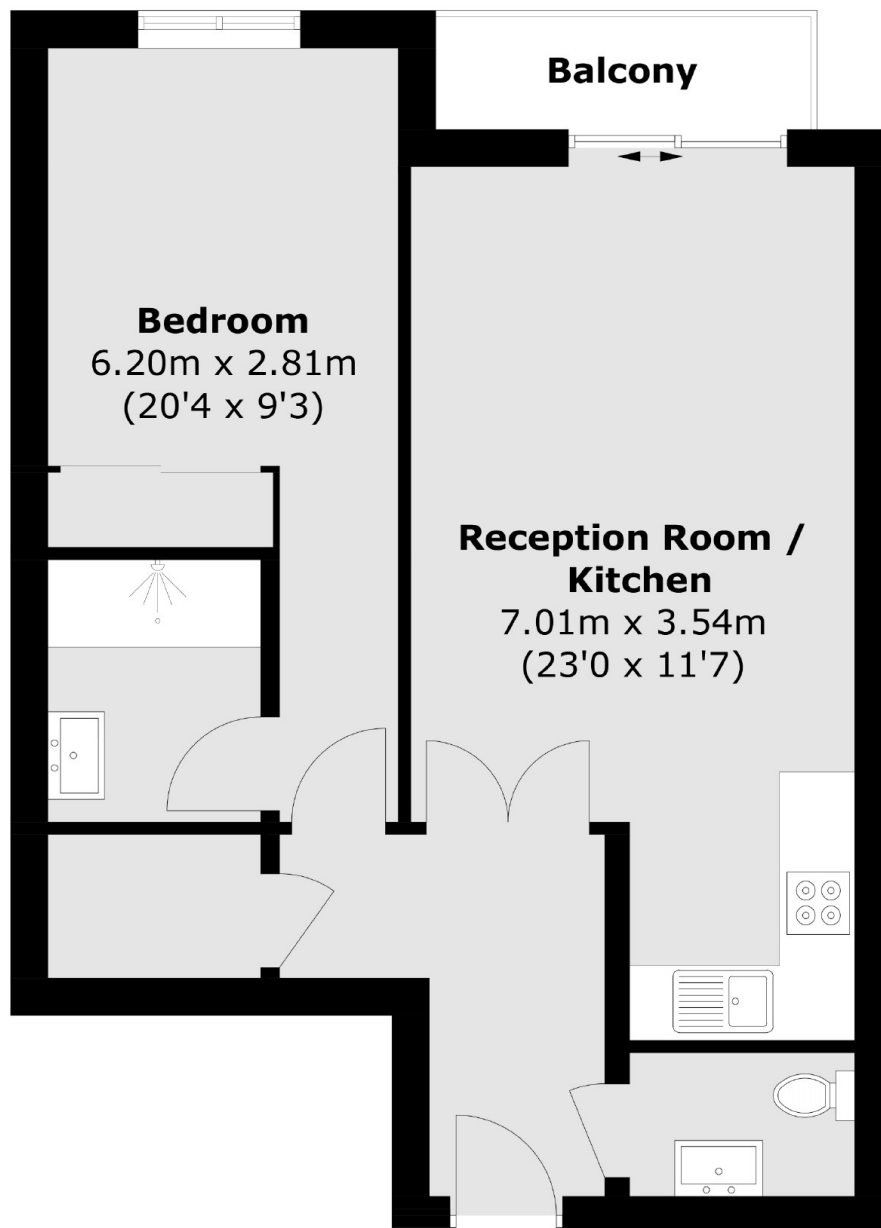

## Sixth Floor

Total area (approx.): 50.9 sq. m (547.9 sq. ft)  
Balcony: 2.7 sq. m (29.1 sq. ft)

**Dexters**

Canary Wharf  
39 Westferry Road  
London  
E14 8JH  
Sales  
020 7517 1199

Energy Rating: B. We aim to make our particulars both accurate and reliable. However they are not guaranteed; nor do they form part of an offer or contract. If you require clarification on any points then please contact us, especially if you're traveling some distance to view. Please note that appliances and heating systems have not been tested and therefore no warranties can be given as to their good working order.

 **RICS** | Regulated  
Estate Agent  
and Letting Agent

dexters.co.uk