

Cuba Street, E14

£425,000

A two bedroom, two bathroom home located on the sixth floor moments away from Canary Wharf. Features to include wooden flooring, open plan reception room, Juliette balcony, residents roof terrace and secure bike storage.

Block Wharf is less than 0.25 miles from Canary Wharf which provides access to a choice of transport links to include the DRL, Underground station and the Elizabeth line.

Features

- Sixth Floor
- Two Bedrooms
- Juliette Balcony
- Wooden Flooring
- Residents Roof terrace
- Canary Wharf Location

Cuba Street,
London, E14

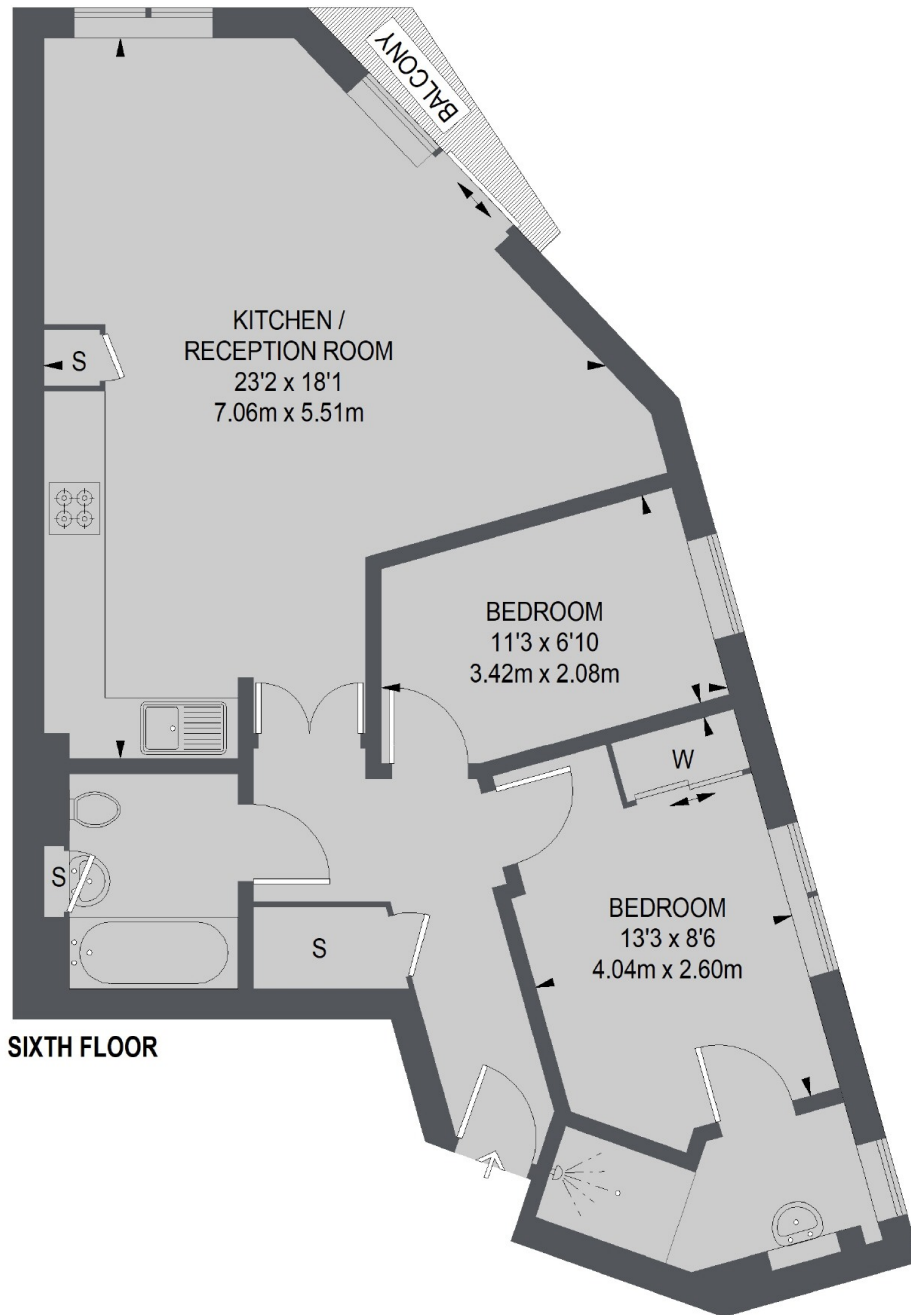

TOTAL APPROX. FLOOR AREA
678 SQ. FT. (63.00 SQ. M.)