



7 Gardeners Square

, Evesham, WR11 1DZ

**Offers over £150,000**



  
CHRISTIAN  
LEWIS  
—PROPERTY—



## 7 Gardeners Square

, Evesham, WR11 1DZ

A chain free two bedroom end of terrace home requiring some TLC.

Calling all first time buyers and investors, a great opportunity to purchase a period property, in need of modernisation. Situated in a peaceful spot the property would suit a first time buyer looking for a FREEHOLD purchase or an investor. Property comprises of; lounge/diner, kitchen and bathroom. Upstairs there are two bedrooms.

### Additional Information

Tenure: We understand that the property is for sale Freehold.

Local Authority: Wychavon District Council

Council Tax Band: We understand that the Council Tax Band for the property is Band B

EPC Rating: D

### Disclaimer

Whilst we make enquiries with the Seller to ensure the information provided is accurate, Christian Lewis makes no representations or warranties of any kind with respect to the statements contained in the particulars





which should not be relied upon as representations of fact. All representations contained in the particulars are based on details supplied by the Seller. Your Conveyancer is legally responsible for ensuring any purchase agreement fully protects your position. Please inform us if you become aware of any information being inaccurate.



Floor Plan

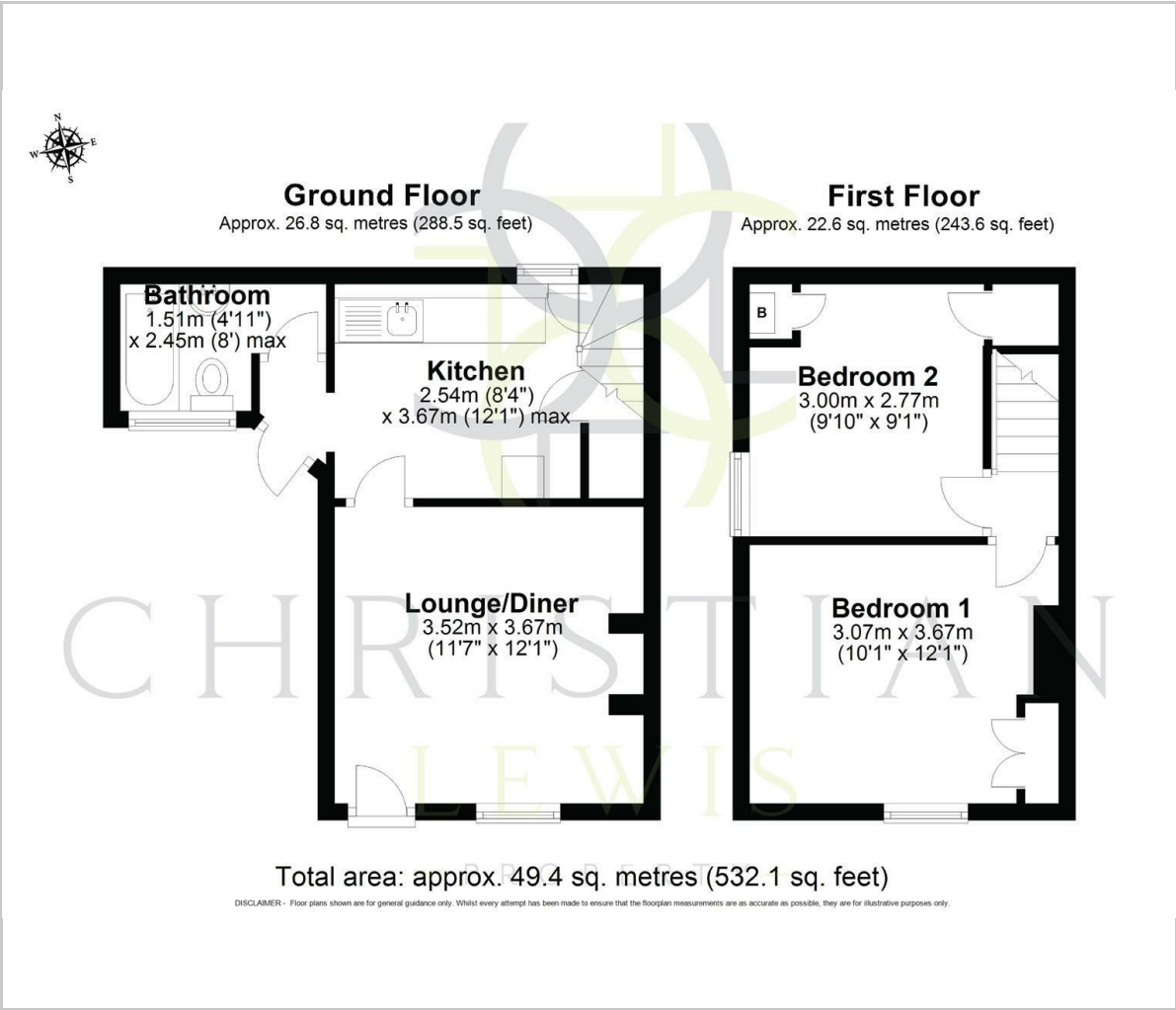

Viewing

Please contact our Evesham Office on 01386 442929 if you wish to arrange a viewing appointment for this property or require further information.

These particulars, whilst believed to be accurate are set out as a general outline only for guidance and do not constitute any part of an offer or contract. Intending purchasers should not rely on them as statements of representation of fact, but must satisfy themselves by inspection or otherwise as to their accuracy. No person in this firms employment has the authority to make or give any representation or warranty in respect of the property.

86 High Street, Evesham, Worcs, WR11 4EU  
Tel: 01386 442929 Email: christian@christianlewisproperty.co.uk www.christianlewisproperty.co.uk

Area Map

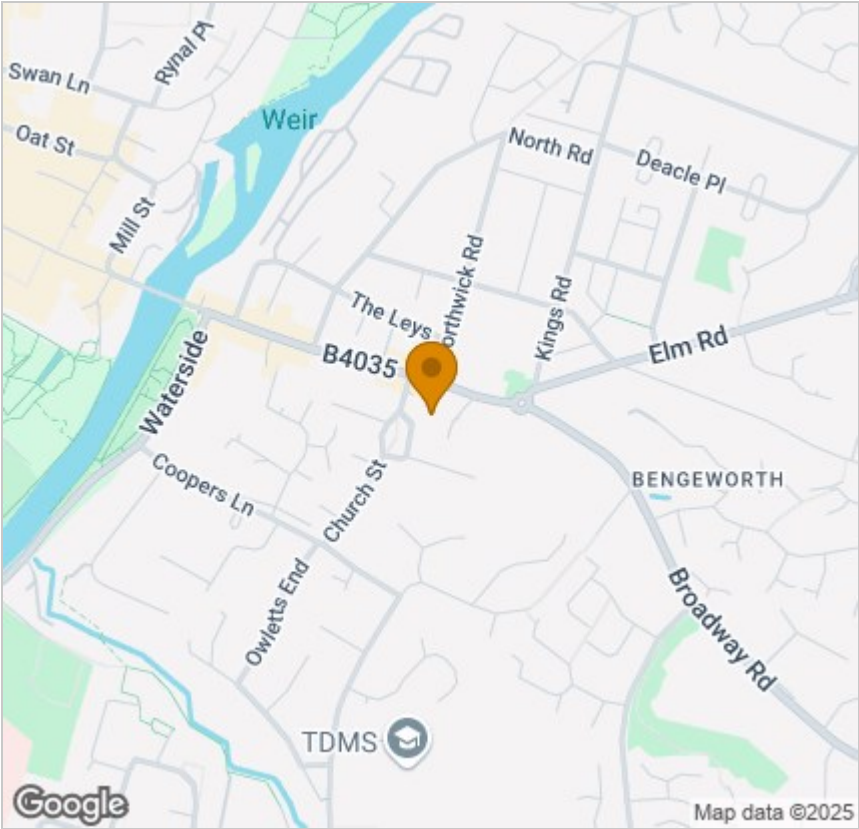

Energy Efficiency Graph

