



3 Poppy Close, Evesham, WR11 3GA

**£300,000**



**CHRISTIAN  
LEWIS**  
— PROPERTY —



## 3 Poppy Close, Evesham, WR11 3GA

£300,000

An immaculate town house situated in a wonderful position on the development.

Situated in a lovely location opposite the park and boasting views of the Cotswold escarpment this well-presented four-bedroom family home has spacious accommodation over three levels, off road parking, integrated garage and rear garden. The property is double glazed and gas centrally heated and was built in 2015 so still has the remainder of the NHBC.

The property has been lovingly owned and improved by the current owners and really does need to be seen to be appreciated. The property comprises of; hall, w/c, kitchen/diner and family room. The first floor benefits from living room, bathroom and bedroom. On the second floor there are three bedrooms, the master benefitting from an ensuite. Other benefits include driveway and ample parking, landscaped and well stocked rear garden and glorious views.

Additional Information

Tenure: We understand that the property is for sale  
Freehold.

Local Authority: Wychavon District Council

Council Tax Band: We understand that the Council Tax  
Band for the property is Band D

EPC Rating: C



## Floor Plans

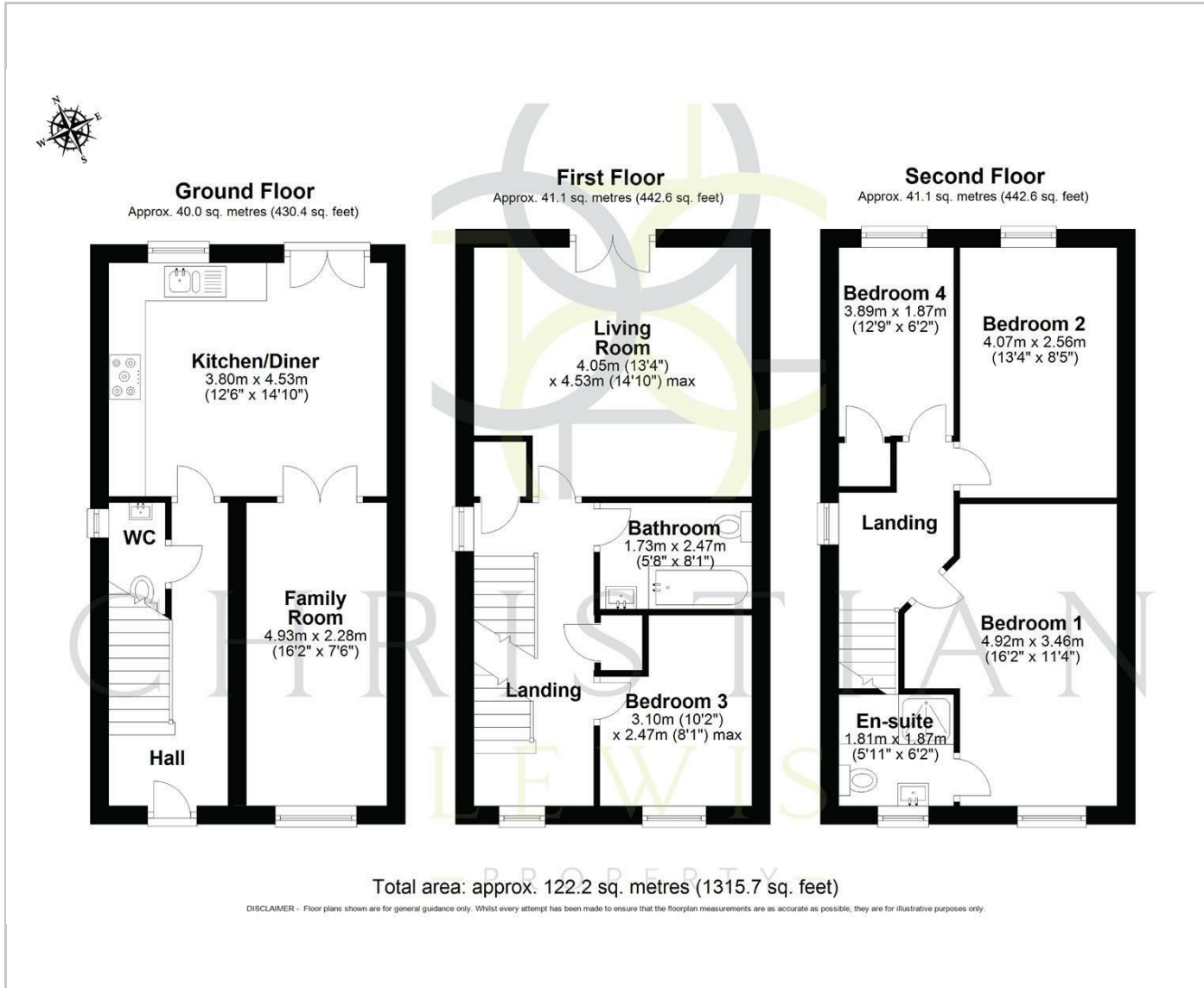

## Area Map

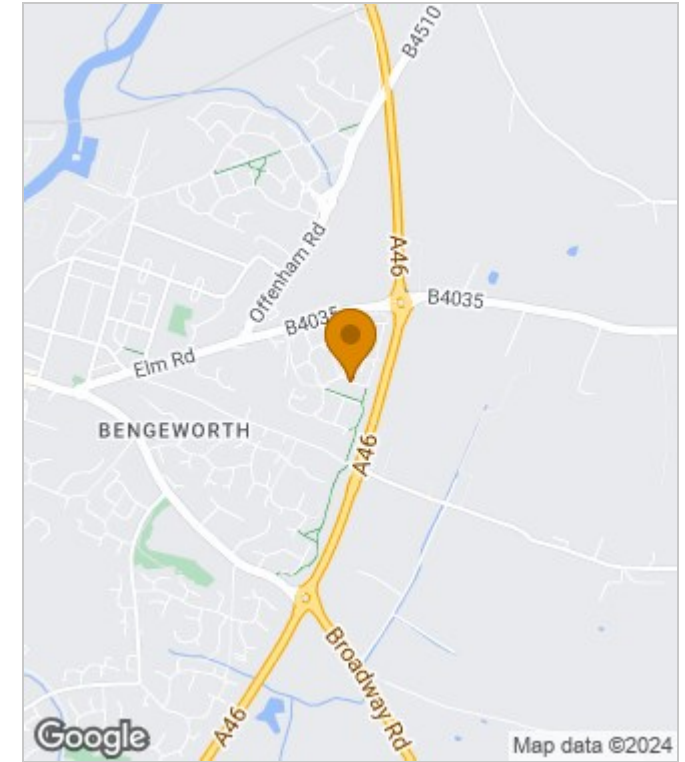

## Energy Performance Graph

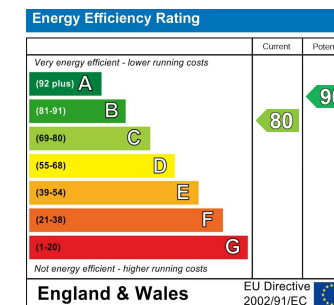

These particulars, whilst believed to be accurate are set out as a general outline only for guidance and do not constitute any part of an offer or contract. Intending purchasers should not rely on them as statements of representation of fact, but must satisfy themselves by inspection or otherwise as to their accuracy. No person in this firm's employment has the authority to make or give any representation or warranty in respect of the property.

86 High Street, Evesham, Worcs, WR11 4EU

Tel: 01386 442929 Email: christian@christianlewisproperty.co.uk www.christianlewisproperty.co.uk